

70 LB. DIGITAL SCALE

Model 95069

ASSEMBLY & OPERATING INSTRUCTIONS



Due to continuing improvement, actual product may differ slightly from the product described herein.



3491 Mission Oaks Blvd., Camarillo, CA 93011
Visit our Web Site at www.harborfreight.com

Copyright© 2006 by Harbor Freight Tools®. All rights reserved. No portion of this manual or any artwork contained herein may be reproduced in any shape or form without the express written consent of Harbor Freight Tools.

For technical questions and replacement parts please call 1-800-444-3353.

THANK YOU for choosing a **HARBOR FREIGHT TOOLS** product. For future reference, please complete the owner's record below:

Model _____ **Serial No.** _____ **Purchase Date** _____

SAVE THE RECEIPT, WARRANTY AND THESE INSTRUCTIONS. It is important that you read the entire manual to become familiar with the unit BEFORE you begin assembly.

Technical Specifications

Material:	Thermoplastic exterior shell and tray, black rubber foot-pegs
Dimensions:	11-1/8" L X 9-1/4" W X 2-1/2" H
Power Source:	Single 9-Volt battery (included)/AC Adaptor Class 2 Transformer; AC input: 120V/60Hz (included) Output: 9V 100 mA
Maximum Weight Capacity:	70 Lb./32Kg



READ ALL INSTRUCTIONS BEFORE USING THIS PRODUCT!

Safety Warnings and Precautions

WARNING: When using product, basic safety precautions should always be followed to reduce the risk of personal injury and damage to equipment.

Read all instructions before using this product!

GENERAL SAFETY RULES

WARNING!

READ AND UNDERSTAND ALL INSTRUCTIONS
Failure to follow all instructions listed below may result in
electric shock, fire, and/or serious injury.
SAVE THESE INSTRUCTIONS

WORK AREA

1. **Keep your work area clean and well lit.** Cluttered benches and dark areas invite accidents.
2. **Do not operate the Digital Scale in explosive atmospheres, such as in the presence of flammable liquids, gases, or dust.** Electrical products create sparks which may ignite the dust or fumes.

ELECTRICAL SAFETY

3. **Grounded products must be plugged into an outlet properly installed and grounded in accordance with all codes and ordinances. Never remove the grounding prong or modify the plug in any way. Do not use any adapter plugs. Check with a qualified electrician if you are in doubt as to whether the outlet is properly grounded.** If a grounded product should electrically malfunction or break down, grounding provides a low resistance path to carry electricity away from the user.
4. **Double insulated products are equipped with a polarized plug (one blade is wider than the other). This plug will fit in a polarized outlet only one way. If the plug does not fit fully in the outlet, reverse the plug. If it still does not fit, contact a qualified electrician to install a polarized outlet. Do not change the plug in any way.** Double insulation eliminates the need for the three wire grounded power cord and grounded power supply system.
5. **Avoid body contact with grounded surfaces such as pipes, radiators, ranges, and refrigerators.** There is an increased risk of electric shock if your body is grounded.
6. **Do not expose the Scale to rain or wet conditions.** Water entering the Scale will increase the risk of electric shock.
7. **Do not abuse the Power Cord. Never use the Power Cord to carry the Scale or to pull the Plug from an outlet. Keep the Power Cord away from heat, oil, sharp edges, or moving parts. Replace damaged Power Cords immediately.** Damaged Power Cords increase the risk of electric shock.
8. **When operating the Scale outside, use an outdoor extension cord marked "W-A" or "W".** These extension cords are rated for outdoor use, and reduce the risk of electric shock.

PERSONAL SAFETY

9. **Stay alert. Watch what you are doing, and use common sense when operating the Scale. Do not operate the Scale while tired or under the influence of drugs, alcohol, or medication.**
10. **Store the Scale out of reach of children and other untrained persons.** Electrical products are dangerous in the hands of untrained users.

USE AND CARE

11. **Do not use the Scale if the Power Switch does not turn it on or off.** Any appliance that cannot be controlled with the Power Switch is dangerous and must be replaced.
12. **Disconnect the Power Cord before making any adjustments, changing the battery, or storing the Scale.** Such preventive safety measures reduce the risk of turning on the product accidentally.

SERVICE

13. **Scale service must be performed only by qualified repair personnel.** Service or maintenance performed by unqualified personnel could result in a risk of injury.

14. **When servicing the Scale, use only identical replacement parts. Follow instructions in the “*Inspection, Maintenance, And Cleaning*” section of this manual.** Use of unauthorized parts or failure to follow maintenance instructions may create a risk of electric shock or injury.

GROUNDING

WARNING!

Improperly connecting the grounding wire can result in the risk of electric shock. Check with a qualified electrician if you are in doubt as to whether the outlet is properly grounded. Do not modify the power cord plug provided with the Scale. Never remove the grounding prong from the plug. Do not use the Scale if the power cord or plug is damaged. If damaged, have it repaired by a service facility before use. If the plug will not fit the outlet, have a proper outlet installed by a qualified electrician.

GROUNDED TOOLS: TOOLS WITH THREE PRONG PLUGS

1. Tools marked with “Grounding Required” have a three wire cord and three prong grounding plug. The plug must be connected to a properly grounded outlet. If the Scale should electrically malfunction or break down, grounding provides a low resistance path to carry electricity away from the user, reducing the risk of electric shock. **(See Figure A.)**
2. The grounding prong in the plug is connected through the green wire inside the cord to the grounding system in the tool. The green wire in the cord must be the only wire connected to the Scale’s grounding system and must never be attached to an electrically “live” terminal. **(See Figure A.)**
3. A grounded appliance must be plugged into an appropriate outlet, properly installed and grounded in accordance with all codes and ordinances. The plug and outlet should look like those in the following illustration. **(See Figure A.)**

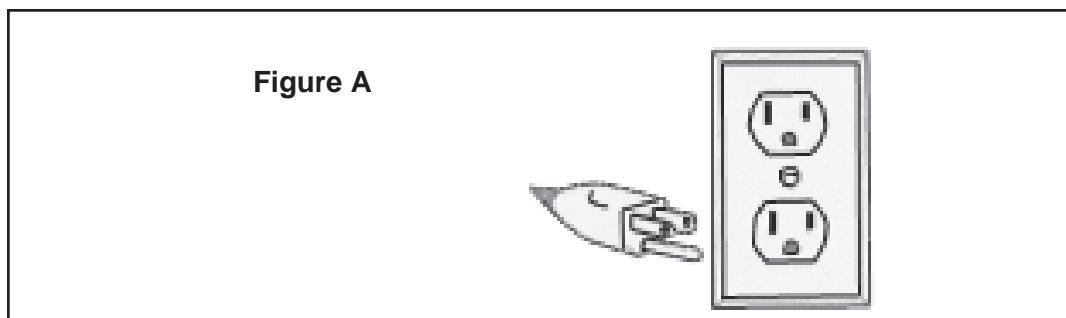

DOUBLE INSULATED APPLIANCES: APPLIANCES WITH TWO PRONG PLUGS

1. Appliances marked “Double Insulated” do not require grounding. They have a special double insulation system which satisfies OSHA requirements and complies with the applicable standards of Underwriters Laboratories, Inc., the Canadian Standard Association, and the National Electrical Code. **(See Figure B.)**

2. Double insulated tools may be used in either of the 120 volt outlets shown in the following illustration. **(See Figure B.)**

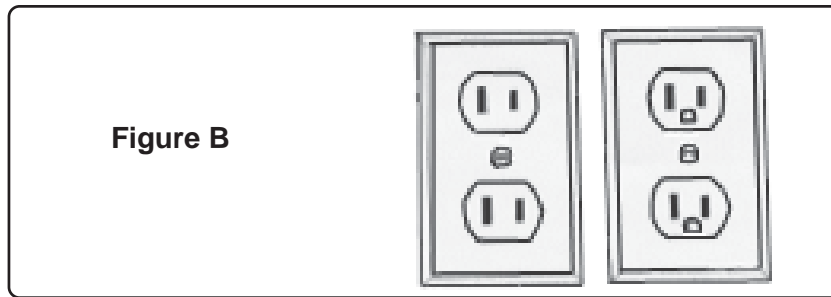

EXTENSION CORDS

1. **Grounded** appliances require a three wire extension cord. **Double Insulated** products can use either a two or three wire extension cord.
2. As the distance from the supply outlet increases, you must use a heavier gauge extension cord. Using extension cords with inadequately sized wire causes a serious drop in voltage, resulting in loss of power and possible tool damage. **(See Figure C, next page.)**
3. The smaller the gauge number of the wire, the greater the capacity of the cord. For example, a 14 gauge cord can carry a higher current than a 16 gauge cord. **(See Figure C.)**
4. When using more than one extension cord to make up the total length, make sure each cord contains at least the minimum wire size required. **(See Figure C.)**
5. If you are using one extension cord for more than one tool, add the nameplate amperes and use the sum to determine the required minimum cord size. **(See Figure C.)**
6. If you are using an extension cord outdoors, make sure it is marked with the suffix “W-A” (“W” in Canada) to indicate it is acceptable for outdoor use.
7. Make sure your extension cord is properly wired and in good electrical condition. Always replace a damaged extension cord or have it repaired by a qualified electrician before using it.
8. Protect your extension cords from sharp objects, excessive heat, and damp or wet areas.

Specific Safety Rules for the Digital Scale

1. **Supervise children while using the Scale.**
2. **Remove the battery if the Scale is not used for a long period of time.**
3. **Dispose of old batteries properly.** Make certain to follow all local laws and restrictions for proper disposal.
4. **Avoid serious eye injury.** Always wear ANSI approved safety goggles when working with tools and equipment.
5. **The Digital Scale is not United States Postal Service (USPS) approved.**

6. **Avoid exposing the Scale to extreme temperatures and electromagnetic disturbances.** Your scale should be operated at normal household room temperatures. Placing the Scale near devices such as radios and microwaves may affect the display value.
7. **Avoid setting the Scale on a surface which vibrates or is unstable.**
8. **Do not exceed the Scale's maximum weight capacity of 70 Lbs./32 Kg.** Overloading will affect the accuracy of the Scale and may cause permanent damage.

Note: Performance of this tool (if powered by line voltage) may vary depending on variations in local line voltage. Extension cord usage may also affect tool performance.



Warning: The warnings, cautions, and instructions discussed in this instruction manual cannot cover all possible conditions and situations that may occur. It must be understood by the operator that common sense and caution are factors which cannot be built into this product, but must be supplied by the operator.

Figure C

RECOMMENDED MINIMUM WIRE GAUGE FOR EXTENSION CORDS* (120 VOLT)					
NAMEPLATE AMPERES (At Full Load)	EXTENSION CORD LENGTH				
	25 Feet	50 Feet	75 Feet	100 Feet	150 Feet
0 – 2.0	18	18	18	18	16
2.1 – 3.4	18	18	18	16	14
3.5 – 5.0	18	18	16	14	12
5.1 – 7.0	18	16	14	12	12
7.1 – 12.0	1	14	12	10	-
12.1 – 16.0	14	12	10	-	-
16.1 – 20.0	12	10	-	-	-

* Based on limiting the line voltage drop to five volts at 150% of the rated amperes.

SYMBOLOLOGY

	Double Insulated
	Canadian Standards Association
	Underwriters Laboratories, Inc.
V ~	Volts Alternating Current
A	Amperes
n_o xxxx/min.	No Load Revolutions Per Minute (RPM)

Unpacking

When unpacking your 70 Lb. Digital Scale, check to make sure that all parts listed in the parts list on page 9 are included. If any parts are missing or broken, please call **HARBOR FREIGHT TOOLS** at **1-800-444-3353**. It is important that you read the entire manual to become familiar with the product BEFORE you operate and use the Digital Scale.

Assembly

Your Digital Scale comes completely assembled. Only maintenance such as battery replacement may be required.

Operation

This product can be powered by an adapter or used with a 9V battery as the power source.

Using the Adapter

1. Plug the Charger Plug (30) into the Jack (24) located on the Scale. Plug the Charger Plug into a 120V electrical outlet.
2. When done using the Scale, unplug the Charger Plug (30) from the Digital Scale. Unplug the Charger Plug from the electrical outlet.

Changing the Battery

1. Batteries must be replaced if a picture of a battery  is displayed in the LCD window. Gently push in on the tab on the Battery Cover (27) and pull the Battery Cover (27) up-see Figure 1.
2. Unplug the battery connector from the Battery (26). Replace the dead Battery (26) with a new 9V Battery. Snap the battery connection back onto the top of the Battery.

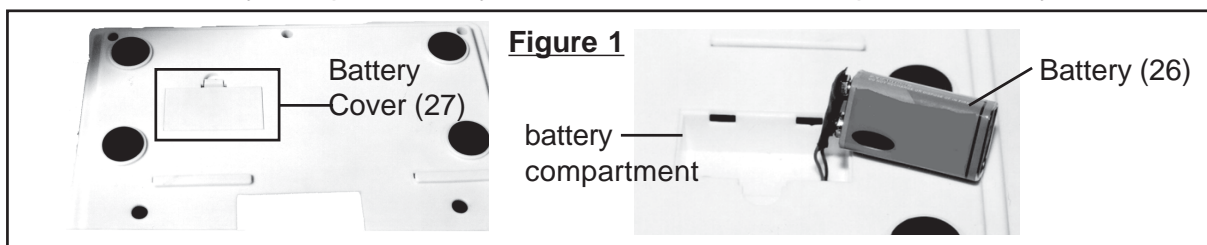

Using the Scale

1. Press the Mode Key (see Figure 2) to set the Scale to the desired unit of weight, pounds or Kilograms.
2. The Scale has a Backstop (1) located on top of the Scale. Lift the Backstop (1). Set the item to be weighed against the Backstop (1). Failure to lift the Backstop (1) may keep the Scale from operating properly.
3. Set the Scale on a level surface free from vibration and clear of electronic interference such as radios, phones and microwaves.
4. Press the On/Off Button to turn ON the Scale-see Figure 2.

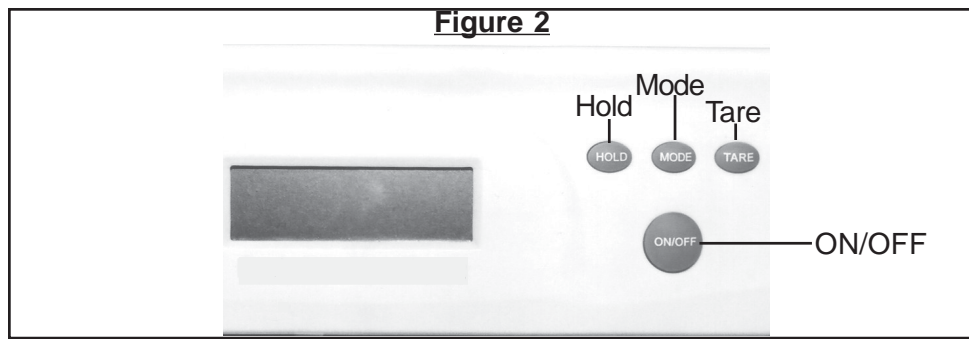

5. Wait until the LCD readout displays “0.0”.
6. Place the object on the weighing platform. Wait for the LCD readout to indicate the weight of the item.
7. The Hold Key is used to lock-in the readout for several seconds.

Weighing Tare

Tare is the deduction from the gross weight (container plus product) to allow for the weight of the container.

1. Press the ON/OFF Button. Place the Tare item (example: the container) onto the weighing platform.
2. Press the Tare Button and wait several seconds until “0” is displayed. Once the “0” is displayed, put the item that you want weighed (apart from the container) on the scale *along with the container which you already have on the Scale*.
3. Wait for the weight to be displayed. The weight shown will be for the item only.
4. After this operation a series of dotted lines may appear on the readout. Remove the items from the weighing platform and turn the Scale OFF. Turn the Scale back ON to continue weighing.

Inspection, Maintenance and Cleaning

1. Always unplug the Digital Scale from its electrical outlet before performing any inspection, maintenance, or cleaning.
2. Do not submerge the Digital Scale in liquid. Clean with a soft cloth as necessary.

Parts List

Part	Description	Quantity	Part	Description	Quantity
1	Backstop	1	16	Back Light	1
2	Plate	1	17	Key PCB	1
3	Ring	4	18	PCB	1
4	Up Support	1	19	Screw	4
5	Screw	2	20	Screw	4
6	Metal Pad	2	21	Down Support	1
7	Load Cell	1	22	Buzzer	1
8	Screw	2	23	Jack	1
9	Screw	10	24	Power Supply PCB	1
10	Cover	1	25	Base	1
11	Screw	6	26	Battery	1
12	LCD Window	1	27	Battery Cover	1
13	LCD	1	28	Screw	5
14	Flexible Block	1	29	Foot Washer	6
15	Key	1	30	Charger Plug	1

PLEASE READ THE FOLLOWING CAREFULLY

THE MANUFACTURER AND/OR DISTRIBUTOR HAS PROVIDED THE PARTS DIAGRAM IN THIS MANUAL AS A REFERENCE TOOL ONLY. NEITHER THE MANUFACTURER NOR DISTRIBUTOR MAKES ANY REPRESENTATION OR WARRANTY OF ANY KIND TO THE BUYER THAT HE OR SHE IS QUALIFIED TO MAKE ANY REPAIRS TO THE PRODUCT OR THAT HE OR SHE IS QUALIFIED TO REPLACE ANY PARTS OF THE PRODUCT. IN FACT, THE MANUFACTURER AND/OR DISTRIBUTOR EXPRESSLY STATES THAT ALL REPAIRS AND PARTS REPLACEMENTS SHOULD BE UNDERTAKEN BY CERTIFIED AND LICENSED TECHNICIANS AND NOT BY THE BUYER. THE BUYER ASSUMES ALL RISK AND LIABILITY ARISING OUT OF HIS OR HER REPAIRS TO THE ORIGINAL PRODUCT OR REPLACEMENT PARTS THERETO, OR ARISING OUT OF HIS OR HER INSTALLATION OF REPLACEMENT PARTS THERETO.

Note: Some parts are listed and shown for illustration purposes only and are not available individually as replacement parts.

Parts Diagram

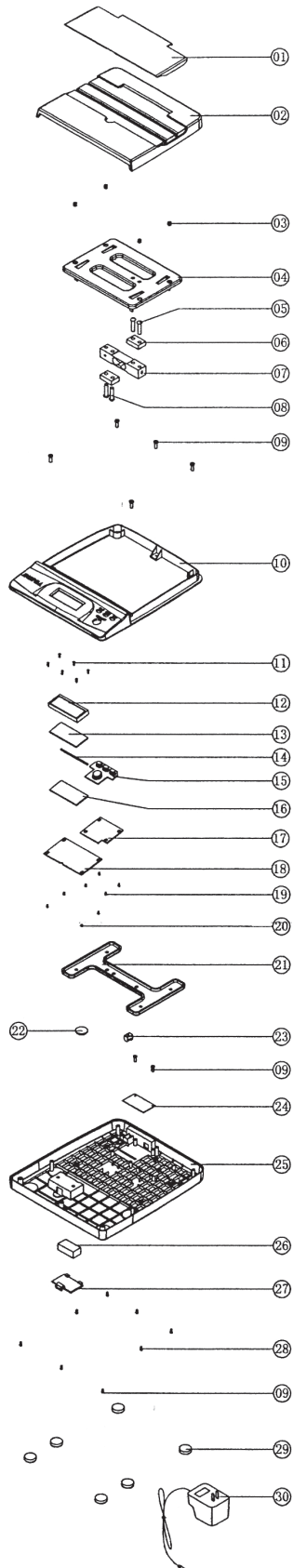

Free Manuals Download Website

<http://myh66.com>

<http://usermanuals.us>

<http://www.somanuals.com>

<http://www.4manuals.cc>

<http://www.manual-lib.com>

<http://www.404manual.com>

<http://www.luxmanual.com>

<http://aubethermostatmanual.com>

Golf course search by state

<http://golfingnear.com>

Email search by domain

<http://emailbydomain.com>

Auto manuals search

<http://auto.somanuals.com>

TV manuals search

<http://tv.somanuals.com>