

CENTRAL PNEUMATIC®

PROFESSIONAL

HVLP DETAIL SPRAY GUN

Model 46719

ASSEMBLY AND OPERATING INSTRUCTIONS



Distributed exclusively by Harbor Freight Tools®.

3491 Mission Oaks Blvd., Camarillo, CA 93011

Visit our website at: <http://www.harborfreight.com>



**Read this material before using this product.
Failure to do so can result in serious injury.
SAVE THIS MANUAL.**

Copyright© 2002 by Harbor Freight Tools®. All rights reserved. No portion of this manual or any artwork contained herein may be reproduced in any shape or form without the express written consent of Harbor Freight Tools. Diagrams within this manual may not be drawn proportionally. Due to continuing improvements, actual product may differ slightly from the product described herein. Tools required for assembly and service may not be included.

For technical questions or replacement parts, please call 1-800-444-3353.

Specifications

| | |
|------------------|---------------------------|
| Cup Capacity | 5.3 Ounces |
| Air Inlet | 1/4" NPS |
| Recommended PSI | 43 PSI |
| Dimensions | 12-3/4" x 6-1/8" x 3-7/8" |
| Nozzle Size | 0.161" |
| Weight | 1.15 Lbs. |
| Recommended Hose | 3/8" I.D. |

Save This Manual

You will need the manual for the safety warnings and precautions, assembly instructions, operating and maintenance procedures, parts list and diagram. Keep your invoice with this manual. Write the invoice number on the inside of the front cover. Keep the manual and invoice in a safe and dry place for future reference.

Safety Warnings and Precautions

WARNING: When using tool, basic safety precautions should always be followed to reduce the risk of personal injury and damage to equipment.

Read all instructions before using this tool!

1. **Keep work area clean.** Cluttered areas invite injuries.
2. **Observe work area conditions.** Do not use machines or power tools in damp or wet locations. Don't expose to rain. Keep work area well lighted. Do not use electrically powered tools in the presence of flammable gases or liquids.
3. **Keep children away.** Children must never be allowed in the work area. Do not let them handle machines, tools, or extension cords.
4. **Store idle equipment.** When not in use, tools must be stored in a dry location to inhibit rust. Always lock up tools and keep out of reach of children.
5. **Do not force tool.** It will do the job better and more safely at the rate for which it was intended. Do not use inappropriate attachments in an attempt to exceed the tool capacity.
6. **Use the right tool for the job.** Do not attempt to force a small tool or attachment to do the work of a larger industrial tool. There are certain applications for which this tool was designed. Do not modify this tool and do not use this tool for a purpose for which it was not intended.
7. **Dress properly.** Do not wear loose clothing or jewelry as they can be caught in moving parts. Protective, electrically non-conductive clothes and non-skid footwear are recommended when working. Wear restrictive hair covering to contain long hair.
8. **Use eye and ear protection.** Always wear ANSI approved impact safety goggles. Wear an ANSI approved dust respirator when spraying.

9. **Do not overreach.** Keep proper footing and balance at all times. Do not reach over or across running machines.
10. **Maintain tools with care.** Keep tools clean for better and safer performance. Follow instructions for lubricating and changing accessories. Inspect tool cords and hoses periodically and, if damaged, have them repaired by an authorized technician. The handles must be kept clean, dry, and free from oil and grease at all times.
11. **Disconnect power.** When not in use disconnect from compressor.
12. **Remove adjusting keys and wrenches.** Check that keys and adjusting wrenches are removed from the tool or machine work surface before plugging it in.
13. **Avoid unintentional starting.** Do not carry any tool with your finger on the trigger, whether it is plugged in or not.
14. **Stay alert.** Watch what you are doing, use common sense. Do not operate any tool when you are tired.
15. **Check for damaged parts.** Before using any tool, any part that appears damaged should be carefully checked to determine that it will operate properly and perform its intended function. Check for alignment and binding of moving parts; any broken parts or mounting fixtures; and any other condition that may affect proper operation. Any part that is damaged should be properly repaired or replaced by a qualified technician. Do not use the tool if any switch does not turn On and Off properly.
16. **Guard against electric shock.** Prevent body contact with grounded surfaces such as pipes, radiators, ranges, and refrigerator enclosures.
17. **Replacement parts and accessories.** When servicing, use only identical replacement parts. Use of any other parts will void the warranty.
18. **Do not operate tool if under the influence of alcohol or drugs.** Read warning labels on prescriptions to determine if your judgment or reflexes are impaired while taking drugs. If there is any doubt, do not operate the tool.
19. **Use proper size and type extension cord.** If an extension cord is required, it must be of the proper size and type to supply the correct current to the air compressor without heating up. Otherwise, the extension cord could melt and catch fire, or cause electrical damage to the air compressor. Check air compressor manual.
20. **Maintenance.** For your safety, maintenance should be performed regularly by a qualified technician.
21. **Keep aware of air hoses.** Be careful not to trip over air hoses while working. Check air connections periodically.
22. **Do not operate Spray Gun near open flames, pilot lights, heaters, or any other heat source.** Make sure you have adequate ventilation. Most solvents and paints are extremely flammable, especially when sprayed. Never smoke cigarettes in the same room you are working in.
23. **Read labels on cleaning solvents and paint coatings.** Chlorinated solvents such

as 111-Trichloroethane and Methylene Chloride (also known as methyl-chloride) can chemically react with aluminum and may explode. Many paint sprayers contain aluminum. Contact solvent manufacturer or paint supplier if your are in doubt.

24. **Paints and solvents may be harmful or fatal if swallowed or inhaled.** Always use a respirator when spraying. Avoid prolonged skin contact with solvents or paints as they will irritate skin. After contact, immediately wash off exposed area with hot, soapy water.
25. **Check all Spray Gun Seals and Air Connection.** Before use, make sure the **Lid (#14)** is fully tightened to the **Cup (#13)**. Make sure the air hose is securely fastened to the **Body (#3)**.

Note: Performance of the compressor (if powered by line voltage) may vary depending on variations in local line voltage. Extension cord usage may also affect tool performance.

Warning: The warnings, cautions, and instructions discussed in this instruction manual cannot cover all possible conditions and situations that may occur. It must be understood by the operator that common sense and caution are factors which cannot be built into this product, but must be supplied by the operator.

WARNING: This product contains or, when used, produces a chemical known to the State of California to cause cancer and birth defects or other reproductive harm. (California Health & Safety Code 25249.5, et seq.)

Unpacking

When unpacking, check to make sure the parts listed on page 8 are included. If any parts are missing or broken, please call Harbor Freight Tools at the number on the cover of this manual as soon as possible.

Assembly

Refer to Assembly Drawing on page 9.

1. To attach the **Cup (#13)**, screw it onto the **Material Sleeve (#10)**.
2. Screw the **Regulator (#30)** onto the **Air Connector (#28)**.

Operation

Warning! Never allow the Spray Gun and **Cup (#13)** to lay on it's side when the **Cup (#13)** is full of paint.

For best service, you should incorporate a shut-off valve, regulator with pressure gauge, and filter, as shown. All are available at Harbor Freight Tools.

Note: It is recommended that you test the Spray Gun on scrap material, to become familiar with the available adjustments, prior to use.

1. Remove the **Lid (#14)** on the **Cup (#13)** and add no more than 5.3 ounces of paint. Replace the **Lid (#14)**.
2. Connect the air hose to the **Regulator (#30)** and set the pressure to 43 PSI. Do not exceed 43 PSI.
3. Squeeze the **Trigger (#15)** to test the pattern.
4. Spray from a distance of approximately four to eight inches while keeping the Spray Gun perpendicular to the ground.
5. Maintain your distance as you evenly move from side to side. Do not fan or arc the Spray Gun or the paint will apply unevenly.
6. When you finish spraying, release the **Trigger (#15)**, and disconnect the air hose.
7. Empty the **Cup (#13)**. Never store the **Cup (#13)** with paint in it.

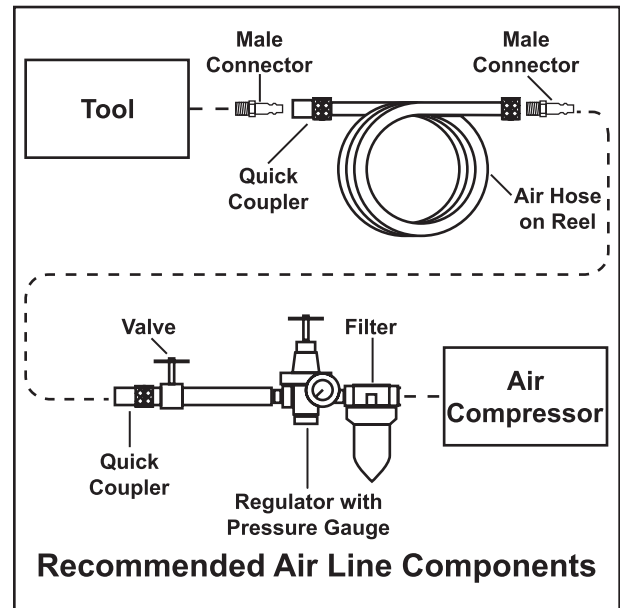

Warning! Even after the compressor is shut down, the **Cup (#13)** may still be pressurized. Open it slowly and carefully.

Adjustments

1. You can fine tune the air pressure by slowly turning the **Regulator (#30)** and the **Air Adjustment Screw Valve Assy. (#29)**. You may also adjust the pressure with the air compressor. Make sure you do not exceed the recommended 43 PSI.
2. You can adjust the amount of fluid coming through the gun with the **Fluid Control Knob (#19)**. Loosen the **Fluid Control Knob Lock (#20)**, make the adjustment, and tighten the **Fluid Control Knob Lock (#20)**.

Warning! Keep your hand away from the **Trigger (#15)** while adjusting jet shape..

3. To adjust the spray pattern, turn the **Air Cap (#1)**.

TroubleShooting

Problem 1: Heavy top/bottom, or right/left pattern.

Cause: Material buildup on **Air Cap (#1)**.

Partially plugged **Air Cap (#1)** center holes.

Solution: Remove **Air Cap (#1)**, soak in solvent, and wipe clean.

Cause: Material partially plugging Tip of Gun.

Solution: Remove Tip and clean.

Cause: Damaged **Paint Needle (#22)**.

Solution: Have a qualified technician replace the **Paint Needle (#22)** .

Problem 2: Heavy Center Pattern

Cause: Too much paint.

Solution: Reduce fluid flow with the **Fluid Control Knob (#19)**.

Loosen the the **Fluid Control Knob Lock (#20)**, make the adjustment and tighten the **Fluid Control Knob Lock (#20)**.

Cause: Coating too thick.

Solution: Thin out coating.

Problem 3: Split spray pattern.

Cause: Pressure too high.

Solution: Reduce air pressure at the regulator.

Cause: Not enough paint.

Solution: Increase fluid flow with the **Fluid Control Knob (#19)**.

Loosen the the **Fluid Control Knob Lock (#20)**, make the adjustment, and tighten the **Fluid Control Knob Lock (#20)**..

Problem 4: Jerky or fluttering spray.

Cause: Insufficient paint.

Solution: Fill **Cup (#13)**.

Cause: Gun and **Cup (#13)** tipped at excessive angle.

Solution: Correct angle.

Problem 5: Air mixes with paint.

Cause: Worn **O-ring (#2)**.

Solution: Have a qualified technician replace the **O-ring (#2)**.

Maintenance

Cleaning (Gun should be attached to compressor to complete the cleaning process)

Warning!! Do not use paint strippers on this unit as they will damage the aluminum. Never allow the unit to lay on it's side while paint is in the **Cup (#13)**.

1. Empty paint from **Cup (#13)** and add small amount of clean solvent. Replace **Lid (#14)** and shake **Cup (#13)** vigorously. At the lowest possible pressure, spray out the solvent into a waste bucket (make sure you are wearing respirator and eye protection).
2. Empty **Cup (#13)** of remaining solvent and repeat the process until the **Cup (#13)** solvent appears clean and free of the paint.
3. Disconnect air supply. Remove surplus solvent and wipe the **Cup (#13)** clean with a lint free cloth.

Note: The **Cup (#13)** may be fully immersed in solvent for no more than 24 hours if needed.

4. Remove the **Air Cap (#1)** and the **Fluid Nozzle (#4)**. Remove the **Gasket (#5)** and unscrew the **Packing Screw (#6)**, and remove it. Use the **Brush (#12)** to clean the **Paint Needle (#22)** with solvent. When replacing the **Packing Screw (#6)**, do not over-tighten. Over-tightening of the **Packing Screw (#6)** will result in leakage. Unscrew the **Fluid Control Knob Lock (#20)** and remove the **Fluid Control Knob (#19)**. Use the **Brush (#12)** to clean the gun body opening that the **Fluid Control Knob (#19)** fits in, and clean all of the parts. Reassemble gently. Do not force any parts or they will break.

Note: Always dispose of paints and solvents properly. Consult the local hazardous waste authority for proper disposal procedures and sites.

Parts List

| Part No. | Description |
|----------|------------------------------|
| 1* | Air Nozzle with Brass Cap |
| 2* | O-ring |
| 3 | Body |
| 4* | Fluid Nozzle |
| 5* | Gasket |
| 6 | Packing Screw |
| 7* | Tallon Seal |
| 8* | Spring |
| 9 | Connector |
| 10* | Material Sleeve |
| 11 | Wrench |
| 12 | Brush |
| 13 | Cup |
| 14 | Lid |
| 15 | Trigger |
| 16 | O-ring |
| 17 | Screw |
| 18 | Trigger Pin |
| 19 | Fluid Control Knob |
| 20 | Fluid Control Knob Lock |
| 21 | Paint Needle Spring |
| 22* | Paint Needle |
| 23* | Washer |
| 24 | Air Valve Assembly |
| 25 | Screw |
| 26 | Control Knob |
| 27 | Spray Regulating Nut Assy. |
| 28 | Air Connector (1/4 NPS) |
| 29 | Air Adjusting Valve Assembly |
| 30 | Regulator |
| 31 | Gasket |
| 32 | Gasket |
| 33 | Gasket |

*Not available individually as replacement parts
(see Repair Kit and Nozzle Set below)

97080S-RK Repair Kit (Includes #5,7,8,2,23,10)
97080S-NA 1.0MM Nozzle Set (Includes #1,4,22)

NOTE: Some parts are listed and shown for illustration purposes only and are not available individually as replacement parts.

Assembly Drawing

Part Notes: 1. Part # 24 is a set including 24a, 24b, 24c, 24d, 24e. Parts 24a through 24e are not listed on the parts list on page 8.

2. Part # 27 is a set including 27a, 27b, 27c, 27d. Parts 27a through 27d are not listed on the parts list on page 8.

3. Part # 29 is a set including 29a, 29b, 29c, 29d. Parts 29a through 29d are not listed on the parts list on page 8.

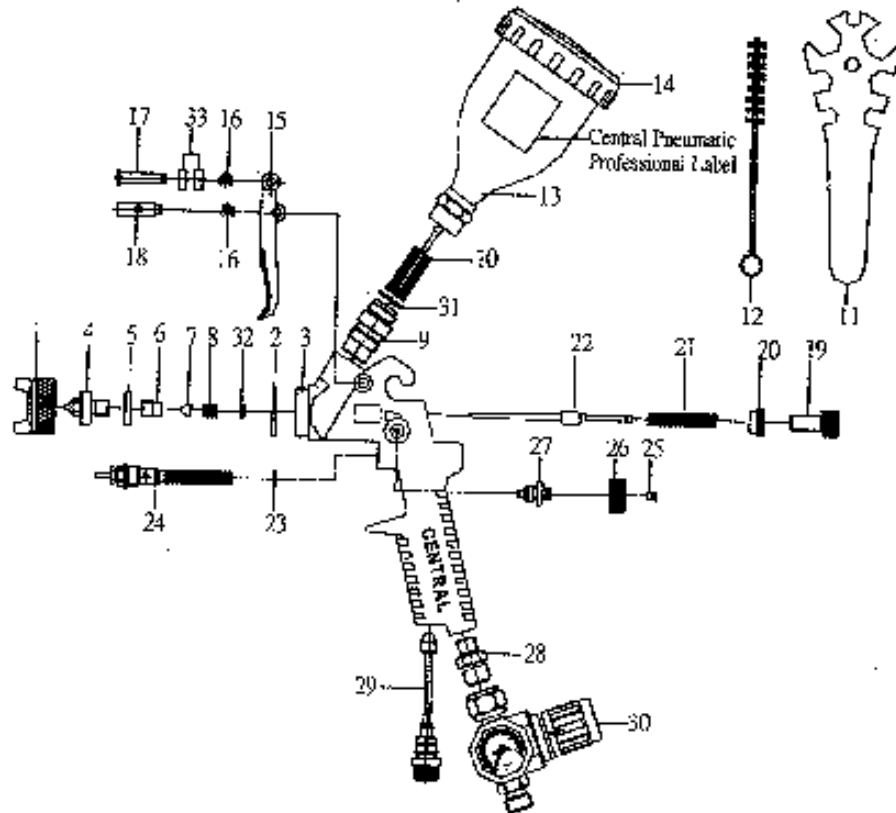

PLEASE READ THE FOLLOWING CAREFULLY

THE MANUFACTURER AND/OR DISTRIBUTOR HAS PROVIDED THE PARTS DIAGRAM IN THIS MANUAL AS A REFERENCE TOOL ONLY. NEITHER THE MANUFACTURER NOR DISTRIBUTOR MAKES ANY REPRESENTATION OR WARRANTY OF ANY KIND TO THE BUYER THAT HE OR SHE IS QUALIFIED TO MAKE ANY REPAIRS TO THE PRODUCT OR THAT HE OR SHE IS QUALIFIED TO REPLACE ANY PARTS OF THE PRODUCT. IN FACT, THE MANUFACTURER AND/OR DISTRIBUTOR EXPRESSLY STATES THAT ALL REPAIRS AND PARTS REPLACEMENTS SHOULD BE UNDERTAKEN BY CERTIFIED AND LICENSED TECHNICIANS AND NOT BY THE BUYER. THE BUYER ASSUMES ALL RISK AND LIABILITY ARISING OUT OF HIS OR HER REPAIRS TO THE ORIGINAL PRODUCT OR REPLACEMENT PARTS THERETO, OR ARISING OUT OF HIS OR HER INSTALLATION OF REPLACEMENT PARTS THERETO.

LIMITED 1 YEAR WARRANTY

Harbor Freight Tools Co. makes every effort to assure that its products meet high quality and durability standards, and warrants to the original purchaser that this product is free from defects in materials and workmanship for the period of one year from the date of purchase (90 days if used by a professional contractor or if used as rental equipment). This warranty does not apply to damage due directly or indirectly, to misuse, abuse, negligence or accidents, repairs or alterations outside our facilities, normal wear and tear, or to lack of maintenance. We shall in no event be liable for death, injuries to persons or property, or for incidental, contingent, special or consequential damages arising from the use of our product. Some states do not allow the exclusion or limitation of incidental or consequential damages, so the above limitation of exclusion may not apply to you. THIS WARRANTY IS EXPRESSLY IN LIEU OF ALL OTHER WARRANTIES, EXPRESS OR IMPLIED, INCLUDING THE WARRANTIES OF MERCHANTABILITY AND FITNESS.

To take advantage of this warranty, the product or part must be returned to us with transportation charges prepaid. Proof of purchase date and an explanation of the complaint must accompany the merchandise. If our inspection verifies the defect, we will either repair or replace the product at our election or we may elect to refund the purchase price if we cannot readily and quickly provide you with a replacement. We will return repaired products at our expense, but if we determine there is no defect, or that the defect resulted from causes not within the scope of our warranty, then you must bear the cost of returning the product.

This warranty gives you specific legal rights and you may also have other rights which vary from state to state.

3491 Mission Oaks Blvd. • PO Box 6009 • Camarillo, CA 93011 • (800) 444-3353

Free Manuals Download Website

<http://myh66.com>

<http://usermanuals.us>

<http://www.somanuals.com>

<http://www.4manuals.cc>

<http://www.manual-lib.com>

<http://www.404manual.com>

<http://www.luxmanual.com>

<http://aubethermostatmanual.com>

Golf course search by state

<http://golfingnear.com>

Email search by domain

<http://emailbydomain.com>

Auto manuals search

<http://auto.somanuals.com>

TV manuals search

<http://tv.somanuals.com>