

Model 65939

CHICAGO ELECTRIC® welding systems

INSTRUCTIONS AND PRECAUTIONS



WELDING CART

Distributed exclusively by Harbor Freight Tools®.

3491 Mission Oaks Blvd., Camarillo, CA 93011

Visit our website at: <http://www.harborfreight.com>



SAVE THESE INSTRUCTIONS. READ ALL PRECAUTIONS AND INSTRUCTIONS.

Copyright© 2008 by Harbor Freight Tools®. All rights reserved. No portion of this document or any artwork contained herein may be reproduced in any shape or form without the express written consent of Harbor Freight Tools. Diagrams within this document may not be drawn proportionally. Due to continuing improvements, actual product may differ slightly from the product described herein. Tools required for assembly and service may not be included.

For technical questions or replacement parts, please call 1-800-444-3353.

UNPACKING

When unpacking, make sure that the item is intact and undamaged. If any parts are missing or broken, please call Harbor Freight Tools at the number shown on the cover of this document as soon as possible.

IMPORTANT SAFETY INFORMATION

Assembly Precautions

1. Assemble only according to these instructions. Improper assembly can create hazards.
2. Wear ANSI-approved safety goggles and heavy-duty work gloves during assembly.

3. Keep assembly area clean and well lit.
4. Keep bystanders out of the area during assembly.
5. Do not assemble when tired or when under the influence of drugs or medication.

Use Precautions

1. Avoid working alone. If an accident occurs, an assistant can get help.
2. This product is not a toy. Do not allow children to play with or near this item.
3. Use for intended purpose(s) only.
4. Always store acetylene and oxygen tanks away from flammable materials and heat sources.
5. Inspect before use; check welds for cracks.
6. Wear the proper face mask and gloves for welding purposes.
7. Make sure tanks are securely strapped to the cart.
8. Store and use this cart only on flat and level surfaces.
9. After welding, make sure gas valves are securely tightened.
10. Read and understand the warnings and instructions provided by the manufacturer of the welding equipment being used.
11. Maintenance should be performed by a qualified technician.
12. Maintain product labels and nameplates. These carry important safety information. If unreadable or missing, contact Harbor Freight Tools for a replacement.

ASSEMBLY INSTRUCTIONS



Read the ENTIRE IMPORTANT SAFETY INFORMATION section at the beginning of this document including all text under subheadings therein before set up or use of this product.

Assembly

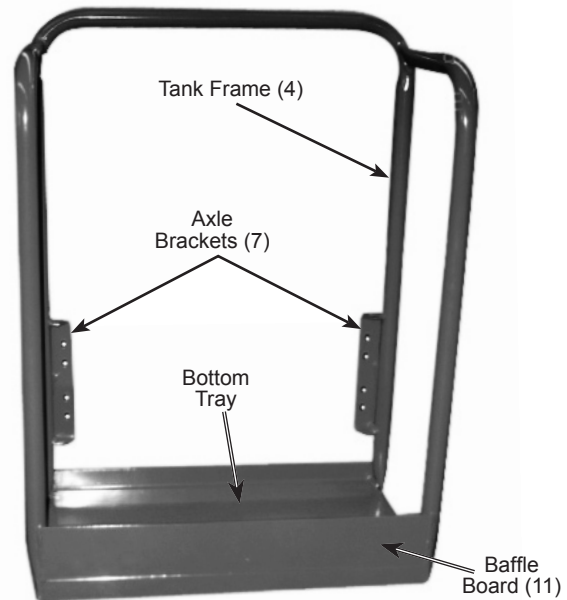

Fig. 1

1. Start with the welded Tank Frame (4) as this is where everything else attaches.

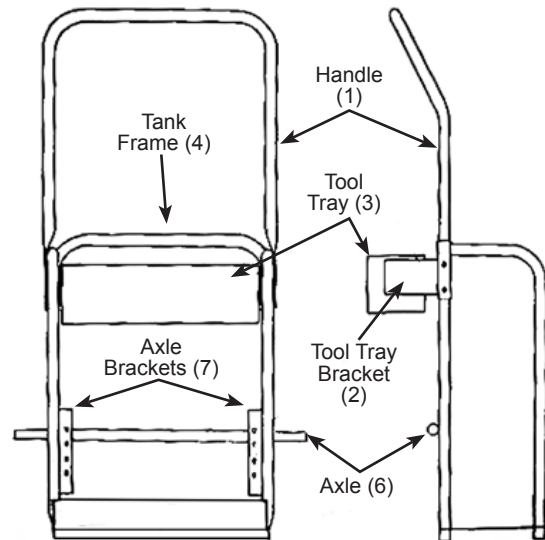

Fig. 2

2. Line up the holes of the Handle (1) and the Tool Tray Bracket with the holes at the upper sides of the Tank Frame (4).
3. Fit two Screws (9) through the holes in the Handle (from the outside in), Tank Frame side, and the Tool Tray Brackets on the inside of the Tank Frame, and screw on two Washers and Nuts.

4. Repeat for the other side.
 - a. When attaching the second Tool Tray Bracket, slide the Tool Tray (3) onto the metal pegs on the Brackets. These Brackets hold the Tool Tray in place.
 - b. The Tool Tray should be able to swing freely as the cart is tilted.
5. Slide the Wheels (5) onto the Axle ends and secure in place with washers and split keys.
6. The Axle (6) is attached to the back-bottom of the Tank Frame with two U-Bolts and four washers and nuts onto the Axle Bracket (7).
 - a. There are two mounting height available:
 - Upper mounting position - The Wheels should be slightly off the ground when the Cart is standing straight up.
 - Lower mounting position - The wheels are always on the ground supporting the cart.
7. Go over all screws and nuts making sure they are tightly fastened and secure.

MAINTENANCE

1. Periodically check welds for cracks and for loose parts or damage.
2. Check wheel tightness and tire pressure.
3. Lubricate wheels if they begin to bind or squeak.
4. Keep dry and free of rust.

STORAGE AND SAFETY PRECAUTIONS

1. Store tanks away from heat and ignition sources.
2. Consult gas supplier on safest way to transport and store gases.
3. Cart is designed for a maximum of 48" tanks.
4. Store and use on flat, level, hard surface.
5. When done welding, check that all gas valves are closed tightly.

Record Serial Number Here: _____

Note: If product has no serial number, record month and year of purchase instead.

Note: Some parts are listed and shown for illustration purposes only, and are not available individually as replacement parts.

PLEASE READ THE FOLLOWING CAREFULLY

THE MANUFACTURER AND/OR DISTRIBUTOR HAS PROVIDED THE PARTS LIST AND ASSEMBLY DIAGRAM IN THIS DOCUMENT AS A REFERENCE TOOL ONLY. NEITHER THE MANUFACTURER OR DISTRIBUTOR MAKES ANY REPRESENTATION OR WARRANTY OF ANY KIND TO THE BUYER THAT HE OR SHE IS QUALIFIED TO MAKE ANY REPAIRS TO THE PRODUCT, OR THAT HE OR SHE IS QUALIFIED TO REPLACE ANY PARTS OF THE PRODUCT. IN FACT, THE MANUFACTURER AND/OR DISTRIBUTOR EXPRESSLY STATES THAT ALL REPAIRS AND PARTS REPLACEMENTS SHOULD BE UNDERTAKEN BY CERTIFIED AND LICENSED TECHNICIANS, AND NOT BY THE BUYER. THE BUYER ASSUMES ALL RISK AND LIABILITY ARISING OUT OF HIS OR HER REPAIRS TO THE ORIGINAL PRODUCT OR REPLACEMENT PARTS THERETO, OR ARISING OUT OF HIS OR HER INSTALLATION OF REPLACEMENT PARTS THERETO.

PARTS LIST & ASSEMBLY DIAGRAM

Part	Description	Qty.
1.	Handle	1
2.	Tool Tray Bracket	2
3.	Tool Tray	1
4.	Tank Frame	1
5.	Wheels (40 PSI)	2
6.	Axle	1
7.	Axle Bracket	2
8.	U-Bolt	2
9.	Screws (2" x 3/16")	4
10.	Hex Screw	2
11.	Baffle Board	1

Free Manuals Download Website

<http://myh66.com>

<http://usermanuals.us>

<http://www.somanuals.com>

<http://www.4manuals.cc>

<http://www.manual-lib.com>

<http://www.404manual.com>

<http://www.luxmanual.com>

<http://aubethermostatmanual.com>

Golf course search by state

<http://golfingnear.com>

Email search by domain

<http://emailbydomain.com>

Auto manuals search

<http://auto.somanuals.com>

TV manuals search

<http://tv.somanuals.com>