

200 LB. Capacity Wood Cart

Model 44599

ASSEMBLY AND OPERATING INSTRUCTIONS

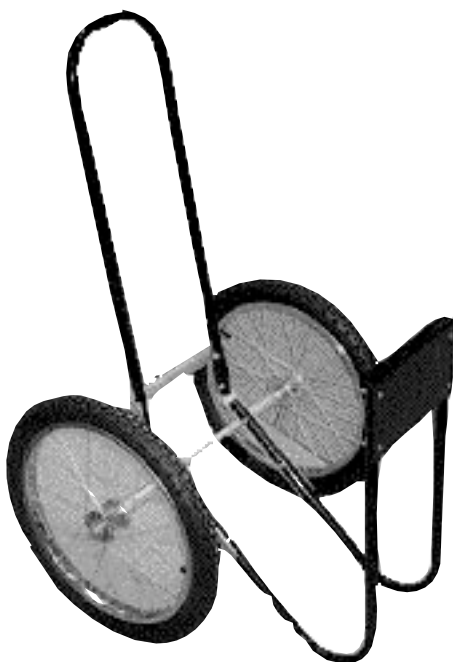

3491 Mission Oaks Blvd., Camarillo, CA 93011
Visit our Web site at <http://www.harborfreight.com>

Copyright © 2000 by Harbor Freight Tools®. All rights reserved. No portion of this manual or any artwork contained herein may be reproduced in any shape or form without the express written consent of Harbor Freight Tools.

For technical questions and replacement parts, please call 1-800-444-3353

Specifications

ITEM	DESCRIPTION
Overall Dimensions (Assembled)	44"H, 30"L, 27-1/2"W at wheels, 11"W at rack frame
Net Weight	30 lbs.
Wheels	Pneumatic Tires with Tube
Tire Size	2.125" x 20"
Tire Pressure	40 psi
Wheel Attachment	Cotter Pin and Washer
Maximum Capacity	200 lbs.

Save This Manual

You will need the manual for the safety warnings and precautions, assembly instructions, operating and maintenance procedures, parts list and diagram. Keep your invoice with this manual. Write the invoice number on the inside of the front cover. Keep the manual and invoice in a safe and dry place for future reference.

Safety Warnings and Precautions

WARNING: When using this product, basic safety precautions should always be followed to reduce the risk of personal injury and damage to equipment.

Read all instructions before using this product!

1. **Keep work area clean.** Cluttered areas invite injuries.
2. **Observe work area conditions.** Do not use machines or power tools in damp or wet locations. Don't expose to rain. Keep work area well lighted. Do not use electrically powered tools in the presence of flammable gases or liquids.
3. **Keep children away.** Children should not be allowed to play in or around the product.
4. **Do not force product.** It will do the job better and more safely at the rate for which it was intended. Do not use inappropriate attachments in an attempt to exceed the product's capacity.
5. **Use the right product for the right job.** Do not attempt to force this product to do the work of a larger industrial tool. There are certain applications for which this product was designed. Do not modify this product and do not use this product for a purpose for which it was not intended.
6. **Dress properly.** Do not wear loose clothing or jewelry as they can be caught in moving parts. Protective, electrically non-conductive clothes and non-skid footwear are recommended when working. Wear restrictive hair covering to contain long hair.
7. **Use eye protection.** Always wear ANSI approved impact safety goggles when assembling this product.
8. **Maintain product with care.** Inspect the product periodically and, if damaged, have an authorized technician perform repairs.

9. **Stay alert.** Watch what you are doing, use common sense. Do not operate any product when you are tired.
10. **Check for damaged parts.** Before using any product, any part that appears damaged should be carefully checked to determine that it will operate properly and perform its intended function. Check for alignment and binding of moving parts; any broken parts or mounting fixtures; and any other condition that may affect proper operation. Any part that is damaged should be properly repaired or replaced by a qualified technician.
11. **Do not operate product if under the influence of alcohol or drugs.** Read warning labels on prescriptions to determine if your judgment or reflexes are impaired while taking drugs. If there is any doubt, do not operate the product.

Warning: The warnings, cautions, and instructions discussed in this instruction manual cannot cover all possible conditions and situations that may occur. It must be understood by the operator that common sense and caution are factors which cannot be built into this product, but must be supplied by the operator.

Unpacking

When unpacking, check to make sure all parts shown on page 4 are included. If any parts are missing or broken, please call Harbor Freight Tools at the number on the cover of this manual.

Assembly Instructions

NOTE: All parts below refer to the parts listed on page 4 of this manual.

1. As shown in the diagram on page 5, position the U-Handle [1] inside the grooves of the Axle & Frame [4]. Attach the U-Handle to the Axle & Frame using two Bolts [10] on each side of the U-Handle. Add Washer (14) and secure the Bolts with Nuts [13] provided.
2. Position the Left Frame [7] inside the left groove of the Axle & Frame, opposite the end with the U-Handle attached. Secure the Left Frame using two Nuts and Bolts as shown in the diagram. Repeat for the Right Frame [8].
3. Attach the Bracket [9] to the Left and Right Frame pieces using the remaining Nuts and Bolts. Be sure that the folded edge of the Bracket points in toward the U-Handle.
4. To attach the Wheels [3], slide one of the Bushing [5] pieces over the Axle [11], followed by one of the Wheels. Secure the Wheel using a Washer [2] and Cotter Pin [6]. Repeat for the other Wheel.
5. Insert Caps [12] into the open ends of the tubing in the U-Handle, and the Left and Right Frame pieces.

Operation

Use your woodcart to carry heavy loads of firewood or other objects without having to make multiple trips. Place objects in holding area between the handle and the bracket. As always, be careful when lifting heavy objects, and do not attempt to carry objects weighing more than 200 lbs. with this product.

Parts List

No.	Description	Qty.
1.	U-Handle	1
2.	Washer \varnothing 20	2
3.	Wheel Kit	2
4.	Axle & Frame	1
5.	Bushing	2
6.	Cotter Pin	2
7.	Left Frame	1
8.	Right Frame	1
9.	Bracket	1
10.	Bolt M6 x 35	12
11.	Axle	1
12.	Cap	4
13.	Nut M6	12
14.	Flat Washer 6M	12

PLEASE READ THE FOLLOWING CAREFULLY

THE MANUFACTURER AND/OR DISTRIBUTOR HAS PROVIDED THE PARTS DIAGRAM IN THIS MANUAL AS A REFERENCE TOOL ONLY. NEITHER THE MANUFACTURER NOR DISTRIBUTOR MAKES ANY REPRESENTATION OR WARRANTY OF ANY KIND TO THE BUYER THAT HE OR SHE IS QUALIFIED TO MAKE ANY REPAIRS TO THE PRODUCT OR THAT HE OR SHE IS QUALIFIED TO REPLACE ANY PARTS OF THE PRODUCT. IN FACT, THE MANUFACTURER AND/OR DISTRIBUTOR EXPRESSLY STATES THAT ALL REPAIRS AND PARTS REPLACEMENTS SHOULD BE UNDERTAKEN BY CERTIFIED AND LICENSED TECHNICIANS AND NOT BY THE BUYER. THE BUYER ASSUMES ALL RISK AND LIABILITY ARISING OUT OF HIS OR HER REPAIRS TO THE ORIGINAL PRODUCT OR REPLACEMENT PARTS THERETO, OR ARISING OUT OF HIS OR HER INSTALLATION OF REPLACEMENT PARTS THERETO.

Assembly Drawing

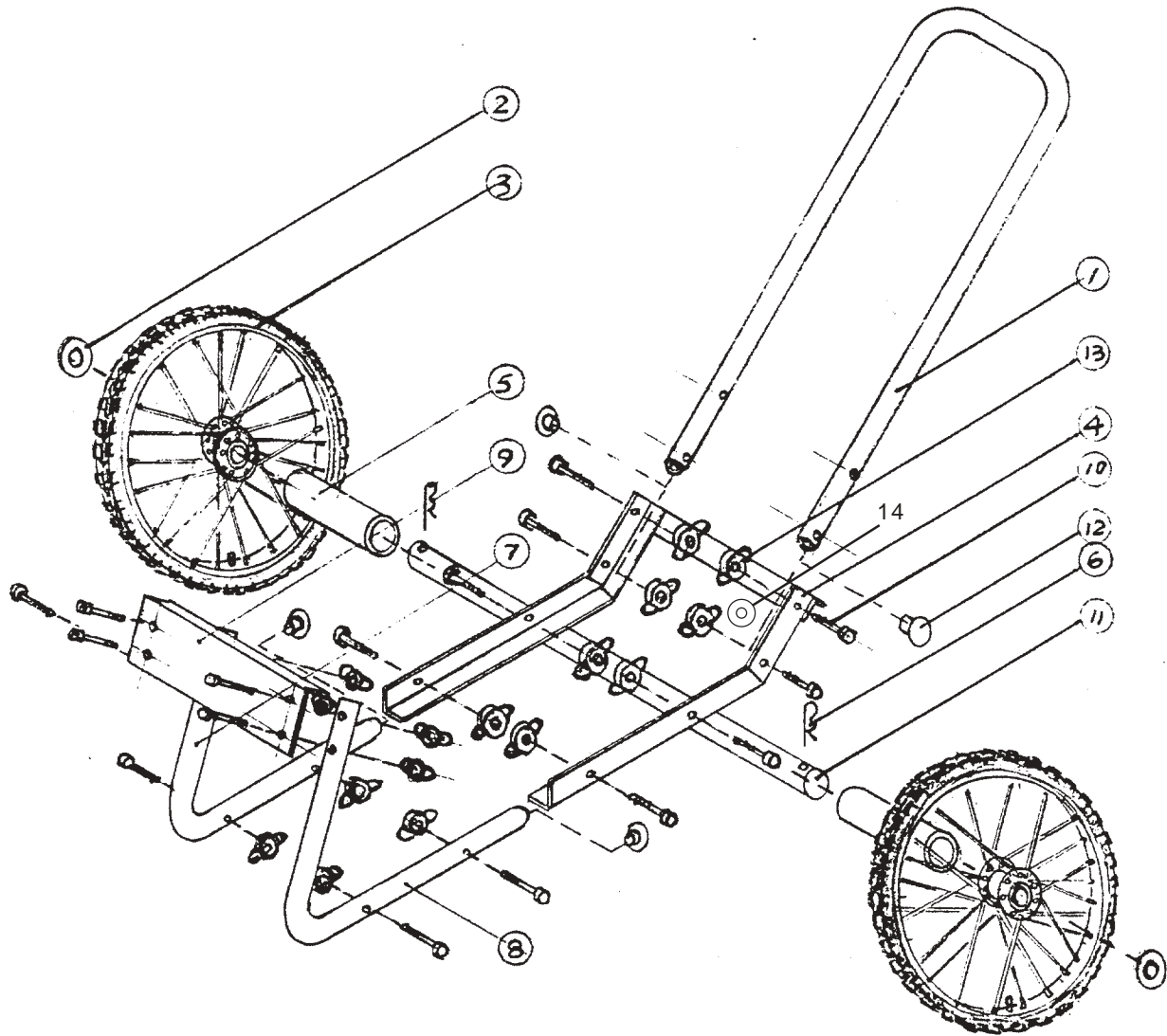

NOTE: Some parts are listed and shown for illustration purposes only and are not available individually as replacement parts.

Free Manuals Download Website

<http://myh66.com>

<http://usermanuals.us>

<http://www.somanuals.com>

<http://www.4manuals.cc>

<http://www.manual-lib.com>

<http://www.404manual.com>

<http://www.luxmanual.com>

<http://aubethermostatmanual.com>

Golf course search by state

<http://golfingnear.com>

Email search by domain

<http://emailbydomain.com>

Auto manuals search

<http://auto.somanuals.com>

TV manuals search

<http://tv.somanuals.com>