

SIT/STAND ROLLING WALKER

Model 66838

INSTRUCTIONS AND PRECAUTIONS



Distributed exclusively by Harbor Freight Tools®.
3491 Mission Oaks Blvd., Camarillo, CA 93011
Visit our website at: <http://www.harborfreight.com>



**SAVE THESE INSTRUCTIONS.
READ ALL PRECAUTIONS
AND INSTRUCTIONS.**

Copyright© 2009 by Harbor Freight Tools®. All rights reserved. No portion of this document or any artwork contained herein may be reproduced in any shape or form without the express written consent of Harbor Freight Tools. Diagrams within this document may not be drawn proportionally. Due to continuing improvements, actual product may differ slightly from the product described herein. Tools required for assembly and service may not be included.

**For technical questions or replacement parts, please
call 1-800-444-3353**

SPECIFICATIONS

Weight Capacity	225 lb.
Handle Height Adjustment	6 Positions

UNPACKING

When unpacking, make sure item is intact and undamaged. If parts are missing or broken, call Harbor Freight Tools at 1-800-444-3353.

IMPORTANT SAFETY INFORMATION

1. Assemble according to these instructions. Improper assembly can create hazards.
2. **WARNING!** This product should only be used by a person who has the physical capability to safely walk and sit on this device.
3. Do not exceed 225 lb. weight capacity. **Be aware of dynamic loading!** Sudden load movement may briefly create excess load causing product failure
4. **Use as intended only; Walker is not a wheel chair.** Do not use to carry people.
5. Wear ANSI-approved safety goggles and heavy-duty work gloves during assembly.
6. Make sure Walker is fully opened, Seat is down and folding bar beneath Seat is locked before use.
7. Make sure Handles are of equal height before use. If one is lower than the other, adjust accordingly. Apply gentle pressure to Handles to test Walker stability before use.
8. Test Brakes before use. If Wheels turn while Brakes are locked, have an authorized technician adjust Brakes. **DO NOT** use Walker if Brakes do not work properly.
9. Lock Brakes before sitting on Seat. Do not sit on Seat unless you on even, level ground.
10. Inspect before every use; do not use if parts are loose or damaged. Check tires regularly and replace when worn.
11. This product is not a toy. Do not allow children to play with or near this item.
12. Maintain product labels and nameplates. These carry important safety information.

If unreadable or missing, contact Harbor Freight Tools for a replacement.

ASSEMBLY INSTRUCTIONS



Read the **ENTIRE IMPORTANT SAFETY INFORMATION** section at the beginning of this document including all text under subheadings therein before set up or use of this product.

1. Open Rolling Walker. Push down on Support Hinges (41) until they lock securely in place. The Support Hinges are located directly below the Seat (16). See **Figure 1**, below.



Figure 1

2. The Brake Cable (7) should already be fastened to the Push Handles (2). Place the Push Handles into the Front Frame (17) and set to the required height using the Screw Caps (13) and Screws (10). Fasten securely. **WARNING!** Make sure that both Push Handles are set at the same height.
3. Insert the removable Backrest Bar (52) into the slots on the Front Frame and fasten into place by inserting the Retainer Pins (14). See **Figure 2**, below.

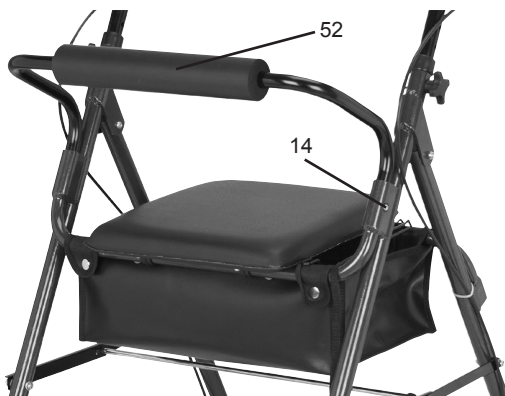

Figure 2

4. Use the Fasteners (26) to clasp the Basket (25) or PVC Bag (51) to the Cross Bolt (27) and the Back Frame (18).

OPERATION

1. To properly sit in the chair, first make sure the Walker is on a level surface.
2. Then check the brakes and grab both Handles (4).
3. Carefully back into the Walker. Do NOT fall back into the Walker.
4. To slow down or temporarily stop the Walker during use, squeeze the Brake Handles (6) firmly. See **Figure 3**, below.

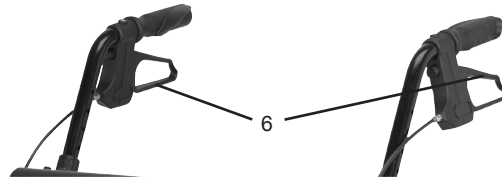

Figure 3

5. To lock the Wheels (38) in position, push down on Brake Handles until a “click” sound is heard.
6. To unlock the Wheels, pull upon the Brake Handles.
7. **Regularly** test the tension on the Brake Handles to ensure that Brakes work properly. It may be necessary to adjust the tension of the brake cable. This type of adjustment is similar to the kind performed on a bicycle.
8. To tighten the tension on the brake cable, use a wrench (not included) to turn the 10mm Nut under the Handle clockwise. See **Figure 4**, below.

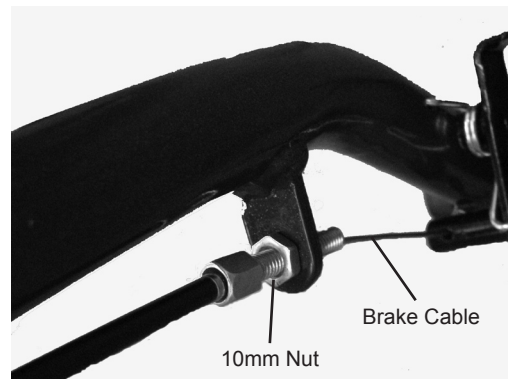

Figure 4

9. To loosen the brake cable, turn the Nut counterclockwise.
10. There may be a secondary brake cable tension adjustment that will have to be made as well. Use a 2mm Hex Key (not included) to loosen the set screw near then end of the brake cable just above the Wheel. See **Figure 5**, below.

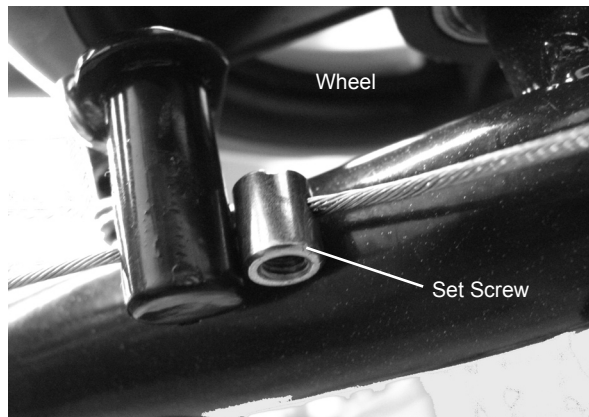

Figure 5

11. Please note: You will need to hold the brake cable in tension by holding the cable end with pliers. Then, while the brake cable is in tension, loosen the set screw.
12. Once the set screw is loosened, slide the cable clamp toward the brake lever. Then retighten the set screw.
13. **WARNING!** If the brakes continue to loosen after making these adjustment, contact an authorized service technician to make repairs.
14. **Do NOT use Rolling Walker if Brakes do not function properly. Using the Rolling Walker while brakes are not functioning properly can lead to brake failure and possible personal injury and property damage.**

CLEANING AND STORING

1. Clean Walker use a soft, damp cloth.
2. Remove Basket or Bag and fold Walker. To fold, pull on tie cord wrapped around Support Axle (42).
3. Store folded Walker in dry, secure area.

Record Serial Number Here: _____

Note: If product has no serial number, record month and year of purchase instead.

Note: Some parts are listed and shown for illustration purposes only, and are not available individually as replacement parts.

PLEASE READ THE FOLLOWING CAREFULLY

THE MANUFACTURER AND/OR DISTRIBUTOR HAS PROVIDED THE PARTS LIST AND ASSEMBLY DIAGRAM IN THIS DOCUMENT AS A REFERENCE TOOL ONLY. NEITHER THE MANUFACTURER OR DISTRIBUTOR MAKES ANY REPRESENTATION OR WARRANTY OF ANY KIND TO THE BUYER THAT HE OR SHE IS QUALIFIED TO MAKE ANY REPAIRS TO THE PRODUCT, OR THAT HE OR SHE IS QUALIFIED TO REPLACE ANY PARTS OF THE PRODUCT. IN FACT, THE MANUFACTURER AND/OR DISTRIBUTOR EXPRESSLY STATES THAT ALL REPAIRS AND PARTS REPLACEMENTS SHOULD BE UNDERTAKEN BY CERTIFIED AND LICENSED TECHNICIANS, AND NOT BY THE BUYER. THE BUYER ASSUMES ALL RISK AND LIABILITY ARISING OUT OF HIS OR HER REPAIRS TO THE ORIGINAL PRODUCT OR REPLACEMENT PARTS THERETO, OR ARISING OUT OF HIS OR HER INSTALLATION OF REPLACEMENT PARTS THERETO.

PARTS LIST & ASSEMBLY DIAGRAM

Part	Description	Qty
1	Dowel	2
2	Push handle	2
3	Cotton cube for backrest	1
4	Handle	2
5	Steel break adjustment	2
6	Brake handle	2 sets
7	Brake cable	2
8	M5 Locknut	4
9	M5*25 Round screw	4
10	M6*35 Screw	2
11	Pipe cover	2
12	Steel control brake	2
13	Star-shape screw cap	2
14	Retainer Pins	2
15	Spring	2
16	Seat	1
17	Front frame	1
18	Back frame	1
19	Pipe stopper	2
20	M6 Locknut	6
21	Screw	2
22	Washer	14
23	Rivet	2
24	Rope	1
25	Basket	1
26	Fastener	2
27	Round cross bolt	4

Part	Description	Qty
28	Brake loop pothook	2
29	Turning axles	2
30	Front fork cover	2
31	Front fork	2
32	Bearing	4
33	Locknut	2
34	Knot	4
35	Round turning axles	2
36	Bearing	8
37	Locknut	4
38	Wheel	4
39	Screw	4
40	Washer	4
41	Support Hinges	2
42	Support axle	1
43	Support	2
44	Locknut	2
45	Washer	6
46	Axles	2
47	Washer	6
48	Screw	2
49	Brake framework piece	2
50	Spring	2
51	Port Stopper	2
52	PVC Bag	1
53	Backrest Bar	1

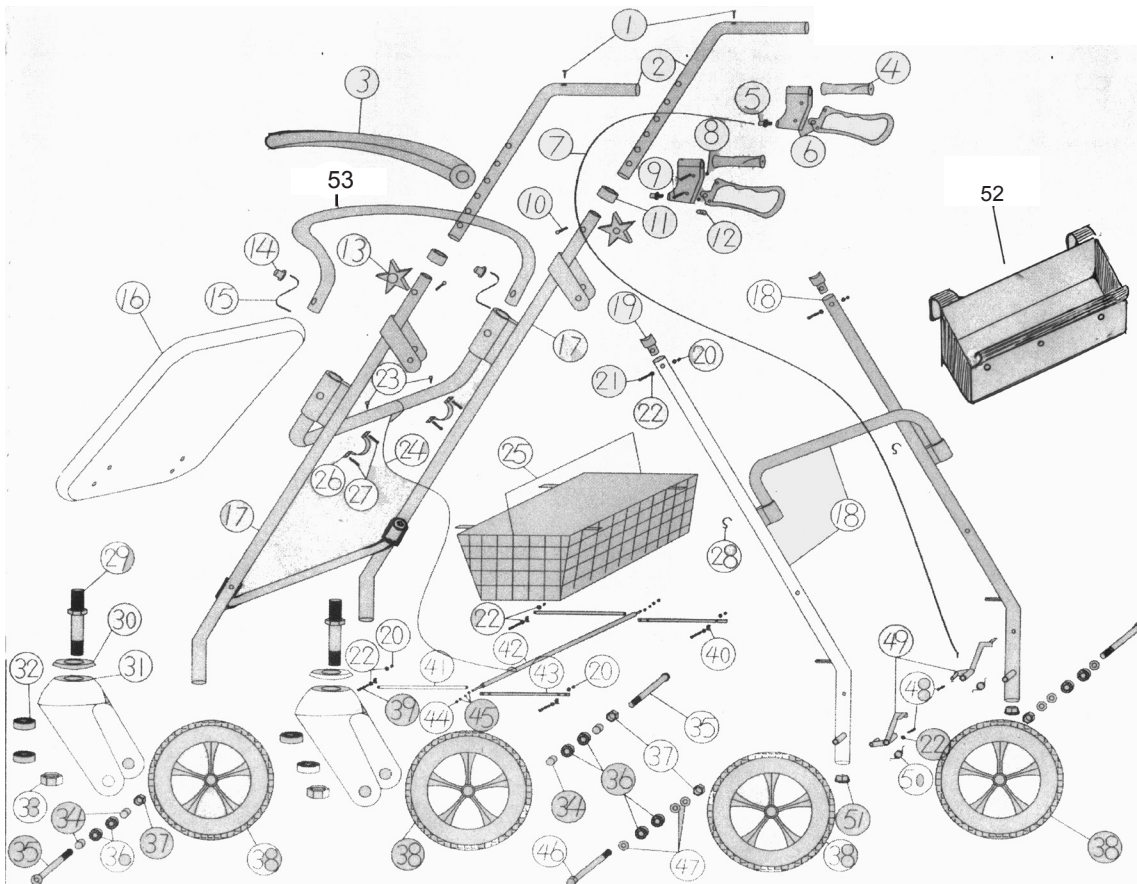

Free Manuals Download Website

<http://myh66.com>

<http://usermanuals.us>

<http://www.somanuals.com>

<http://www.4manuals.cc>

<http://www.manual-lib.com>

<http://www.404manual.com>

<http://www.luxmanual.com>

<http://aubethermostatmanual.com>

Golf course search by state

<http://golfingnear.com>

Email search by domain

<http://emailbydomain.com>

Auto manuals search

<http://auto.somanuals.com>

TV manuals search

<http://tv.somanuals.com>