



HUNTING SHELTER

Model 96529

ASSEMBLY INSTRUCTIONS



Diagrams within this manual may not be drawn proportionally.
Due to continuing improvements, actual product may differ slightly from the product described herein.

Distributed exclusively by Harbor Freight Tools®.

3491 Mission Oaks Blvd., Camarillo, CA 93011

Visit our website at: <http://www.harborfreight.com>



**Read this material before using this product.
Failure to do so can result in serious injury.
SAVE THIS MANUAL.**

Copyright© 2007 by Harbor Freight Tools®. All rights reserved. No portion of this manual or any artwork contained herein may be reproduced in any shape or form without the express written consent of Harbor Freight Tools.

For technical questions or replacement parts, please call 1-800-444-3353.

SAVE THIS MANUAL

Keep this manual for the safety warnings and precautions, assembly, operating, inspection, maintenance and cleaning procedures. Write the product's serial number in the back of the manual near the assembly diagram (or month and year of purchase if product has no number). Keep this manual and the receipt in a safe and dry place for future reference.

IMPORTANT SAFETY INSTRUCTIONS

In this manual, on the labeling, and all other information provided with this product:



This is the safety alert symbol. It is used to alert you to potential personal injury hazards. Obey all safety messages that follow this symbol to avoid possible injury or death.

DANGER

DANGER indicates a hazardous situation which, if not avoided, will result in death or serious injury.

WARNING

WARNING indicates a hazardous situation which, if not avoided, could result in death or serious injury.

CAUTION

CAUTION, used with the safety alert symbol, indicates a hazardous situation which, if not avoided, could result in minor or moderate injury.



NOTICE

NOTICE is used to address practices not related to personal injury.

CAUTION

CAUTION, without the safety alert symbol, is used to address practices not related to personal injury.

GENERAL SAFETY RULES

1. Dress Properly. Do not wear loose clothing or jewelry. They can be caught in moving parts.
2.  Wear ANSI-approved safety goggles when assembling this product.
3. Only use on a sturdy tree capable of supporting the weight of the Shelter.
4.  Fire hazard! This product IS NOT flame retardant. Do not smoke near or introduce flames near this product.
5. This product cannot support the weight of people or any objects. Do not sit or stand on this product. Do not place any objects on this product.
6. Do not use in windy conditions.
7. Do not allow water or debris to accumulate on top of the Shelter.
8. Do not allow children to play with this product.
9. Avoid a dangerous environment. Do not use this product near high voltage electrical lines.
10. When servicing use only identical replacement parts.
11. Use the right equipment. Do not use this product except for that which it is intended.
12. Store idle equipment indoors. When not in use, this product should be stored indoors in a clean, dry, safe location out of reach of children.
13. Check for damaged parts. Before each use, this product should be carefully checked to determine that it will operate properly and perform its intended function. Check for alignment of parts, binding of parts, breakage of parts, mounting, and any other condition that may affect its operation.
14. Maintain labels and nameplates on this product. These carry important safety information. If unreadable or missing, contact Harbor Freight Tools for a replacement.
15. The warnings, precautions, and instructions discussed in this instruction manual cannot cover all possible conditions and situations that may occur. It must be understood by the operator that common sense and caution are factors which cannot be built into this product, but must be supplied by the operator.



SAVE THESE INSTRUCTIONS.

SPECIFICATIONS

Material	Formed steel tubing / Camouflage polyester with dark olive green draw strings and hook and loop closures.
Main Tube Dimensions	5/8" O.D. x 58-11/16" Long
Recommended Tree Trunk Diameter	9-4/5" to 15-11/16"
Rear Tree Support Bar Dimensions	18-1/2" Wide x 6" L x 3/16" Thick
Cross Tube Dimensions	5/8" O.D. x 24" Long
Arm Tube Dimensions	5/8" O.D. x 22-1/2" Long
Side Tube Dimensions	5/8" O.D. x 14-1/8" Wide x 48-1/2" Long
Overall Dimensions	60" Long x 48" Wide x 81-1/2" High (Includes roof and side walls fully assembled)
Net Weight	16 lb.

UNPACKING

When unpacking, check to make sure that the item is intact and undamaged. If any parts are missing or broken, please call Harbor Freight Tools at the number shown on the cover of this manual as soon as possible.

SET UP INSTRUCTIONS



Read the **ENTIRE IMPORTANT SAFETY INSTRUCTIONS** section at the beginning of this manual including all text under subheadings therein before set up or use of this product.

Note:

For additional information regarding the parts listed in the following pages, refer to the Assembly Diagram on page 7 of this manual.

1. Set the Main Support Frame (3) and the two pieces of Side Frame (2) on a dry, flat, level surface. **(See Assy. Diagram.)**
2. Unfold the two Hinging Braces (4) on the Main Support Frame. Then attach the Support Brace (5) to the Main Support Frame using two Bolts (9), two Flat Washers (15), and two Lock Nuts (16). **(See Assy. Diagram.)**
3. Insert the two Side Frames (2) into the Main Support Frame (3), and fasten the two Side Frames to the Main Support Frame using two Bolts (14), two Flat Washers (15), and two Lock Nuts (16). **(See Assy. Diagram.)**
4. Affix the Strips of the Fabric Cover (1) around the edges of the Main Support Frame (3) and Side Frames (2) with the Draw Strings and Hook and Loop Closures. **(See Assy. Diagram.)**

REV 09a

SKU 96529

For technical questions, please call 1-800-444-3353.

Page 4

5. Use the remaining Draw Strings to secure the rest of the Fabric Cover (1) to the Main Support Frame (3) and Side Frames (2). **(See Assy. Diagram.)**
6. Remove the Bolt (11), Flat Washer (7), and Wing Nut (10) from one end of the Rear Cross Bar (12). **(See Figure A and Assy. Diagram.)**
7. With assistance, position the Hunting Shelter against the trunk of a tree. Adjust the Rear Cross Bar (12) to fit firmly against the tree trunk. Then secure the Hunting Shelter to the tree trunk by re-installing the Bolt (11), Flat Washer (7), and Wing Nut (10) on the Rear Cross Bar. **(See Figure A and Assy. Diagram.)**
8. **NOTE:** Make sure both Bolts (11), Flat Washers (7), and Wing Nuts (10) on the Rear Cross Bar are firmly tightened. **(See Figure A and Assy. Diagram.)**
9. Attach the Side Cover (18) to the Side Frame (2) using the 8 Hooks (17). See diagram on page 7.



FIGURE A

REAR CROSS BAR (12)
BOLT (11)
FLAT WASHER (7)
WING NUT (10)

10. Adjust the height of the shelter so the Side Cover touch the ground. See cover page photo.
11. Attach the bottom of the Side Cover (18) to the ground using the U-Shaped landscape Staples (19). See Parts List and Assembly Diagram on page 6 and 7.

MAINTENANCE AND SERVICING

⚠️ WARNING

Damaged equipment can fail, causing serious personal injury. Do not use damaged equipment. If a problem occurs, have the problem corrected before further use.

Inspection, maintenance, and cleaning

1. **BEFORE EACH USE**, inspect the general condition of the Hunting Shelter. Check for loose screws, misalignment or binding of parts, cracked or broken parts, damaged fabric, and any other condition that may affect its safe operation.
2. **REGULARLY**, clear off any debris or water that may accumulate on the Shelter during use.
3. **AFTER USE**, clean the Hunting Shelter with a clean, moist cloth and mild detergent. Then dry. Do not use solvents.

Troubleshooting

Problem	Possible Causes	Probable Solutions
Hunting Shelter not properly positioned against tree.	1. Too much slack in Rear Cross Bar.	1. Adjust Rear Cross Bar for tighter fit against tree.

PLEASE READ THE FOLLOWING CAREFULLY

THE MANUFACTURER AND/OR DISTRIBUTOR HAS PROVIDED THE PARTS LIST AND ASSEMBLY DIAGRAM IN THIS MANUAL AS A REFERENCE TOOL ONLY. NEITHER THE MANUFACTURER OR DISTRIBUTOR MAKES ANY REPRESENTATION OR WARRANTY OF ANY KIND TO THE BUYER THAT HE OR SHE IS QUALIFIED TO MAKE ANY REPAIRS TO THE PRODUCT, OR THAT HE OR SHE IS QUALIFIED TO REPLACE ANY PARTS OF THE PRODUCT. IN FACT, THE MANUFACTURER AND/OR DISTRIBUTOR EXPRESSLY STATES THAT ALL REPAIRS AND PARTS REPLACEMENTS SHOULD BE UNDERTAKEN BY CERTIFIED AND LICENSED TECHNICIANS, AND NOT BY THE BUYER. THE BUYER ASSUMES ALL RISK AND LIABILITY ARISING OUT OF HIS OR HER REPAIRS TO THE ORIGINAL PRODUCT OR REPLACEMENT PARTS THERETO, OR ARISING OUT OF HIS OR HER INSTALLATION OF REPLACEMENT PARTS THERETO.

PARTS LIST

PARTS LIST

Part	Description	Q'ty
1	Fabric Cover	1
2	Side Frame	2
3	Main Support Frame	1
4	Hinging Brace	2
5	Support Brace	1
6	Bolt (M8x40)	2
7	Flat Washer (#8)	4
8	Lock Nut (M8)	2
9	Bolt (M5x40)	6
10	Wing Nut (M8)	2

Part	Description	Q'ty
11	Bolt (M8x35)	2
12	Rear Cross Bar	1
13	Support Frame	2
14	Bolt (M5x25)	4
15	Flat Washer (#5)	10
16	Lock Nut (M5)	10
17	Hooks	8
18	Side Cover	1
19	U-Shaped Landscape Staple	8

ASSEMBLY DIAGRAM

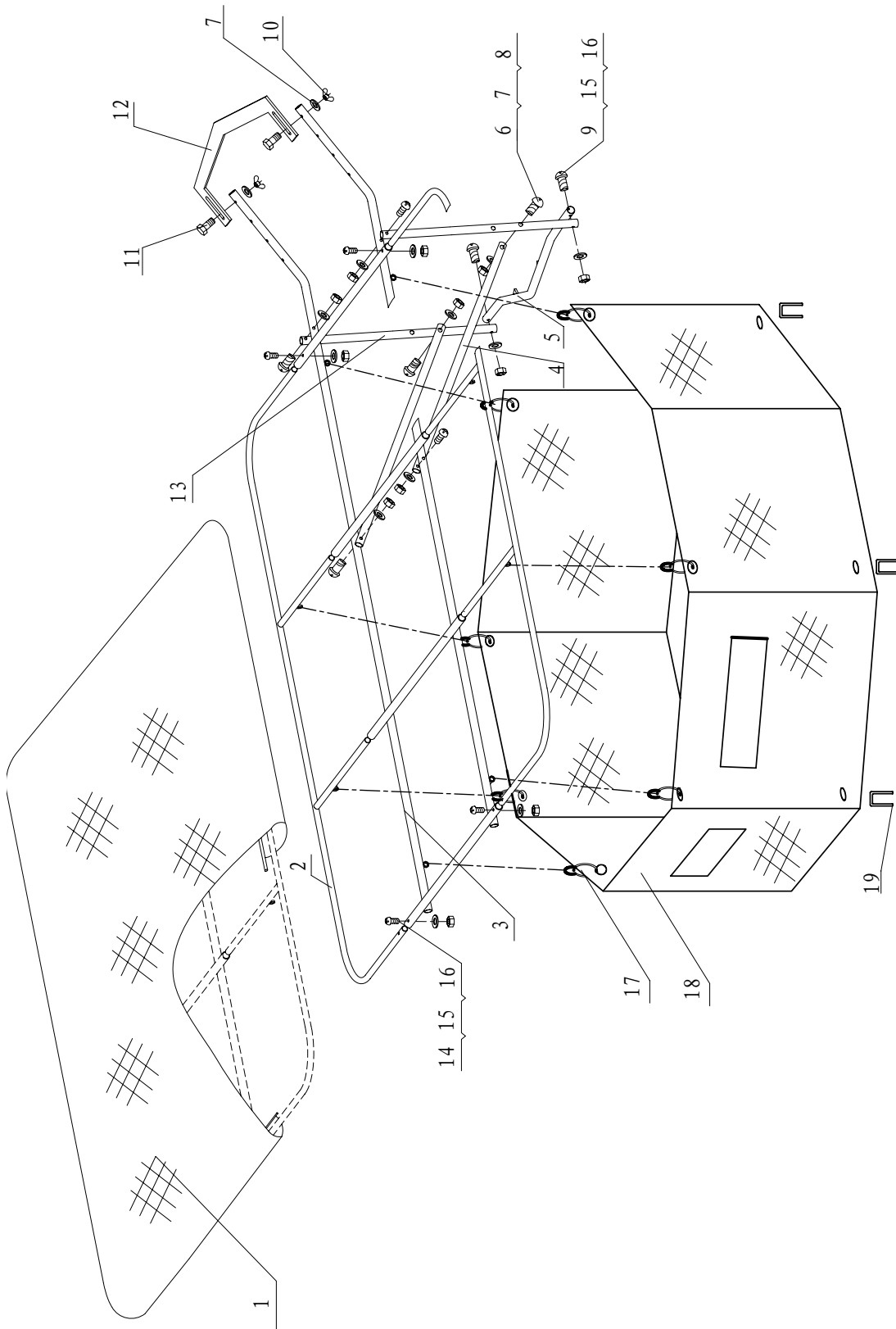

Free Manuals Download Website

<http://myh66.com>

<http://usermanuals.us>

<http://www.somanuals.com>

<http://www.4manuals.cc>

<http://www.manual-lib.com>

<http://www.404manual.com>

<http://www.luxmanual.com>

<http://aubethermostatmanual.com>

Golf course search by state

<http://golfingnear.com>

Email search by domain

<http://emailbydomain.com>

Auto manuals search

<http://auto.somanuals.com>

TV manuals search

<http://tv.somanuals.com>