

Hamilton Beach®

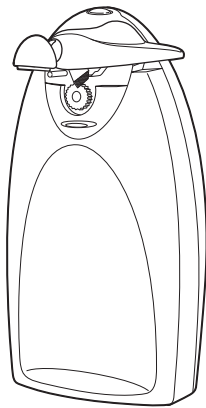

Clean Cut™ Can Opener
Ouvre-boîtes Clean Cut™
Abrelatas Clean Cut™

Le invitamos a leer cuidadosamente este instructivo antes de usar su aparato.

Read before use.
Lire avant utilisation.
Lea antes de usar.



In an effort to reduce paper waste, Hamilton Beach Brands, Inc. has reduced the size of this Use and Care and made it available online. We believe strongly in doing our part to help care for the environment. To view Use and Care guides, recipes, and tips, please visit:

hamiltonbeach.com

Aidez-nous à protéger l'environnement !

Dans le but de réduire la consommation de papier, Hamilton Beach Brands, Inc. a réduit le format des manuels d'utilisation et d'entretien et offre maintenant la version complète en ligne. Nous croyons fermement que nous contribuons à sauvegarder l'environnement. Pour voir les manuels d'utilisation et d'entretien, les recettes et les conseils, veuillez consulter le site :

hamiltonbeach.ca

¡Ayude a Hamilton Beach a Hacer la Diferencia!

En un esfuerzo por reducir el papel de desecho, Hamilton Beach Brands, Inc., ha reducido el tamaño de este Uso y Cuidado y lo puso disponible en línea. Creemos fuertemente en hacer nuestra parte para ayudar a cuidar el medioambiente. Para ver guías de Uso y Cuidado, recetas y consejos, por favor visite:

hamiltonbeach.com.mx

USA: 1.800.851.8900

Canada: 1.800.267.2826

México: 01.800.71.16.100

840091201

IMPORTANT SAFEGUARDS

When using electrical appliances, basic safety precautions should always be followed, including the following:

1. Read all instructions.
2. To protect against risk of electrical shock, do not put can opener body, cord, or plug in water or other liquid.
3. Close supervision is necessary when any appliance is used by or near children.
4. Unplug from outlet when not in use, before putting on or taking off parts, and before cleaning.
5. Avoid contacting moving parts.
6. Do not operate any appliance with a damaged cord or plug, or after the appliance malfunctions or is dropped or damaged in any manner. Call our toll-free customer service number for information on examination, repair, or electrical or mechanical adjustment.
7. The use of attachments not recommended or sold by the appliance manufacturer may cause fire, electric shock, or injury.
8. Do not use outdoors.
9. Do not let cord hang over edge of table or counter or touch hot surfaces, including the stove.
10. Do not open pressurized (aerosol-type) cans.
11. Do not open cans of flammable liquids such as lighter fluid.

SAVE THESE INSTRUCTIONS

Other consumer safety information

This appliance is intended for household use only.

WARNING! Shock Hazard: This appliance has a polarized plug (one wide blade) that reduces the risk of electric shock. The plug fits only one way into a polarized outlet. Do not defeat the safety purpose of the plug by modifying the plug in any way or using an adapter. If the plug does not fit, reverse the plug. If it still does not fit, have an electrician replace the outlet.

The length of the cord used on this appliance was selected to reduce the hazards of becoming tangled in or tripping over a longer cord. If a longer cord is necessary, an approved extension cord may be used. The electrical rating of the extension cord must be equal to or greater than the rating of the appliance. Care must be taken to arrange the extension cord so that it will not drape over the countertop or tabletop where it can be pulled on by children or accidentally tripped over.

Parts and features

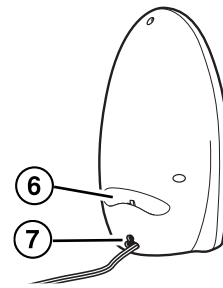
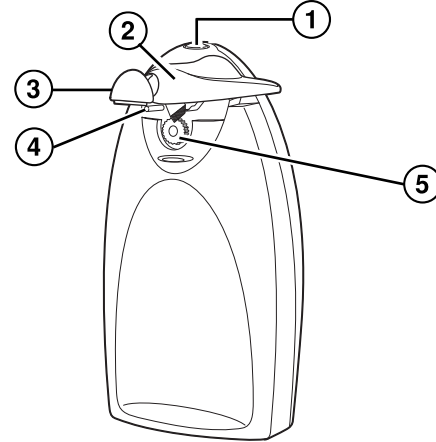

1. Cutting Unit Release Button
2. Piercing Lever
3. Magnetic Lid Holder
4. Can Guide Pin
5. Geared Wheel
6. Knife Sharpener
7. Cord Storage and Lock Slot

How to use the can opener

1. Place can opener on level surface.
2. Plug cord into electrical outlet.
3. Raise piercing lever up.
4. Place rim of can firmly under can guide pin and against the geared wheel.
5. Press piercing lever all the way down.
6. The motor will begin turning can and cutting lid. (It is not necessary to hold the piercing lever down or to hold the can during the cutting action.)
7. The motor will automatically stop when the can is open.
8. Remove can from can opener and check can contents to remove any pieces of label or metal shavings.

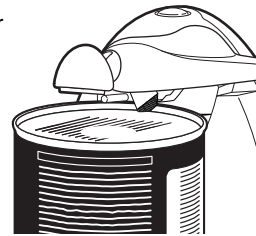

How to use the knife sharpener

1. Place cutting edge of knife in the knife slot located on the back of the can opener.
 2. Draw the knife blade through the slot several times.
 3. Clean knife after sharpening.
- NOTICE:** Serrated blades should never be inserted into this unit.

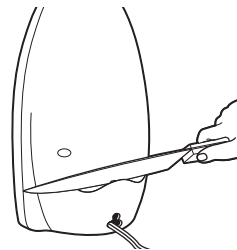

Care and cleaning

WARNING Electric Shock Hazard. Do not immerse the can opener in water or any other liquid.

1. Unplug cord from electrical outlet.
2. **To remove the cutting unit:** Press release button.
3. Wash cutting unit in hot soapy water. Rinse and dry thoroughly. Can also be placed in top rack of dishwasher.
4. Wipe the can opener body and the area behind the cutting unit with a damp cloth. Never immerse the can opener in water.
5. **To re-assemble:** Raise lever slightly then slide the cutting unit onto the body until the release button clicks into place.

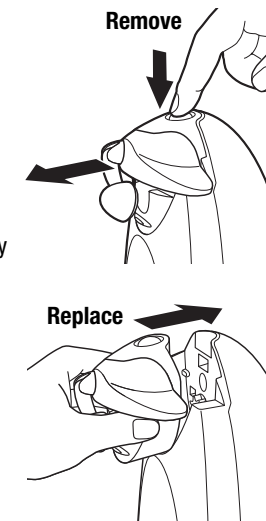

Tips for best use

- The can opener will easily open all standard size cans.
- If there is a bump, dent, or heavy seam in rim of can, open other end of the can or position the cutting unit to start opening just beyond the problem.
- The motor of your can opener is permanently lubricated and will require no oiling.
- To use cord storage on back of opener, push in or pull out cord as needed.
- To lock the cord, turn cord sideways and slide up into cord lock slot.
- If piercing lever does not move freely, remove and clean the cutting unit.

Limited warranty

This warranty applies to products purchased in the U.S. and Canada. This is the only express warranty for this product and is in lieu of any other warranty or condition.

This product is warranted to be free from defects in material and workmanship for a period of one (1) year from the date of original purchase. During this period, your exclusive remedy is repair or replacement of this product or any component found to be defective, at our option; however, you are responsible for all costs associated with returning the product to us and our returning a product or component under this warranty to you. If the product or component is no longer available, we will replace with a similar one of equal or greater value.

This warranty does not cover glass, filters, wear from normal use, use not in conformity with the printed directions, or damage to the product resulting from accident, alteration, abuse, or misuse. This warranty extends only to the original consumer purchaser or gift recipient. Keep the original sales receipt, as proof of purchase is required to make a warranty claim. This warranty is void if the product is used for other than single-family household use.

We exclude all claims for special, incidental, and consequential damages caused by breach of express or implied warranty. All liability is limited to the amount of the purchase price. **Every implied warranty, including any statutory warranty or condition of merchantability or fitness for a particular purpose, is disclaimed except to the extent prohibited by law, in which case such warranty or condition is limited to the duration of this written warranty.** This warranty gives you specific legal rights. You may have other legal rights that vary depending on where you live. Some states or provinces do not allow limitations on implied warranties or special, incidental, or consequential damages, so the foregoing limitations may not apply to you.

To make a warranty claim, do not return this appliance to the store. Please call 1.800.851.8900 in the U.S. or 1.800.267.2826 in Canada or visit hamiltonbeach.com in the U.S. or hamiltonbeach.ca in Canada. For faster service, locate the model, type, and series numbers on your appliance.

IMPORTANT CONSEILS DE SÉCURITÉ

Pendant l'utilisation d'appareils électriques, des mesures de sécurité élémentaires doivent toujours être respectées, incluant les suivantes:

1. Lire toutes les instructions.
2. Pour prévenir tout risque d'électrocution, ne pas immerger l'appareil ouvre-boîte, le cordon ou la fiche dans l'eau ou dans tout autre liquide.
3. Une supervision vigilante est nécessaire pendant l'utilisation de tout appareil par ou près des enfants.
4. Débrancher l'appareil avant d'y ajouter ou d'en retirer des pièces ou avant de le nettoyer.
5. Éviter de toucher des pièces mobiles.
6. N'utiliser aucun appareil dont le cordon ou la prise est endommagé, ou à la suite de toute anomalie de fonctionnement de l'appareil, d'une chute ou de tout autre dommage. Appeler le numéro sans frais du service à la clientèle pour plus d'information à propos d'une vérification, d'une réparation ou d'un réglage électrique ou mécanique.
7. L'utilisation d'accessoires que le fabricant ne vend pas ou ne recommande pas peut occasionner un incendie, l'électrocution ou des blessures.
8. Ne pas utiliser à l'extérieur.
9. Ne pas laisser pendre le cordon de la table ou du comptoir et éviter que le cordon n'entre en contact avec des surfaces chaudes, y compris la cuisinière.
10. Ne pas ouvrir de contenants aérosols sous pression.
11. Ne pas ouvrir de contenants renfermant du liquide inflammable.

CONSERVER CES INSTRUCTIONS

Autre consigne de sécurité pour le consommateur

Cet appareil est conçu pour une utilisation domestique seulement.

AVERTISSEMENT! Risque d'électrocution: Cet appareil est doté d'une fiche polarisée (lame large) qui réduit le risque d'électrocution. Cette fiche s'insère d'une seule manière dans une prise polarisée. Ne pas transformer le dispositif de sécurité de la fiche en modifiant celle-ci de quelque façon ou en utilisant un adaptateur. Si la fiche refuse de s'insérer, inversez-la. Si elle refuse toujours de s'insérer, faites remplacer la prise par un électricien.

La longueur du cordon installé sur cet appareil a été sélectionnée afin de réduire les risques d'enchevêtrement ou de faux pas causés par un fil trop long. L'utilisation d'une rallonge approuvée est permise, si le cordon est trop court. Les caractéristiques électriques de la rallonge doivent être équivalentes ou supérieures aux caractéristiques de l'appareil. Prendre toutes les précautions nécessaires pour installer la rallonge de manière à ne pas la faire courir sur le comptoir ou sur une table pour éviter qu'un enfant ne tire sur le cordon ou trébuche accidentellement.

Free Manuals Download Website

<http://myh66.com>

<http://usermanuals.us>

<http://www.somanuals.com>

<http://www.4manuals.cc>

<http://www.manual-lib.com>

<http://www.404manual.com>

<http://www.luxmanual.com>

<http://aubethermostatmanual.com>

Golf course search by state

<http://golfingnear.com>

Email search by domain

<http://emailbydomain.com>

Auto manuals search

<http://auto.somanuals.com>

TV manuals search

<http://tv.somanuals.com>