

SMT Power Inductor

SIA3329 Type

Features

- RoHS compliant.
- Low profile (2.9mm max. high) SMD type.
- Unshielded.
- Self-leads, suitable for high density mounting.
- High energy storage and low DCR.
- Provided with embossed carrier tape packing.
- Ideal for power source circuits, DC-DC converter, DC-AC inverters inductor application.
- In addition to the standard versions shown here, customized inductors are available to meet your exact requirements.

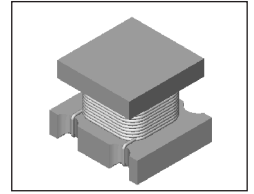

Mechanical Dimension:

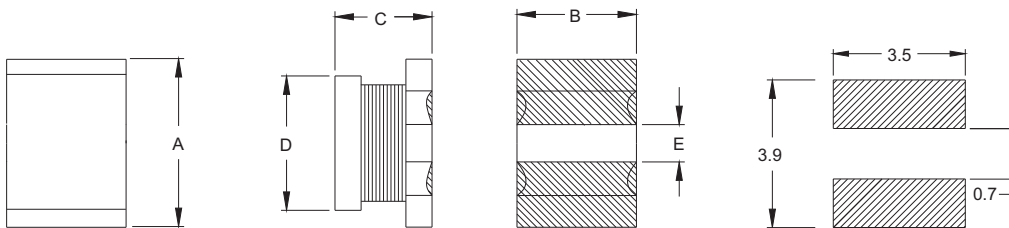

UNIT:mm/inch
 A = 3.35±0.2/0.132±0.008
 B = 2.85±0.2/0.112±0.008
 C = 2.9/0.114 Max.
 D = 2.6±0.2/0.102±0.008
 E = 1.1/0.043Min.

Electrical Characteristics : At 25°C: 100KHz, 0.1V

PART NO.	L ¹ (μH)	DCR (Ω) MAX	I _{rated} ² (A dc)
SIA3329-0R9	0.9	0.038	3.00
SIA3329-1R2	1.2	0.050	2.90
SIA3329-1R5	1.5	0.055	2.50
SIA3329-1R8	1.8	0.062	2.30
SIA3329-2R2	2.2	0.075	2.10
SIA3329-2R7	2.7	0.095	1.80
SIA3329-3R3	3.3	0.110	1.70
SIA3329-3R9	3.9	0.130	1.40
SIA3329-4R7	4.7	0.150	1.30
SIA3329-5R6	5.6	0.170	1.20
SIA3329-6R8	6.8	0.195	1.10
SIA3329-8R2	8.2	0.230	1.00
SIA3329-100	10.0	0.290	0.95
SIA3329-120	12.0	0.375	0.85
SIA3329-150	15.0	0.450	0.75
SIA3329-180	18.0	0.590	0.70
SIA3329-220	22.0	0.680	0.64
SIA3329-270	27.0	0.820	0.58
SIA3329-330	33.0	1.160	0.50
SIA3329-390	39.0	1.210	0.48
SIA3329-470	47.0	1.400	0.45
SIA3329-560	56.0	1.780	0.40
SIA3329-680	68.0	2.020	0.36
SIA3329-820	82.0	2.240	0.32
SIA3329-101	100.0	3.150	0.29
SIA3329-151	150.0	4.600	0.24

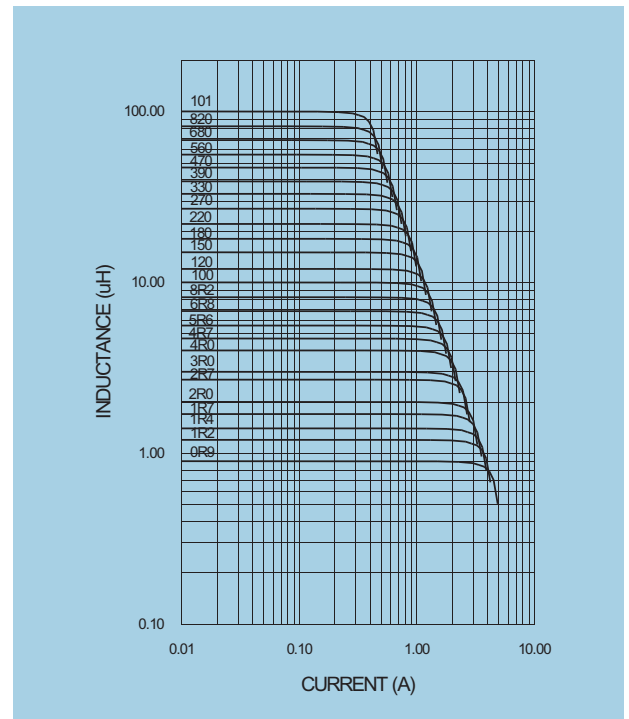

1. Tolerance of inductance
K: ±10%(0.9~100μH).
2. I_{rated} is the DC current which cause the inductance drop less than 10% of its nominal inductance without current and the surface temperature of the part increase less than 45°C.
3. Operating temperature : -20°C to 105°C (including self-temperature rise).



DELTA ELECTRONICS, INC.

(TAOYUAN PLANT CPBG) 252, SAN YING ROAD, KUEISAN INDUSTRIAL ZONE, TAOYUAN SHIEN, 333, TAIWAN, R.O.C.

TEL: 886-3-3591968; FAX: 886-3-3591991

<http://www.deltawww.com>

Free Manuals Download Website

<http://myh66.com>

<http://usermanuals.us>

<http://www.somanuals.com>

<http://www.4manuals.cc>

<http://www.manual-lib.com>

<http://www.404manual.com>

<http://www.luxmanual.com>

<http://aubethermostatmanual.com>

Golf course search by state

<http://golfingnear.com>

Email search by domain

<http://emailbydomain.com>

Auto manuals search

<http://auto.somanuals.com>

TV manuals search

<http://tv.somanuals.com>