

# Air Cleaner 50-875



PART NO. 907370 - 02-25-04  
Copyright © 2004 Delta Machinery



To learn more about DELTA MACHINERY  
visit our website at: [www.deltamachinery.com](http://www.deltamachinery.com).

**For Parts, Service, Warranty or other Assistance,**

**please call 1-800-223-7278 (In Canada call 1-800-463-3582).**

**ESPAÑOL: PÁGINA 11**

# SAFETY GUIDELINES - DEFINITIONS

This manual contains information that is important for you to know and understand. This information relates to protecting YOUR SAFETY and PREVENTING EQUIPMENT PROBLEMS. To help you recognize this information, we use the symbols below. Please read the manual and pay attention to these sections.

- ▲ DANGER** Indicates an imminently hazardous situation which, if not avoided, will result in death or serious injury.
- ▲ WARNING** Indicates a potentially hazardous situation which, if not avoided, could result in death or serious injury.
- ▲ CAUTION** Indicates a potentially hazardous situation which, if not avoided, may result in minor or moderate injury.
- CAUTION** Used without the safety alert symbol indicates potentially hazardous situation which, if not avoided, may result in property damage.

## GENERAL SAFETY RULES



**▲ WARNING** READ AND UNDERSTAND ALL WARNINGS AND OPERATING INSTRUCTIONS BEFORE USING THIS EQUIPMENT. Failure to follow all instructions listed below, may result in electric shock, fire, and/or serious personal injury or property damage.

### IMPORTANT SAFETY INSTRUCTIONS

Woodworking can be dangerous if safe and proper operating procedures are not followed. As with all machinery, there are certain hazards involved with the operation of the product. Using the machine with respect and caution will considerably lessen the possibility of personal injury. However, if normal safety precautions are overlooked or ignored, personal injury to the operator may result. Safety equipment such as guards, push sticks, hold-downs, featherboards, goggles, dust masks and hearing protection can reduce your potential for injury. But even the best guard won't make up for poor judgment, carelessness or inattention. Always use common sense and exercise caution in the workshop. If a procedure feels dangerous, don't try it. Figure out an alternative procedure that feels safer. **REMEMBER:** Your personal safety is your responsibility. For additional information please visit our website [www.deltamachinery.com](http://www.deltamachinery.com).

**▲ WARNING** This machine was designed for certain applications only. Delta Machinery strongly recommends that this machine not be modified and/or used for any application other than that for which it was designed. If you have any questions relative to a particular application, **DO NOT** use the machine until you have first contacted Delta to determine if it can or should be performed on the product.

**Technical Service Manager**  
**Delta Machinery**  
**4825 Highway 45 North**  
**Jackson, TN 38305**  
(IN CANADA: 505 SOUTHGATE DRIVE, GUELPH, ONTARIO N1H 6M7)

**▲ WARNING** FAILURE TO FOLLOW THESE RULES MAY RESULT IN SERIOUS PERSONAL INJURY.

1. **FOR YOUR OWN SAFETY, READ AND UNDERSTAND THE INSTRUCTION MANUAL BEFORE OPERATING THE UNIT.** Learn the unit's application and limitations as well as the specific hazards peculiar to it.
2. **KEEP WORK AREA CLEAN.** Cluttered areas and benches invite accidents.
3. **DON'T USE IN DANGEROUS ENVIRONMENT.** Don't use this unit in damp or wet locations, or expose it to rain. Keep work area well-lighted.
4. **KEEP CHILDREN AND VISITORS AWAY.** All children and visitors should be kept a safe distance from work area.
5. **DISCONNECT UNIT** before servicing.
6. **CHECK DAMAGED PARTS.** Before further use of the unit, properly repair or replace any part that is damaged.

# ADDITIONAL SAFETY RULES FOR AIR CLEANERS

**▲ WARNING** FAILURE TO FOLLOW THESE RULES MAY RESULT IN SERIOUS INJURY.

**▲ DANGER**

**DO NOT USE THIS UNIT TO FILTER METAL DUST.** Combining wood and metal dust can create an explosion or fire hazard. This unit is intended to filter non-explosive atmospheres only.

**▲ WARNING**

**DO NOT USE THIS UNIT TO DISSIPATE FUMES OR SMOKE.** Explosions or fire can result. This air cleaner is intended for use where only dry airborne dust is present. Its use should be limited to non-explosive, non-metallic atmospheres.

1. **DO NOT OPERATE THIS UNIT** until it is completely assembled and installed according to the instructions. A unit incorrectly assembled can cause injury.
2. **OBTAIN ADVICE** from your supervisor, instructor, or another qualified person if you are not thoroughly familiar with the operation of this unit. Knowledge is safety.
3. **FOLLOW ALL WIRING CODES** and recommended electrical connections to prevent electrical shock or electrocution.
4. **DO NOT LIFT THIS UNIT BY THE POWER CORD.** Do not use the power cord as a hanging device. A damaged power cord can cause electrical shock or electrocution.
5. **SECURELY ANCHOR THIS UNIT** to a permanent or fixed supporting structure when suspending it from the ceiling. A falling unit can cause serious injury. Always keep a minimum of 7 feet between the bottom of the unit and the floor surface to allow for sufficient head clearance. Use only a chain rated for a minimum of 150 lb. working load to adequately hold the unit. Use steel S-Hooks that are at least 1/4" in diameter to suspend the unit from the ceiling. Lag-type bolts used to suspend the unit from the ceiling must be threaded at least 1-1/2" into supporting structural members.
6. **SUPPORT THIS UNIT** or securely clamp it to the work surface when it is used in a portable application to eliminate potential injury and/or damage to the unit.
7. **ENSURE THAT THE INTAKE AND EXHAUST AREAS ARE CLEAR** prior to starting the unit. Clogged intakes or exhausts can cause an explosion and/or fire.
8. **KEEP ARMS, HANDS, AND FINGERS AWAY FROM THE FAN.** Avoid all exposure to rotating parts to prevent injury.
9. **DO NOT OPERATE THIS UNIT WITHOUT THE FILTERS IN PLACE.** Dust and other small debris will go directly to the motor, causing over-heating and the potential for fire and/or explosion.
10. **DO NOT ATTEMPT** to remove or replace the filter(s) while the unit is running. Exposed fan blades can cause severe cuts. Make certain that the unit is disconnected from the power source.
11. **MAINTAIN THE UNIT** in top condition. Clogged filters can increase the potential for fire or explosion. Follow all instructions for changing and cleaning filters.
12. **STORE THE UNIT** in a location that eliminates the potential for damage to the power cord. A damaged power cord can cause shock or electrocution. Safely store power cord on the unit to eliminate tripping hazards.
13. **TURN THE UNIT "OFF"** and disconnect the unit from the power source before installing or removing accessories, before adjusting or changing set-ups, or when making repairs. An accidental start-up can cause serious injury.

## SAVE THESE INSTRUCTIONS.

Refer to them often  
and use them to instruct others.

# POWER CONNECTIONS

A separate electrical circuit should be used for your machines. This circuit should not be less than #12 wire and should be protected with a 20 Amp time lag fuse. If an extension cord is used, use only 3-wire extension cords which have 3-prong grounding type plugs and matching receptacle which will accept the machine's plug. Before connecting the machine to the power line, make sure the switch (s) is in the "OFF" position and be sure that the electric current is of the same characteristics as indicated on the machine. All line connections should make good contact. Running on low voltage will damage the machine.

**⚠ DANGER DO NOT EXPOSE THE MACHINE TO RAIN OR OPERATE THE MACHINE IN DAMP LOCATIONS.**

# MOTOR SPECIFICATIONS

Your machine is wired for 120 volts, 60 HZ alternating current. Before connecting the machine to the power source, make sure the switch is in the "OFF" position.

# GROUNDING INSTRUCTIONS

**⚠ DANGER THIS MACHINE MUST BE GROUNDED WHILE IN USE TO PROTECT THE OPERATOR FROM ELECTRIC SHOCK.**

## 1. All grounded, cord-connected machines:

In the event of a malfunction or breakdown, grounding provides a path of least resistance for electric current to reduce the risk of electric shock. This machine is equipped with an electric cord having an equipment-grounding conductor and a grounding plug. The plug must be plugged into a matching outlet that is properly installed and grounded in accordance with all local codes and ordinances.

Do not modify the plug provided - if it will not fit the outlet, have the proper outlet installed by a qualified electrician.

Improper connection of the equipment-grounding conductor can result in risk of electric shock. The conductor with insulation having an outer surface that is green with or without yellow stripes is the equipment-grounding conductor. If repair or replacement of the electric cord or plug is necessary, do not connect the equipment-grounding conductor to a live terminal.

Check with a qualified electrician or service personnel if the grounding instructions are not completely understood, or if in doubt as to whether the machine is properly grounded.

Use only 3-wire extension cords that have 3-prong grounding type plugs and matching 3-conductor receptacles that accept the machine's plug, as shown in Fig. A.

Repair or replace damaged or worn cord immediately.

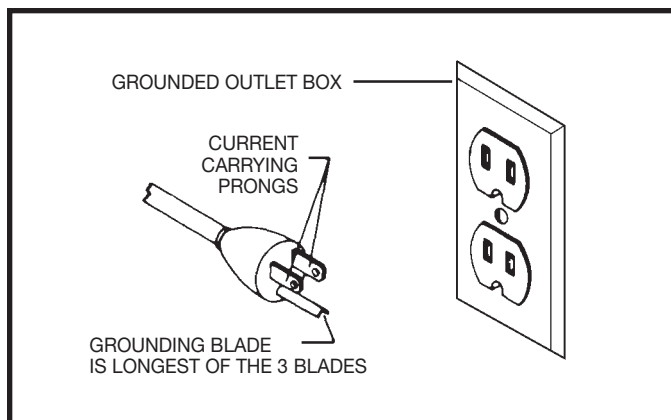

Fig. A

## 2. Grounded, cord-connected machines intended for use on a supply circuit having a nominal rating less than 150 volts:

If the machine is intended for use on a circuit that has an outlet that looks like the one illustrated in Fig. A, the machine will have a grounding plug that looks like the plug illustrated in Fig. A. A temporary adapter, which looks like the adapter illustrated in Fig. B, may be used to connect this plug to a matching 2-conductor receptacle as shown in Fig. B if a properly grounded outlet is not available. The temporary adapter should be used only until a properly grounded outlet can be installed by a qualified electrician. The green-colored rigid ear, lug, and the like, extending from the adapter must be connected to a permanent ground such as a properly grounded outlet box. Whenever the adapter is used, it must be held in place with a metal screw.

**NOTE: In Canada, the use of a temporary adapter is not permitted by the Canadian Electric Code.**

**⚠ DANGER IN ALL CASES, MAKE CERTAIN THE RECEPTACLE IN QUESTION IS PROPERLY GROUNDED. IF YOU ARE NOT SURE, HAVE A QUALIFIED ELECTRICIAN CHECK THE RECEPTACLE.**

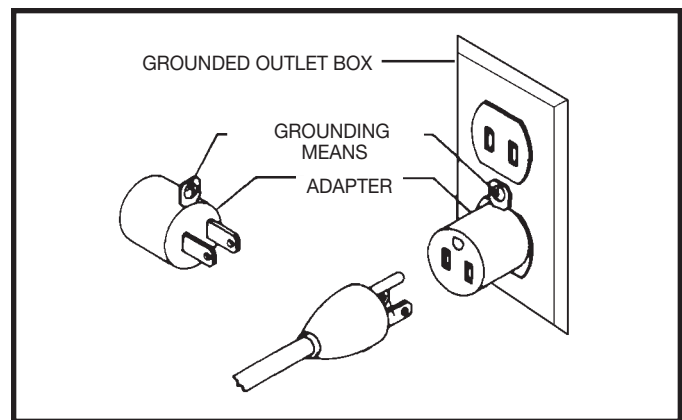

Fig. B

# EXTENSION CORDS

**CAUTION** Use proper extension cords. Make sure your extension cord is in good condition and is a 3-wire extension cord which has a 3-prong grounding type plug and matching receptacle which will accept the machine's plug. When using an extension cord, be sure to use one heavy enough to carry the current of the machine. An undersized cord will cause a drop in line voltage, resulting in loss of power and overheating. Fig. D-1 shows the correct gauge to use depending on the cord length. If in doubt, use the next heavier gauge. The smaller the gauge number, the heavier the cord.

MINIMUM GAUGE EXTENSION CORD			
RECOMMENDED SIZES FOR USE WITH STATIONARY ELECTRIC MACHINES			
Ampere Rating	Volts	Total Length of Cord in Feet	Gauge of Extension Cord
0-6	120	up to 25	18 AWG
0-6	120	25-50	16 AWG
0-6	120	50-100	16 AWG
0-6	120	100-150	14 AWG
6-10	120	up to 25	18 AWG
6-10	120	25-50	16 AWG
6-10	120	50-100	14 AWG
6-10	120	100-150	12 AWG
10-12	120	up to 25	16 AWG
10-12	120	25-50	16 AWG
10-12	120	50-100	14 AWG
10-12	120	100-150	12 AWG
12-16	120	up to 25	14 AWG
12-16	120	25-50	12 AWG
12-16	120	GREATER THAN 50 FEET NOT RECOMMENDED	

Fig. D-1

## FUNCTIONAL DESCRIPTION

### FOREWORD

Model 50-875 Delta Air Cleaner is specifically designed to quietly circulate and filter non-metallic dust which is generated throughout the work area. The Air Cleaner is furnished with two filters: an outer filter which filters particles that are five microns and larger, and a secondary disposable filter that captures 91% of the dust particles that are one micron and larger (one micron = one millionth of a meter). Because breathing microscopic particles can be a potential health hazard, filtering microscopic dust particles offers a cleaner and safer environment. This Air Cleaner will filter the air in a room measuring 20' x 20' x 8' either 13, 16, or 18 times an hour, depending on the setting. If desired, multiple units can be used to filter larger areas. An occasional cleaning and/or replacement of filters is the only required maintenance.

## CARTON CONTENTS



Fig. 1A

1. Air cleaner

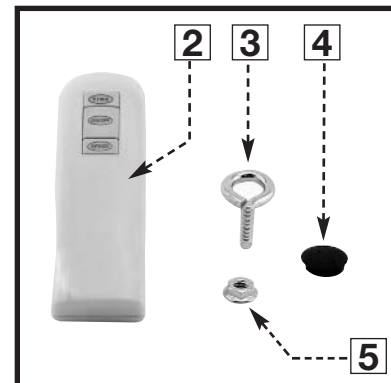

Fig. 1B

2. Remote Control Unit  
(Batteries not included)
3. 1" Eye-Bolts (4)
4. Rubber Feet (4)
5. 1/4-20 Flange Nuts (4)

# UNPACKING AND CLEANING

The Air Cleaner is shipped complete in one shipping container. Carefully unpack the Air Cleaner and all loose items from the shipping container.

Styrofoam blocks have been packed inside the unit for protection. REMOVE THESE BLOCKS (A) Fig. 1 prior to use. To Remove:

1. Disconnect unit from power source.
2. Remove outer filter by lifting up on the bottom and pulling out (Fig. 2A).
3. Remove inner filter by lifting up on the bottom and pulling out (Fig. 2B).
4. Remove styrofoam blocks (A) Fig. 2C and replace filters.

**⚠ WARNING DO NOT LIFT THE AIR CLEANER BY POWER CORD.**



Fig. 2A

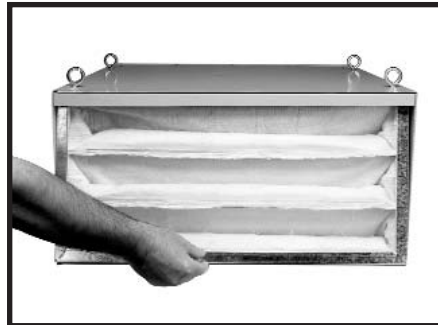

Fig. 2B

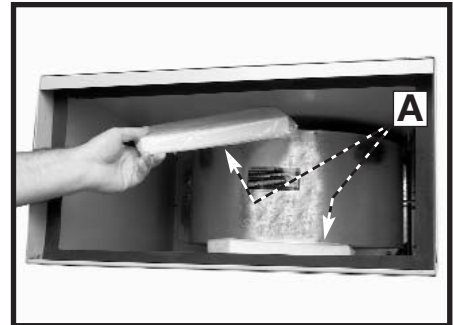

Fig. 2C

## ASSEMBLY

Determine whether the Air Cleaner will be used on the floor, on a bench, or hanging from an overhead support. If the Air Cleaner will be used as a mobile unit, proceed to “**USING THE AIR CLEANER ON A BENCH OR FLOOR SURFACE**” section. If the unit will be ceiling-mounted, proceed to section “**MOUNTING THE AIR CLEANER TO A CEILING OR OVERHEAD SUPPORT.**”

**IMPORTANT:** When determining where to mount the air cleaner, always select a location where the air flow is unrestricted. Do not locate the unit in a corner or near any heating or cooling vents.

### USING THE AIR CLEANER ON A BENCH OR FLOOR SURFACE

Locate (4) self-adhesive rubber feet (A) Fig. 3 supplied with the unit. Carefully place the Air Cleaner on a firm supporting surface with access to the bottom of the cabinet. Apply a self-adhesive rubber foot (A) Fig. 3 to the bottom at each corner of the air cleaner cabinet. The rubber feet will help eliminate vibration and will prevent the possibility of the air cleaner “walking” across the floor or work surface.

**⚠ WARNING** For operator safety, clamp the unit to a work bench or position it securely on sawhorses.

The air cleaner cabinet has convenient lifting handles located on either side (one of which is shown at (A) Fig. 4). To avoid damage to the air filters, carry the air cleaner with the filters positioned away from your body.

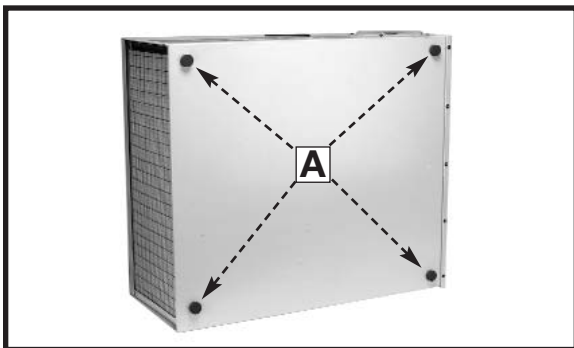

Fig. 3

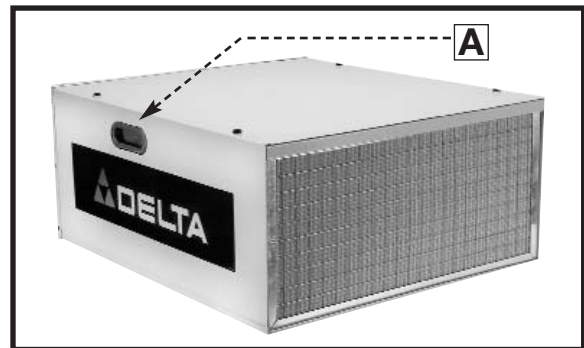

Fig.4

## MOUNTING THE AIR CLEANER TO THE CEILING OR OVERHEAD SUPPORT

**⚠ WARNING** This unit weighs approximately 60 pounds. When mounting overhead, be certain that the unit is securely fastened and supported.

1. Locate the four 1" eye bolts and the four 1/4-20 flange nuts supplied with the unit.
2. Use a flat blade screwdriver (not supplied) to remove the four screws (C) Fig. 5 from the top of air cleaner (D).
3. Thread one flange nut on each bolt approximately 3/4".
4. Thread the eye-bolts (F) Fig. 6 into the four holes where the screws were removed in **STEP 2**.

**NOTE:** Be certain that the flange nuts are tightened against the surface of the air cleaner.

**NOTE:** When suspending the air cleaner from the ceiling or other overhead support, use steel s-hooks that are a minimum of 1/4".

**NOTE:** Thread all lag hooks at least 1-1/2" into the supporting structural members.

**⚠ WARNING** Never secure the air cleaner hardware to drywall, drop ceiling tile/frame, or other non-structural members.

**⚠ CAUTION** Keep a minimum of seven feet between bottom of air cleaner and the floor surface.

**DO NOT** use rope, cable, or power cord to suspend the unit from the ceiling. Use chain rated for a minimum of a 150 lb. working load.

**IMPORTANT:** When determining a location to mount the unit, the air cleaner will operate more efficiently when the air flow is unrestricted. Do not locate the unit in a corner or near any heating or cooling vents.

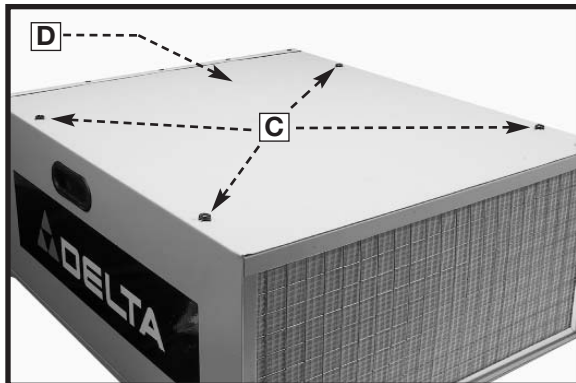

Fig. 5

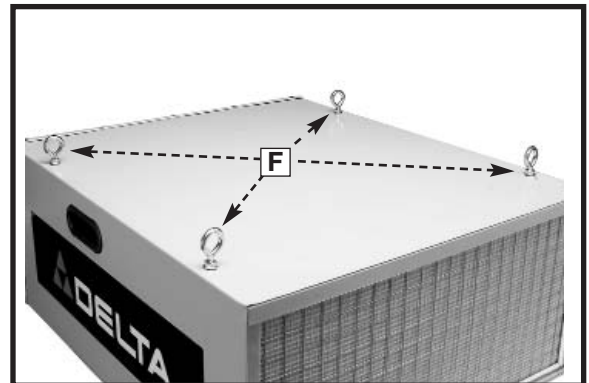

Fig. 6

## ON/OFF SWITCH

The Air Cleaner is equipped with an in-line rocker switch (M) Fig.7, located on the power cord (N). To start or stop the motor, press downward on the rocker switch, according to the markings on the side. When you are finished with the air cleaner, turn the switch off rather than unplug the unit.

**NOTE:** The ON-OFF Switch must be turned "ON" before using the remote control feature.

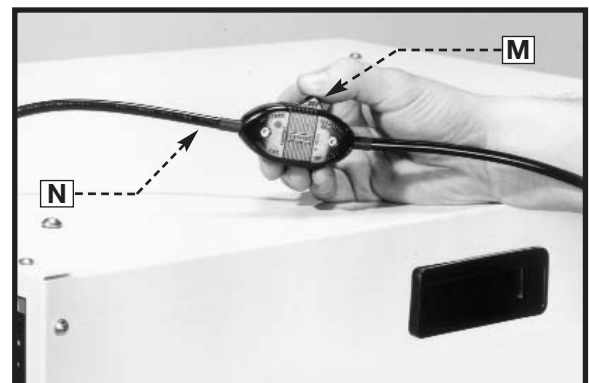

Fig. 7

## USING THE REMOTE CONTROL

**⚠ WARNING** To reduce the risk of fire or electric shock, do not use this unit with any solid-state speed control device.

The remote control provided with this unit is not considered a solid-state device.

The Air Cleaner is equipped with a REMOTE CONTROL (A) Fig.8A.

**NOTE:** The remote requires two (2) AAA batteries (not supplied). The Battery housing is located underneath the back cover.

Notice that the remote control has three control buttons (Fig. 8A): TIME (B), ON/OFF (C), and SPEED (D). These buttons correspond to the LED sensor panel on the rear of the machine (K) Fig. 10B.

**NOTE:** When the machine is connected to the power source, a green light (E) will be activated on the panel.

To activate the blower unit, press the “ON/OFF” button (C) Fig. 8A. The machine will begin in the default speed of Low or “L” on the sensor panel. Press the SPEED button once, and the machine will run at the high (or “H” level). Press the SPEED button again, and the machine will run at the medium speed (or “M”). Press the SPEED button a third time, and the machine will return to the Low Speed mode.

To turn the machine off, press the “ON/OFF” button (C) Fig. 8A.

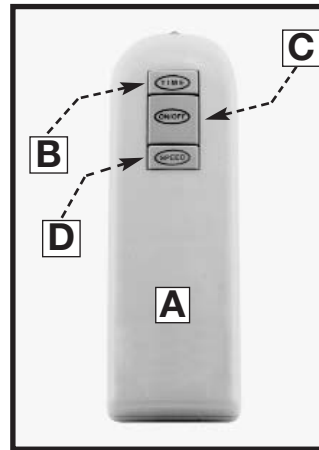

Fig. 8A

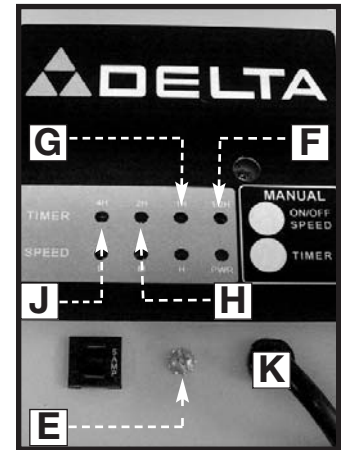

Fig. 8B

This unit has a timer that can be set by remote control.

When the “TIME” button (B) Fig. 8A is pressed on the remote control, the machine will run for 1/2 hour. (An LED light will show up on the sensor panel (F) Fig. 8B). Pressing the “TIME” button again will set the machine to run for one hour. Notice that the light on the sensor panel has now moved to the 1H location (G) Fig. 8B. When the “TIME” button is pressed a third time, the machine will run for two hours. At this point, the green light will show up under the two hour location (H). When you press the “TIME” button the fourth time, the unit will run for four hours. Notice that the indicator light (J) glows at the four hour mark.

All of these functions can be manually controlled by using the two buttons on the sensor panel (K) Fig. 8B.

## OPERATION

**NOTE:** The air cleaner may produce a slight odor for the first few hours of operation due to the protective coating which is applied to internal components. This odor will dissipate and should be disregarded.

**IMPORTANT:** Never operate the air cleaner without air filters in place.

The Delta 50-875 Air Cleaner can be used in

- bench-top sanding applications.
- circular saw applications.
- dry wall applications.
- shop cleaning applications.
- floor sanding applications.
- any other application where non-metallic dust is a factor.

## MAINTENANCE

### CHANGING AND CLEANING FILTERS

The model 50-875 Air Cleaner has an “air flow” indicator (A) Fig. 9A located on the left side of the unit. To check the filters, turn the unit “ON”. If the indicator points to “green” (B) Fig. 9A, the filters are clean. Clean (or change) the filters when the indicator points to “red” (C) Fig. 9A as follows:

- Turn the unit “OFF”.
- Remove the outer first stage filter (A) Fig. 9B by lifting and pulling out on the bottom of the filter. Clean or replace the first stage filter depending on its condition. Clean this filter in one of two ways: Use a shop vac to remove the dust, or use compressed air (30 psi maximum) to blow the dust out of the filter. If you replace the outer filter, check to see if the filter has an air flow arrow (A) Fig 9D. If so, point the arrow inward. If the filter does not have an air flow arrow, install the filter either way.



**⚠ WARNING**

Compressed air can be dangerous. For operator safety, do not exceed an air pressure of 30 psi. Do not point the air nozzle toward yourself or anyone else. Always wear safety glasses and a dust mask when using compressed air.

3. Replace the filter, turn the unit “ON”, and check the air flow indicator again.
4. If the air flow indicator points to “green”, the inner filter is still useable. If the indicator points to “red”, remove the outer filter, then remove the inner filter (B) Fig. 9C by lifting and pulling out on the bottom of the filter. **DO NOT try to clean the inner filter. It is disposable and must be replaced.**
5. After replacing the inner filter, reinstall the outer filter.

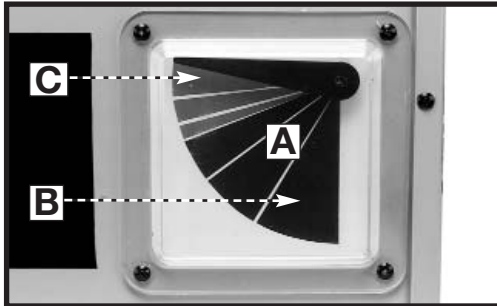

Fig. 9A

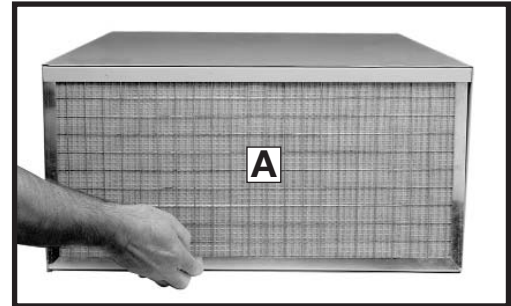

Fig. 9B

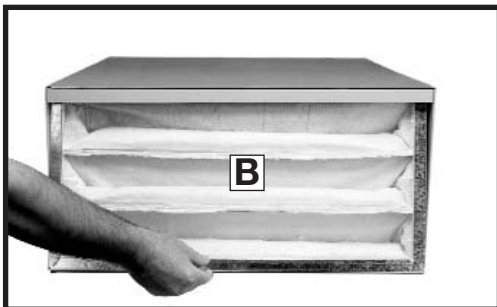

Fig. 9C

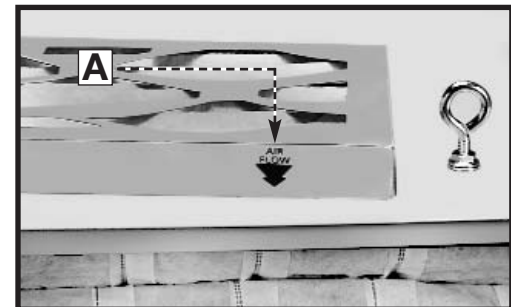

Fig. 9D

## ACCESSORIES

A complete line of accessories is available from your Delta Supplier, Porter-Cable • Delta Factory Service Centers, and Delta Authorized Service Stations. Please visit our Web Site [www.deltamachinery.com](http://www.deltamachinery.com) for a catalog or for the name of your nearest supplier.

**⚠ WARNING** Since accessories other than those offered by Delta have not been tested with this product, use of such accessories could be hazardous. For safest operation, only Delta recommended accessories should be used with this product.



## PARTS, SERVICE OR WARRANTY ASSISTANCE

All Delta Machines and accessories are manufactured to high quality standards and are serviced by a network of Porter-Cable • Delta Factory Service Centers and Delta Authorized Service Stations. To obtain additional information regarding your Delta quality product or to obtain parts, service, warranty assistance, or the location of the nearest service outlet, please call 1-800-223-7278 (In Canada call 1-800-463-3582).



### Two Year Limited New Product Warranty

Delta will repair or replace, at its expense and at its option, any new Delta machine, machine part, or machine accessory which in normal use has proven to be defective in workmanship or material, provided that the customer returns the product prepaid to a Delta factory service center or authorized service station with proof of purchase of the product within two years and provides Delta with reasonable opportunity to verify the alleged defect by inspection. For all refurbished Delta product, the warranty period is 180 days. Delta may require that electric motors be returned prepaid to a motor manufacturer's authorized station for inspection and repair or replacement. Delta will not be responsible for any asserted defect which has resulted from normal wear, misuse, abuse or repair or alteration made or specifically authorized by anyone other than an authorized Delta service facility or representative. Under no circumstances will Delta be liable for incidental or consequential damages resulting from defective products. This warranty is Delta's sole warranty and sets forth the customer's exclusive remedy, with respect to defective products; all other warranties, express or implied, whether of merchantability, fitness for purpose, or otherwise, are expressly disclaimed by Delta.

## PORTER-CABLE • DELTA SERVICE CENTERS (CENTROS DE SERVICIO DE PORTER-CABLE • DELTA)

Parts and Repair Service for Porter-Cable • Delta Machinery are Available at These Locations  
(Obtenga Refaccion de Partes o Servicio para su Herramienta en los Siguientes Centros de Porter-Cable • Delta)

### ARIZONA

Tempe 85282 (Phoenix)  
2400 West Southern Avenue  
Suite 105  
Phone: (602) 437-1200  
Fax: (602) 437-2200

### CALIFORNIA

Ontario 91761 (Los Angeles)  
3949A East Guasti Road  
Phone: (909) 390-5555  
Fax: (909) 390-5554

San Diego 92111  
7638 Clairemnot Blvd.  
Phone: (858) 277-9595  
Fax: (858) 277-9696

San Leandro 94577 (Oakland)  
3039 Teagarden Street  
Phone: (510) 357-9762  
Fax: (510) 357-7939

### COLORADO

Arvada 80003 (Denver)  
8175 Sheridan Blvd., Unit S  
Phone: (303) 487-1809  
Fax: (303) 487-1868

### FLORIDA

Davie 33314 (Miami)  
4343 South State Rd. 7 (441)  
Unit #107  
Phone: (954) 321-6635  
Fax: (954) 321-6638

Tampa 33609  
4538 W. Kennedy Boulevard  
Phone: (813) 877-9585  
Fax: (813) 289-7948

### GEORGIA

Forest Park 30297 (Atlanta)  
5442 Frontage Road,  
Suite 112  
Phone: (404) 608-0006  
Fax: (404) 608-1123

### ILLINOIS

Addison 60101 (Chicago)  
400 South Rohlwing Rd.  
Phone: (630) 424-8805  
Fax: (630) 424-8895

Woodridge 60517 (Chicago)  
2033 West 75th Street  
Phone: (630) 910-9200  
Fax: (630) 910-0360

### MARYLAND

Elkridge 21075 (Baltimore)  
7397-102 Washington Blvd.  
Phone: (410) 799-9394  
Fax: (410) 799-9398

### MASSACHUSETTS

Franklin 02038 (Boston)  
Franklin Industrial Park  
101E Constitution Blvd.  
Phone: (508) 520-8802  
Fax: (508) 528-8089

### MICHIGAN

Madison Heights 48071 (Detroit)  
30475 Stephenson Highway  
Phone: (248) 597-5000  
Fax: (248) 597-5004

### MINNESOTA

Minneapolis 55429  
5522 Lakeland Avenue North  
Phone: (763) 561-9080  
Fax: (763) 561-0653

### MISSOURI

North Kansas City 64116  
1141 Swift Avenue  
Phone: (816) 221-2070  
Fax: (816) 221-2897

St. Louis 63119  
7574 Watson Road  
Phone: (314) 968-8950  
Fax: (314) 968-2790

### NEW YORK

Flushing 11365-1595 (N.Y.C.)  
175-25 Horace Harding Expwy.  
Phone: (718) 225-2040  
Fax: (718) 423-9619

### NORTH CAROLINA

Charlotte 28270  
9129 Monroe Road, Suite 115  
Phone: (704) 841-1176  
Fax: (704) 708-4625

### OHIO

Columbus 43214  
4560 Indianola Avenue  
Phone: (614) 263-0929  
Fax: (614) 263-1238

Cleveland 44125  
8001 Sweet Valley Drive  
Unit #19  
Phone: (216) 447-9030  
Fax: (216) 447-3097

### OREGON

Portland 97230  
4916 NE 122 nd Ave.  
Phone: (503) 252-0107  
Fax: (503) 252-2123

### PENNSYLVANIA

Willow Grove 19090  
(Philadelphia)  
520 North York Road  
Phone: (215) 658-1430  
Fax: (215) 658-1433

### TEXAS

Carrollton 75006 (Dallas)  
1300 Interstate 35 N, Suite 112  
Phone: (972) 446-2996  
Fax: (972) 446-8157

Houston 77043  
4321 Sam Houston Parkway,  
West  
Suite 180  
Phone: (713) 983-9910  
Fax: (713) 983-6645

### WASHINGTON

Auburn 98001 (Seattle)  
3320 West Valley HWY, North  
Building D, Suite 111  
Phone: (253) 333-8353  
Fax: (253) 333-9613

Authorized Service Stations are located in many large cities. Telephone **800-438-2486** or **731-541-6042** for assistance locating one. Parts and accessories for Porter-Cable-Delta products should be obtained by contacting any Porter-Cable-Delta Distributor, Authorized Service Center, or Porter-Cable-Delta Factory Service Center. If you do not have access to any of these, call **800-223-7278** and you will be directed to the nearest Porter-Cable-Delta Factory Service Center. Las Estaciones de Servicio Autorizadas están ubicadas en muchas grandes ciudades. Llame al **800-438-2486** ó al **731-541-6042** para obtener asistencia de fin de localizar una. Las piezas y los accesorios para los productos Porter-Cable-Delta deben obtenerse poniéndose en contacto con cualquier distribuidor Porter-Cable-Delta, Centro de Servicio Autorizado o Centro de Servicio de Fábrica Porter-Cable-Delta. Si no tiene acceso a ninguna de estas opciones, llame al **800-223-7278** y le dirigirán al Centro de Servicio de Fábrica Porter-Cable-Delta más cercano.

## CANADIAN PORTER-CABLE • DELTA SERVICE CENTERS

### ALBERTA

Bay 6, 2520-23rd St. N.E.  
Calgary, Alberta  
T2E 8L2  
Phone: (403) 735-6166  
Fax: (403) 735-6144

### BRITISH COLUMBIA

8520 Baxter Place  
Burnaby, B.C.  
V5A 4T8  
Phone: (604) 420-0102  
Fax: (604) 420-3522

### MANITOBA

1699 Dublin Avenue  
Winnipeg, Manitoba  
R3H 0H2  
Phone: (204) 633-9259  
Fax: (204) 632-1976

### ONTARIO

505 Southgate Drive  
Guelph, Ontario  
N1H 6M7  
Phone: (519) 767-4132  
Fax: (519) 767-4131

### QUÉBEC

1515 ave.  
St-Jean Baptiste, Suite 160  
Québec, Québec  
G2E 5E2  
Phone: (418) 877-7112  
Fax: (418) 877-7123

1447, Begin  
St-Laurent, (Montréal),  
Québec  
H4R 1V8  
Phone: (514) 336-8772  
Fax: (514) 336-3505

The following are trademarks of PORTER-CABLE • DELTA (Las siguientes son marcas registradas de PORTER-CABLE • DELTA S.A.) (Les marques suivantes sont des marques de fabricant de la PORTER-CABLE • DELTA): Auto-Set®, BAMMER®, B.O.S.S.®, Builder's Saw®, Contractor's Saw®, Contractor's Saw II™, Delta®, DELTACRAFT®, DELTAGRAM™, Delta Series 2000™, DURATRONIC™, Emc<sup>2</sup>™, FLEX®, Flying Chips™, FRAME SAW®, Grip Vac™, Homecraft®, INNOVATION THAT WORKS®, Jet-Lock®, JETSTREAM®, 'kickstand®, LASERLOC®, MICRO-SET®, Micro-Set®, MIDI LATHE®, MORTEN™, NETWORK™, OMNIJIG®, POCKET CUTTER®, PORTA-BAND®, PORTA-PLANE®, PORTER-CABLE®&(design), PORTER-CABLE®PROFESSIONAL POWER TOOLS, PORTER-CABLE REDEFINING PERFORMANCE™, Posi-Matic®, Q-3®&(design), QUICKSAND®&(design), QUICKSET™, QUICKSET II®, QUICKSET PLUS™, RIPTIDE™&(design), SAFE GUARD II®, SAFE-LOC®, Sanding Center®, SANDTRAP®&(design), SAW BOSS®, Sawbuck™, Sidekick®, SPEED-BLOC®, SPEEDMATIC®, SPEEDTRONIC®, STAIR EASE®, The American Woodshop®&(design), The Lumber Company®&(design), THE PROFESSIONAL EDGE®, THE PROFESSIONAL SELECT®, THIN-LINE™, TIGER®, TIGER CUB®, TIGER SAW®, TORQBUSTER®, TORQ-BUSTER®, TRU-MATCH™, TWIN-LITE®, UNIGUARD®, Unifence®, UNIFEEDER™, Unihead®, Uniplane™, Unirip®, Unisaw®, Univise®, Versa-Feeder®, VERSA-PLANE®, WHISPER SERIES®, WOODWORKER'S CHOICE™.

Trademarks noted with ™ and ® are registered in the United States Patent and Trademark Office and may also be registered in other countries. Las Marcas Registradas con el signo de ™ y ® son registradas por la Oficina de Registros y Patentes de los Estados Unidos y también pueden estar registradas en otros países.

Printed in U.S.A. PC-0104-149

## Free Manuals Download Website

<http://myh66.com>

<http://usermanuals.us>

<http://www.somanuals.com>

<http://www.4manuals.cc>

<http://www.manual-lib.com>

<http://www.404manual.com>

<http://www.luxmanual.com>

<http://aubethermostatmanual.com>

Golf course search by state

<http://golfingnear.com>

Email search by domain

<http://emailbydomain.com>

Auto manuals search

<http://auto.somanuals.com>

TV manuals search

<http://tv.somanuals.com>