

Definitive Technology[®]

The Leader in High-Performance Loudspeakers[®]

Mythos ST

Mythos ST SuperTower[®] Loudspeaker with Built-In Powered Subwoofer

Owner's Manual

Congratulations

Congratulations on your purchase of the Definitive Technology Mythos ST SuperTower Loudspeaker System. The Mythos ST are very unique speakers which include a built-in powered subwoofer system complete with a high-power digital amplifier. These extraordinary speakers truly revolutionize the state-of-the-art in music and home theater loudspeakers.

Our engineers have spent many years in developing this product. In order to ensure that you experience the finest performance possible, we encourage you to take a moment to fully read this owner's manual and familiarize yourself with the proper installation and set-up procedures for your Mythos ST speakers.

Safety Precautions



CAUTION! To reduce the risk of electric shock and fire, do not remove the cover or back plate of this device. There are no user serviceable parts inside. Please refer all servicing to licensed service technicians.
Avis: Risque de choc électrique, ne pas ouvrir.

CAUTION! The international symbol of a lightning bolt inside a triangle is intended to alert the user to uninsulated “dangerous voltage” within the device’s enclosure. The international symbol of an exclamation point inside a triangle is intended to alert the user to the presence of important operating, maintenance and servicing information in the manual accompanying the device.

CAUTION! To prevent electrical shock, match wide blade of plug to wide slot, fully insert. Attention: Pour éviter les chocs électriques, introduire la lame la plus large de la fiche dans la borne correspondante de la prise et pousser jusqu’au fond.

CAUTION! To reduce the risk of electrical shock, do not expose this equipment to rain or moisture.

1. Read Instructions—All safety and operating instructions should be read before operating the device.
2. Retain Instructions—The safety and operating instructions should be retained for future reference.
3. Heed Warnings—All warnings on the device and in the operating instructions should be adhered to.
4. Follow Instructions—All operating and safety instructions should be followed.
5. Water & Moisture—The device should never be used in, on or near water for risk of fatal shock.
6. Carts & Stands—The device should only be used on carts or stands recommended by the manufacturer.
7. Wall & Ceiling Mounting—The device should be mounted on a wall or ceiling only as recommended by the manufacturer.
8. Ventilation—The device should always be located in such a way that it maintains proper ventilation. It should never be placed in a built-in installation or anywhere that may impede the flow of air through its heat sink.
9. Heat—Never locate the device near heat sources such as radiators, floor registers, stoves or other heat-generating devices.
10. Power Supply—The device should only be connected to a power supply of the type described in the operating instructions or as marked on the device.
11. Power Cord Protection—Power cables should be routed so they are not likely to be stepped on or crushed by items placed on them or against them. Special attention should be paid to areas where the plug enters a socket or fused strip and where the cord exits the device.
12. Cleaning—The device should be cleaned in accordance with manufacturer’s instructions.
13. Periods Of Non-Use—The device should be unplugged when not being used for extended periods.
14. Dangerous Entry—Care should be taken that no foreign objects or liquids fall or are spilled inside the device.
15. Damage Requiring Service—The device should be serviced by licensed technicians when:
 - The plug or power supply cord has been damaged.
 - Objects have fallen or liquid has spilled inside the device.
 - The device has been exposed to moisture.
 - The device does not appear to be operating properly or exhibits a marked change in performance.
 - The device has been dropped or the cabinet becomes damaged.
16. Service—The device should always be serviced by licensed technicians. Only replacement parts specified by the manufacturer should be used. The use of unauthorized substitutions may result in fire, shock, or other hazards.

Safety Precautions Specific to Mythos ST

The cautionary marking label is located on the bottom of the speaker, visible through an opening in the granite base.

Power Supply

1. The fuse and power disconnect device are located on the bottom of the speaker, accessible through a hole in the granite base.
2. The disconnect device is the power cord, detachable at either the speaker or the wall.
3. The power cord must be disconnected from the speaker before servicing.

Unpacking Your Mythos STs

Please Inspect For Shipping Damage

Each loudspeaker leaves our plant in perfect condition. Any visible or concealed damage most likely occurred in handling after it left our plant and should be reported at once to your Definitive dealer or the delivery company that delivered your loudspeaker. Please unpack your system carefully. Save all cartons and packing materials in case you move or need to ship your system. Record the serial number found on the back of the Mythos ST in the appropriate place on your warranty card, answer all questions and send it in.

Base Installation Instructions

Tools required: 4mm (or $\frac{5}{32}$ ") Allen Wrench (also called Hex Key driver)

Parts required: Polished Granite Base, Cable Clip for AC Cord,
four allen head bolts, eights plastic washers

Instructions:

1. Carefully lay the Mythos ST on its side. Lift the base of the speaker about six inches and support it with a soft padded object, such as a pillow. Do NOT support the speaker with a hard object, as you might dent or scratch the aluminum finish.
2. Place one plastic washer on each bolt.
3. Insert the bolts into the granite base from the same side that the black feet are attached to.
4. Place another plastic washer on each bolt so the washer is against the granite.
5. Finger tighten all four bolts into the threaded holes on the bottom of the Mythos. If this has been done correctly, washers will be between the metal surface of the Mythos ST, the granite, and the heads of the bolts.
6. GENTLY tighten each bolt with the allen head wrench. Do NOT overtighten or you may crack the granite.

7. Attach the AC cord through the hole at the bottom of the granite base.
8. Note the label showing the height adjustment ring and locking collar on the black feet. Carefully return the speaker to the upright position and adjust the feet to level the speaker.

Installing Cable Clip for AC Cord

The cable clip supplied in the accessories bag is a simple easy to use clip, designed to hold the power cable in place and prevent accidental removal from inlet socket. To use, simply peel backing and apply to bottom of granite base. Suggested location for clip on the bottom of the granite base is half-way between center opening and back of base, slightly off to one side of the rear foot, as shown in diagrams below. Clip should be oriented so that the axis of the cable slot runs between the opening and outside of the base. After plugging supplied power cable into the inlet socket, it may then be pressed into the opening in the cable clip to secure it in place.

SELF-ADHESIVE POWER CABLE
RESTRAINING CLIP FOR MYTHOS ST

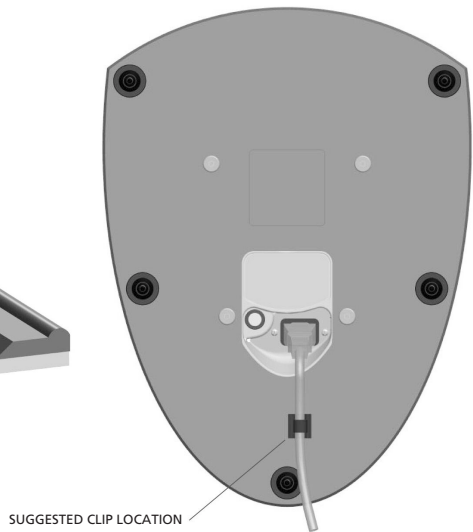
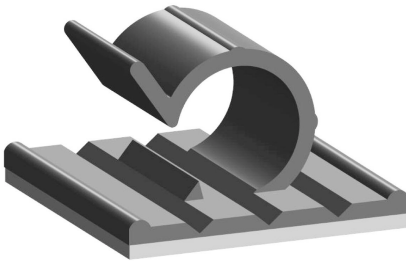

Positioning the Mythos Speakers in Your Room

Your new Mythos speakers are very flexible in terms of positioning and placement options and they will produce excellent sound in almost any location. Following a few simple guidelines can, however, optimize their performance for the more critical listener. Please remember that although the following recommendations are usually valid, all rooms and listening sets-ups are somewhat unique, so do not be afraid to experiment with the speakers. Remember, whatever sounds best to you is correct.

Positioning Mythos ST as Left/Right Main Speakers

When used as left and right front speakers, the Mythos ST can be placed right next to your TV with excellent results or may be separated by a greater distance than the width of the TV. As with any speaker, a greater separation (5 to 7 feet or more) will normally result in a bigger soundstage and this is recommended from

Download from www.Somanuals.com. All Manuals Search And Download.

a sonic point of view. Speakers may be angled in toward the listening position or left parallel with each other. Angling the speakers in (pointed directly at the listener) will result in a somewhat brighter, clearer sound with a sharper focus and a more solid central image (generally, we recommend this), while leaving the speakers parallel with each other will result in a less bright, warmer sound.

Positioning Mythos ST as Rear/Side Surrounds

When used as rear or side surround speakers, Mythos ST may be located on the side or behind the listeners. When used on the sides, take care never to locate the speakers forward of the listeners. If the speakers are placed on the rear wall, it is suggested that they be positioned fairly wide apart if possible. (For instance, if there is a couch in the center of the rear wall on which the listeners will sit, try to position the speakers wider apart than the couch.)

"Spiking" Your Loudspeakers

An optional "spiking" kit has been provided should you desire to "spike" your loudspeakers. "Spiking" your loudspeakers will provide much greater stability when placing your loudspeakers on carpeting. It will also, according to many experts, result in an overall improvement in sonic performance. Care should be taken when using spikes as they may cause damage to wooden or other floors which are susceptible to being scratched. Definitive Technology is specifically not responsible for damage which may result from the use of spikes.

The spike kit contains five spikes. To install, unscrew the non-marking tips from the centers of the five leveling feet and screw the five spikes in their places. Then, with the help of another person, lift the speaker upright and lower it to

Speaker Break-In

Your Mythos STs should sound good right out of the box; however, an extended break-in period of 40-60 hours or more of normal playing is required to reach full performance capability. Break-in allows the suspensions to work in and results in fuller bass, a more open "blossoming" midrange and smoother high frequency reproduction.

Connecting Your Loudspeakers

Your Mythos STs have a set of speaker level (high level) 5-way binding posts and in addition, each speaker has an LFE input. This input can be used with Dolby Digital* and DTS* 5.1 (6.1, 7.1) decoders to separately feed the discrete "Low Frequency Effects" channel into each subwoofer (which then combines with the low bass present separately in the left or right channel signals). Unlike a conventional system, where the subwoofer is driven only by an LFE subwoofer signal, the Mythos STs are much more sophisticated and are driven by the left or

If the Mythos STs are your main set of speakers, you will hook up the left main/front channel red(+) terminal of your receiver or amplifier to the red(+) terminal of your left loudspeaker and the left main/front channel black(-) terminal of your receiver or amplifier to the black(-) terminal of your left loudspeaker. Connect the right channel main/front channel red(+) terminal of your amplifier or receiver to the red(+) terminal of your right loudspeaker and the black(-) terminal of the right main/front channel of your receiver or amplifier to the black(-) terminal of your right loudspeaker. It is essential that both speakers be connected in the same way (in phase) to its own channel of the amplifier. If you experience a great lack of bass, it is likely that one speaker is out of phase with the other.

If you are using the Mythos ST as side/rear surround speakers, hook up the left surround red(+) terminal of your receiver or amplifier to the red(+) terminal of your left surround speaker and the left surround black(-) terminal of your receiver or amplifier to the black(-) terminal of your left surround speaker. Connect the right surround red(+) terminal of your amplifier or receiver to the red(+) terminal of your right surround loudspeaker and the black(-) terminal of the right surround channel of your receiver or amplifier to the black(-) terminal of your right surround loudspeaker.

Hooking Up With Speaker Wire Only

The simplest implementation of use with DTS or Dolby Digital is to simply hook-up your Mythos ST with speaker wire as described above and set your receiver or processor's menu to "Large" left and right main speakers and "no" subwoofer. The bass management system will then send the LFE .1 channel into the left and right channels and it will be reproduced by the subwoofers in your Mythos STs giving you all the benefits of the discrete LFE signal. The speakers have a special circuit that takes an infinitesimally small signal from the speaker level input and converts it to a low-level signal which then drives the subwoofer power amp.

Using the LFE Input on Your Mythos STs

With Dolby Digital or DTS, you have the option to use the low level LFE input in addition to the speaker wires. To do this, simply use a "Y" connector (available from your dealer) out of the LFE output on your receiver or processor to feed two line level cables, connecting one to the LFE input on your left Mythos ST and the other to the LFE input on your right speaker. "Tell" your bass management system that you have "large" left and right front speakers and "Yes" subwoofer.

Using Multi-Channel SACD or DVD-Audio with your Mythos STs

Because of the nature of their bass management systems, a multi-channel SACD player or DVD-Audio player (or any other format that requires using 6-channel interconnects) requires the use of an LFE connection between your receiver or processor and your Mythos ST. If you are using one of these players, please use the connection method outlined in the "Using the LFE Input" section.

Usually if distortion is heard when the speakers are being driven at loud levels, it is caused by driving (turning up) the amplifier too loud and not driving the speakers with more power than they can handle. Remember, most amplifiers put out their full-rated power well before the volume control is turned all the way up! If your speakers distort when you play them loud, turn down the amplifier or get a bigger one.

Setting Bass and Treble Controls on Your Receiver or Amplifier

Normally we recommend that you set the “Bass” and “Treble” controls on flat or 0 dB. This will give you the most linear and natural sound. If you want more bass, raise the subwoofer’s “Level” control on your Mythos ST, keeping in mind that even a little turn of the knob can make a big difference in the sound. Also, if your amplifier or receiver has a graphic equalizer, we recommend that you leave it flat. The reason for this is that we have spoken with many consumers about what they thought were improperly sounding speakers when, in fact the problem was misadjusted tone controls. When in doubt, leave them flat; this almost always sounds the best.

Powering Up the Active Subwoofer Section

Your Mythos STs contain a built-in, active powered subwoofer section as well as an electronic crossover and so each Mythos ST must be plugged into an electrical socket of the appropriate voltage (as indicated on the back of your unit) using the plug on the end of the electrical cord which you have attached to the speaker through the hole at the bottom of the base. The Mythos ST has a special circuit which automatically turns the powered subwoofer section on when a signal is fed to the loudspeaker and does not require an on-off switch. Please note that if you hear a pop from the speaker when the amp powers up, this is normal. The LED on the back panel will light up when a signal is sensed and the amplifier turns on. Please note that after the cessation of a signal, it may take up to an hour for the amplifier to actually turn off. In some instances, because of RF presence in your area, the LEDs may not turn off. However, this is nothing to be concerned about as the amplifiers draw almost no power when they are idling.

To prevent accidental damage to the subwoofers built into your Mythos STs from overdriving the system, the subwoofers feature an internal overload protection circuit, which will turn the subwoofers off or down when overdriven or overheated and will then resume normal operation after a few minutes.

Setting Your Speakers' Low-Frequency Level Control

Your Mythos STs have a level control which allows you to perfectly tune the output level of the powered low frequency subwoofer section to match your room as well as to fulfill your own personal listening preferences. Please note that there are no controls to vary the crossover points or phase because these have been factory calibrated and set to provide perfect blending (a major performance benefit of this innovative product). We suggest beginning with the level control set at approximately 1 o'clock.

VERY IMPORTANT: Setting Channel Balance and Bass Management Systems

Dolby Digital and DTS 5.1 (6.1, 7.1) systems and decoders have a critical channel balancing procedure for the left and right front speakers, center channel, rears and subwoofer (if it is hooked up through the "LFE or Sub Out" low-level connection) which must be followed if the system is to perform properly. We have spoken with many system users with problems relating to the overall sound of their system which could be clearly traced back to improper system balance. In fact, many users never realize that there is a system balance procedure to be followed.

Also note that Dolby Digital and DTS 5.1 (6.1, 7.1) systems and decoders have bass management systems (systems which direct the bass to the various channels) which vary from unit to unit. This bass management system must also be properly adjusted. We have spoken with many system users with problems relating to the overall sound of their system which could be clearly traced back to improper bass management. In fact, many users never realize that there is a bass management procedure to be followed.

Your receiver or decoder's bass management system should be set for "Large" left and right main speakers and "Yes" subwoofer. If you have a Definitive center channel with a built-in powered subwoofer, set your decoder's bass management center channel setting to "Large" (although you should experiment with this to see what sounds best in your specific system). If you are using large rear surround speakers with very extended low frequency response such as a large Definitive floor-standing system or one with a built-in powered subwoofer, set the rear channels of your decoder's bass management system to "Large." If not, set them to "Small."

Setting Low-Frequency Balance When Using Separate LFE Input

We suggest that when you are using a separate LFE input, you set the bass level on your Mythos STs to sound balanced when listening to music in stereo and use the .1 channel or bass level control in your Dolby Digital channel balancing

procedure on your decoder to raise or lower the bass level for movie sound effects as you require.

Normally the level control of the left speaker will be set the same as the level control of the right speaker. However, these controls can also be set differently on the two speakers in order to allow you to vary the response of left and right speakers separately to compensate for variations and asymmetrical positioning of the left and right speakers in your room (i.e., when one is closer to a side wall or corner, etc.) if this is how you must set them up. This is a very unique and useful feature which allows you much greater flexibility in loudspeaker placement, as well as the ability to optimize what could otherwise be difficult placement situations.

Using your Mythos ST with an Additional Subwoofer

Although the built-in subwoofers in your Mythos STs deliver superb low frequency response and are all that are required for amazing performance, some listeners go for the ultimate performance and add an additional powered subwoofer to their system. If you choose to do so, we strongly suggest using a Definitive SuperCube in order to achieve the highest level of sound quality possible. This should be driven with an additional RCA low-level cable connected to the LFE output of your receiver or processor. Your receiver or decoder's bass management system should still be set to "Large" left and right main speakers and "Yes" subwoofer.

Complete Home Theater Systems

We strongly suggest that you use matching Definitive center channel and rear/surround speakers to complete your Definitive home theater system. Please note that you can use Definitive Mythos ST SuperTowers as rear or side surround speakers with excellent results for both music and movies.

Troubleshooting

If you experience any difficulties with your Mythos STs, try the suggestions described below. If you are still having problems, please consult your Definitive Technology Authorized Dealer for assistance.

1. Make sure all your system interconnects and power cords are solidly in place.
2. Should you experience any level of ground hum or noise, try plugging the power cord into the same circuit as your amplifier.
3. The system is provided with sophisticated internal protection circuitry. If for some reason the protection circuitry is tripped, please turn down your system's volume and wait five minutes before trying the system again. If the amplifier should overheat, the system will turn off until the amplifier cools down and resets.
4. Check to be sure that your power cord has not been damaged.

5. Check that no foreign objects or liquid has entered the cabinet.
6. If you cannot get the subwoofer driver on the side of the speaker to turn on or if no sound comes out and you are sure the system is set up properly, please bring the loudspeaker to your Definitive Technology Authorized Dealer for assistance. Call First.

Service

Service and warranty work on your Definitive loudspeakers will normally be performed by your local Definitive Technology dealer. If, however, you wish to return the speaker to us, please contact us first, describing the problem and requesting authorization as well as the location of the nearest factory service center. **Please note that the address given in this booklet is the address of our offices only. Under no circumstances should loudspeakers be shipped to our offices or returned without contacting us first and obtaining return authorization.**

Definitive Technology Offices
11433 Cronridge Drive,
Owings Mills, Maryland 21117
Phone: 410-363-7148

Technical Assistance

It is our pleasure to offer assistance if you have any questions regarding your Mythos STs or their set-up. Please contact your nearest Definitive Technology dealer or contact us directly at 410-363-7148.

Specifications

Mythos ST

Dimensions:

6³/₄" W x 9¹/₂" D x 51¹/₂" H

Frequency Response:

14 Hz – 30 kHz

Efficiency:

93 dB

Nominal Impedance:

4 – 8 ohms

Driver Complement:

Two 5¹/₄" high definition cast-magnesium basket polymer upper midrange drivers. One 1" pure aluminum dome tweeter. One 6" x 10" long-throw racetrack subwoofer coupled to two 6" x 10" long-throw racetrack radiators.
20 – 350 watt/channel

Rec. Assoc. Amplification:

Built-In Subwoofer

Power Amplifier:

300 watt Digitally-Coupled Class D amplifier

Fuse Size:

3.25-amp 250-volt slow-blow fuse for 110-volt version and
2-amp 250-volt slow-blow fuse for the 240-volt version

Specifications subject to change without notice.

Visit us at www.definitivetech.com.

Limited Warranty: 5-Years for Drivers and Cabinets, 3-Years for Electronic Components

Definitive Technology warrants to the original retail purchaser only that this Definitive Technology Loudspeaker Product (the "Product") will be free from defects in materials and workmanship for a period of five (5) years covering the drivers and cabinets, and three (3) years for the electronic components from the date of the original purchase from a Definitive Technology Authorized Dealer. However, this warranty will automatically terminate prior to the expiration of five (5) years for the drivers and cabinets and three (3) years for the electronic components if the original retail purchaser sells or otherwise transfers the Product to any other party. The original retail purchaser shall hereinafter be referred to as "you." Defective Products must be shipped, together with proof of date of purchase, prepaid insured to the Authorized Dealer from whom you purchased the Product, or to the nearest factory service center. Product(s) must be shipped in the original shipping container or its equivalent; in any case the risk of loss or damage in transit is to be borne by you. If, upon examination at the Factory or a Definitive Technology Authorized Dealer, it is determined that the unit was defective in materials or workmanship at any time during this Warranty period, Definitive Technology or the Definitive Technology Authorized Dealer will, at its option, repair or replace this Product at no additional charge, except as set forth below. All replaced parts and Product(s) become the property of Definitive Technology. Product(s) replaced or repaired under this Warranty will be returned to you, within a reasonable time, freight collect.

This Warranty does not include service or parts to repair damage caused by accident, misuse, abuse, negligence, inadequate packing or shipping procedures, commercial use, voltage in excess of the rated maximum of the unit, cosmetic appearance of cabinetry not directly attributable to defects in materials or workmanship, or service, or repair or modification of the Product which has not been authorized by Definitive Technology. Definitive Technology makes no Warranty with respect to its Products purchased from dealers or outlets other than Definitive Technology Authorized Dealers. This Warranty is in lieu of all other expressed Warranties. If this Product is defective in material or workmanship as warranted above, your sole remedy shall be repair or replacement as provided above. In no event will Definitive Technology be liable to you for any incidental or consequential damages arising out of the use or inability to use the Product, even if Definitive Technology or a Definitive Technology Authorized Dealer has been advised of the possibility of such damages, or for any claim by any other party. Some states do not allow the exclusion or limitation of consequential damages, so the above limitation may not apply to you.

All implied warranties on the Product are limited to the duration of this expressed Warranty. Some states do not allow limitation on how long an implied Warranty lasts, so the above limitations may not apply to you. This Warranty gives you specific legal rights, and you also may have other rights which vary from state to state.



**This product complies with the essential
requirements of the EMC directive 89/336/EEC.**

Free Manuals Download Website

<http://myh66.com>

<http://usermanuals.us>

<http://www.somanuals.com>

<http://www.4manuals.cc>

<http://www.manual-lib.com>

<http://www.404manual.com>

<http://www.luxmanual.com>

<http://aubethermostatmanual.com>

Golf course search by state

<http://golfingnear.com>

Email search by domain

<http://emailbydomain.com>

Auto manuals search

<http://auto.somanuals.com>

TV manuals search

<http://tv.somanuals.com>