

Brookstone®

iDESIGN®

Retro Clock

App-driven dock for iPod®
& iPhone® devices



Made for



iPod



iPhone

TABLE OF CONTENTS

Cautions and Warnings	2
Locations of Parts and Controls	6
Included Accessories	7
Set-Up and Operation	8
Compatible iPod and iPhone Models	8
Using the App	9
Using Line-In	10
Specifications	11
Troubleshooting	12
Warranty	13

CAUTION

- TO REDUCE THE RISK OF ELECTRIC SHOCK, DO NOT REMOVE COVER. THERE ARE NO SERVICEABLE PARTS INSIDE.
- TO REDUCE THE RISK OF FIRE OR ELECTRIC SHOCK, DO NOT EXPOSE THIS UNIT TO RAIN OR MOISTURE.



The lightning flash with arrow-head symbol within an equilateral triangle is intended to alert the user to the presence of uninsulated “dangerous voltage” within the unit's enclosure that may be of sufficient magnitude to constitute a risk of electric shock.



The exclamation point within an equilateral triangle is intended to alert the user to the presence of important operating and maintenance (servicing) instructions in the literature accompanying the unit.

IMPORTANT SAFETY INSTRUCTIONS

All the safety and operating instructions should be read, adhered to and followed before the unit is operated.

SAVE THESE INSTRUCTIONS

IMPORTANT SAFETY INSTRUCTIONS

All the safety and operating instructions should be read, adhered to and followed before the unit is operated.

1. Read these instructions.
2. Keep these instructions.
3. Heed all warnings.
4. Follow all instructions.
5. Do not use this unit near water.
6. Clean only with a dry cloth.
7. Do not block any ventilation openings. Install in accordance with the manufacturer's instructions.
8. Do not install near any heat sources such as radiators, heat registers, stoves, or other unit (including amplifiers) that produce heat.
9. Do not defeat the safety purpose of the polarized or grounding-type plug. A polarized plug has two blades, with one wider than the other. A grounding-type plug has two blades and a third grounding prong. The wide blade or the third prong are provided for your safety. If the provided plug does not fit into your outlet, consult an electrician for replacement of the obsolete outlet.
10. Protect the power cord from being walked on or pinched, particularly at plugs, convenience receptacles, and the point where it exits from the unit.
11. Only use attachments/accessories specified by the manufacturer.

12. Unplug this unit during lightning storms or when unused for long periods of time.
13. Refer all servicing to qualified service personnel. Servicing is required when the unit has been damaged in any way, including if the power-supply cord or plug is damaged, liquid has been spilled or objects have fallen into the unit, the unit has been exposed to rain or moisture, does not operate normally, or has been dropped.

Note:

1. The unit shall not be exposed to dripping or splashing liquids.
2. Main plug is used as disconnect device and it should remain readily operable during intended use. In order to disconnect the unit from the power completely, the main plug should be disconnected from the main socket outlet completely.

WARNING

1. Keep away from children. This is not a toy.
2. Use this unit only for its intended use as described in this manual.
3. Unplug this unit during lightning storms or when unused for long periods of time.
4. Never drop or insert an object into any opening.
5. Protect the power cord from being walked on or pinched, particularly at plug outlets, convenience receptacles and the point where it exits the unit.

FCC INFORMATION

This equipment has been tested and found to comply with the limits for a Class B Digital Device, pursuant to Part 15 of the FCC Rules. These limits are designed to provide reasonable protection against harmful interference in a residential installation. This equipment generates, uses, and can radiate radio frequency energy and, if not installed and used in accordance with the instructions, may cause harmful interference to radio communications. However, there is no guarantee that interference will not occur in a particular installation.

If this equipment does cause harmful interference to radio or television reception, which can be determined by turning the equipment off and on, the user is encouraged to try to correct the interference by one or more of the following measures:

- Reorient or relocate the receiving antenna.
- Increase the distance between the equipment and receiver.
- Connect the equipment to an outlet on a circuit different from that to which the receiver is connected.
- Consult the dealer or an experienced radio/TV technician for help.

This equipment complies with Part 15 of the FCC Rules. Operation is subject to the following two conditions:

1. This equipment may not cause harmful interference.
2. This equipment must accept any interference received, including interference that may cause undesired operation.

Modifications not authorized by the manufacturer may void the user's authority to operate this device.

LOCATION OF PARTS AND CONTROLS

1. Clip Dock
2. 30-Pin Connector
3. Speakers (2)
4. Snooze Button
5. Volume -/+

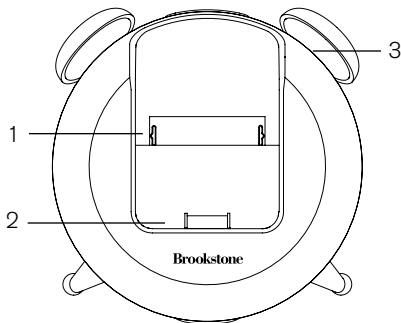

Front view

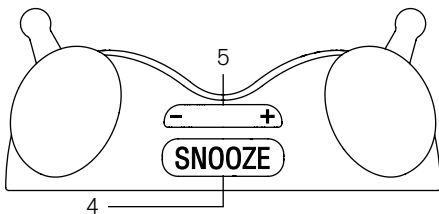

Top view

LOCATION OF PARTS AND CONTROLS

1. Line-in Jack
2. DC 5V Jack

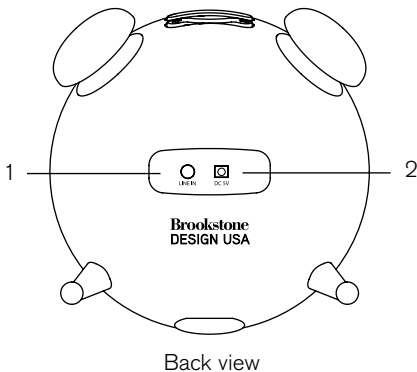

INCLUDED ACCESSORIES

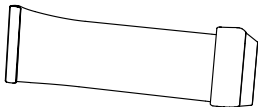

6 iPod/iPhone Clips

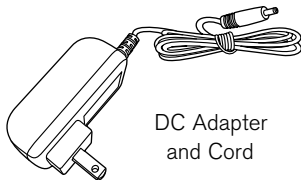

DC Adapter
and Cord

SET-UP AND OPERATION

AC POWER

Connect the DC Adapter to a power outlet and the DC IN on the Retro Clock.

CONNECTING YOUR iPod/iPhone TO THE RETRO CLOCK

Select the correct iPod/iPhone CLIP for your iPod/iPhone and slide it securely into the docking area on the front of the unit (see the example to the right).

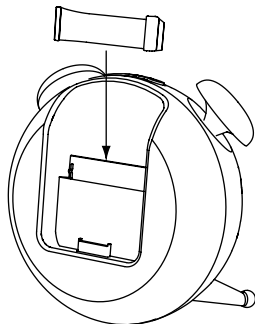

Slide the CLIP down onto the CLIP DOCK.

Slide your iPod/iPhone down through the CLIP and securely on the 30-PIN CONNECTOR.

PLAYING YOUR iPod/iPhone

1. Dock your iPod/iPhone.
2. Adjust the volume using the + or – buttons.

COMPATIBLE iPod/iPhone MODELS

iPod touch
(1st, 2nd and 3rd generation)

iPod nano
(4th and 5th generation)

iPhone 3GS

iPhone 3G

iPod classic

iPhone 4

iPhone

USING THE APP (free download from App StoreSM)

The app includes alarm clock, weather forecast and more.

When you dock your iPod/iPhone in the unit, a pop-up asking if you'd like to download the free iDesign[®] Retro Alarm Clock app will appear.

You may also go directly to the iTunes[®] App StoreSM to download the iDesign[®] Retro Alarm Clock app.

Note: For all compatible iPod/iPhone devices the OS must be 3.1.2 or later to work with the app.



APP TIPS

SCREENS

Swipe Left/Right to go to:

- Home
- Photo
- Date
- Alarm
- Weather
- World Time
- Music

Double tap on screen to activate a split screen.

Swipe left/right to change screens.

Double tap to return to full screen.

Horizontal orientation will automatically show a split screen.

Touch **i** to access Wall Paper settings.

Touch  to customize screen

ALARM

In the vertical orientation of any screen, touch  to access Alarms.

Or, swipe left/right to go to the Alarm screen.

Touch Alarm to activate and deactivate.

WORLD TIME

Swipe up/down on the cities list to view additional cities on the World Time screen.

MUSIC

Touch Playlist to access your music. Touch Songs to create a custom playlist or choose a current playlist and Add All Songs.

HORIZONTAL ORIENTATION

Some screens are view only in the horizontal orientation. For full-feature function, use the vertical orientation.

USING LINE-IN

1. Insert one end of a 3.5mm CABLE (not included) into your audio source and the other end into LINE IN jack on the back of the Retro Clock.
2. Adjust the volume using the + or – buttons.

SPECIFICATIONS

Output:	Total 6W output (3W x 2)
Range:	2" full range drivers, 34mm
Distortion:	$\leq 10\%$
S/N ratio:	$> 75\text{dB @ } 0.5\text{W}$
Sensitivity.....	350mV +/- 2mV
Frequency Response:	200Hz – 15kHz
Power Adapter:	DC 5V 2.5A
Dimensions	6" h x 6" w x 3" d
Weight	12.6 oz.
App Data Usage.....	Approx. 8.6MB per month

iPod/iPhone not included. iPod and iPhone are trademarks of Apple Inc., registered in the U.S. and other countries. "Made for iPod" and "Made for iPhone" mean that an electronic accessory has been designed to connect specifically to iPod or iPhone, respectively, and has been certified by the developer to meet Apple performance standards. Apple is not responsible for the operation of this device or its compliance with safety and regulatory standards. Please note that the use of this accessory with iPod or iPhone may affect wireless performance. iTunes is a trademark of Apple Inc., registered in the U.S. and other countries. App Store is a service mark of Apple Inc.

TROUBLESHOOTING

PROBLEM	SOLUTION
Sound not clear or no sound.	Check the DC Cable or iPhone/iPod connection.
No power.	Check the DC Cable.
Sound is faint/too much distortion.	Press Volume Buttons to adjust volume. Adjust the volume of audio device attached to the device via the 3.5mm Line-in Cable.
Cannot hear music played from iPhone/iPod.	Make sure the Line-in Cable is unplugged. Increase volume.
Fonts on app using iPod touch (1st generation) and iPhone (1st generation) appear incorrect.	This is a software limitation between the iDesign® Retro app and the iPod touch (1st generation) and iPhone (1st generation).

ONE (1) YEAR LIMITED WARRANTY

Brookstone® warrants this product against defects in materials and/or workmanship under normal use for a period of ONE (1) YEAR from the date of purchase by the original purchaser ("Warranty Period"). If a defect arises and a valid claim is received within the Warranty Period, at its option, Brookstone will either 1) repair the defect at no charge, using new or refurbished replacement parts, or 2) replace the product with a new product that is at least functionally equivalent to the original product, or 3) provide a store credit in the amount of the purchase price of the original product. A replacement product or part, including a user-installable part installed in accordance with instructions provided by Brookstone, assumes the remaining warranty of the original product. When a product or part is exchanged, any replacement item becomes your property and the replaced item becomes Brookstone's property. When a store credit is given, the original product must be returned to Brookstone and becomes Brookstone's property.

Obtaining Service: To obtain warranty service, call Brookstone Limited Warranty Service at 1-800-292-9819. Please be prepared to describe the product that needs service and the nature of the problem. A purchase receipt is required. All repairs and replacements must be authorized in advance. Service options, parts availability and response times will vary. You are responsible for delivery and the cost of delivery of the product or any parts to the authorized service center for replacement, per our instructions.

Limits and Exclusions: Coverage under this Limited Warranty is limited to the United States of America, including the District of Columbia and the U.S. Territories of Guam, Puerto Rico, and the U.S. Virgin Islands. This Limited Warranty applies only to products manufactured for Brookstone that can be identified by the "Brookstone" trademark, trade name, or logo affixed to them or their packaging. The Limited Warranty does not apply to any non-Brookstone products. Manufacturers or suppliers other than Brookstone may provide their own warranties to the purchaser,

but Brookstone, in so far as permitted by law, provides these products "as is." This warranty does not apply to: a) damage caused by failure to follow instructions relating to product's use or the installation of components; b) damage caused by accident, abuse, misuse, fire, floods, earthquake or other external causes; c) damage caused by service performed by anyone who is not a representative of Brookstone; d) accessories used in conjunction with a covered product; e) a product or part that has been modified to alter functionality or capability; f) items intended to be periodically replaced by the purchaser during the normal life of the product including, without limitation, batteries or light bulbs; g) any product sold "as is" including, without limitation, floor demonstration models and refurbished items; or h) a product that is used commercially or for a commercial purpose.

BROOKSTONE SHALL NOT BE LIABLE FOR INCIDENTAL OR CONSEQUENTIAL DAMAGES RESULTING FROM THE USE OF THIS PRODUCT, OR ARISING OUT OF ANY BREACH OF THIS WARRANTY. TO THE EXTENT PERMITTED BY APPLICABLE LAW, BROOKSTONE DISCLAIMS ANY AND ALL STATUTORY OR IMPLIED WARRANTIES, INCLUDING, WITHOUT LIMITATION, WARRANTIES OF MERCHANTABILITY, FITNESS FOR A PARTICULAR PURPOSE AND WARRANTIES AGAINST HIDDEN OR LATENT DEFECTS. IF BROOKSTONE CANNOT LAWFULLY DISCLAIM STATUTORY OR IMPLIED WARRANTIES, THEN TO THE EXTENT PERMITTED BY LAW, ALL SUCH WARRANTIES SHALL BE LIMITED IN DURATION TO THE DURATION OF THIS EXPRESS WARRANTY.

Some states disallow the exclusion or limitation of incidental or consequential damages or how long an implied warranty lasts, so the above exclusions or limitations may not apply to you. This warranty gives you specific legal rights and you may also have other rights, which vary from state to state.

Brookstone®

A WORLD OF INNOVATION

Since 1965, people have come to Brookstone to see what's new, discover smart solutions to everyday problems—and have some fun. At Brookstone, we believe there's always a better way to do things. And we created a world of innovation to prove it.

Merrimack, New Hampshire USA 03054 • 800-846-3000 • www.Brookstone.com

Download from www.Somanuals.com. All Manuals Search And Download. 652727 Red

Free Manuals Download Website

<http://myh66.com>

<http://usermanuals.us>

<http://www.somanuals.com>

<http://www.4manuals.cc>

<http://www.manual-lib.com>

<http://www.404manual.com>

<http://www.luxmanual.com>

<http://aubethermostatmanual.com>

Golf course search by state

<http://golfingnear.com>

Email search by domain

<http://emailbydomain.com>

Auto manuals search

<http://auto.somanuals.com>

TV manuals search

<http://tv.somanuals.com>