

# Blueair ECO10 User Manual

Blueair ECO10



# Contents

3	<a href="#">Welcome</a>	_____
4	<a href="#">Getting started</a>	_____
6	<a href="#">Getting the most from your Blueair system</a>	_____
7	<a href="#">How it works</a>	_____
8	<a href="#">Changing the filters</a>	_____
10	<a href="#">Specifications</a>	_____
11	<a href="#">Limited Warranty</a>	_____

## Customer's record

The model number and serial number of this product can be found on the bottom of this unit. Please note them in the spaces provided and keep for future reference.

Model number \_\_\_\_\_ Dealer's name \_\_\_\_\_

Serial number \_\_\_\_\_ Dealer's address \_\_\_\_\_

Date of purchase \_\_\_\_\_ Telephone number \_\_\_\_\_

# Welcome

Thank you for choosing Blueair. This document gives you some useful tips on how to use the Blueair ECO10 safely and effectively. Before turning on your air purifier, be sure to familiarize yourself with the basic operating and general safety instructions.

## Filter replacement

Be sure to change your Blueair filters according to the recommended filter replacement schedule. This helps keep your Blueair air purifier running in top condition. See page 8.

## Extend your warranty

Complete and send your warranty card to Blueair today to extend your limited warranty from one year to a lifetime.

## Help keep the planet healthy, too

At Blueair, we're in the business of clean air. Our air purifiers are designed for maximum improvement of indoor air, but with minimum impact on the natural world. The entire unit is recyclable, down to its polypropylene filters.



# Getting started

Before you start using your Blueair ECO10 air purifier, take a few minutes to become familiar with the basics.

## General safety instructions

The Blueair ECO10 air purifier is an electrical appliance. Please read these safety instructions before use and take the necessary precautions to reduce the risk of fire, electric shock or injury.

**The Blueair Limited Warranty applies only if the unit is used according to these instructions.**

- Use the grounded three-prong power cable provided with your Blueair unit. The plug fits into a grounded three-prong outlet. Do not alter the plug in any way.
- Use the cable provided to plug the Blueair unit directly into an appropriate electrical outlet (please refer to the voltage label on your unit). The cable is packaged beneath the unit.

## Placement

Place the unit in a location that allows air to circulate freely in, out and around the unit. The minimum acceptable distance from another object is approximately 4" or 10 cm. Use only genuine Blueair filters.

### Do not place the unit:



Directly on or against soft furnishings, such as bedding or curtains.



Near sources of heat, such as radiators, fireplaces or ovens.



Near wet areas, such as bathrooms or laundry rooms, where it may come into contact with water.



Outdoors.

## Settings

To turn on the Blueair unit, plug the cable into a grounded three-prong wall outlet. The blue light-emitting diode indicates that the unit is turned on. Set the control knob to maximum speed for a few minutes of fast initial cleaning.

Then adjust the control to the desired speed. Maximum speed is recommended for daytime use, for fast initial cleaning or for very polluted air. Minimum speed is generally recommended for nighttime use.

For best results, run your Blueair unit 24 hours a day, 7 days a week. Round-the-clock operation ensures that a continuous supply of clean, filtered air constantly circulates throughout the room.

## Care and maintenance

Blueair air purifiers feature award-winning Swedish design, materials and workmanship. To keep your unit in top condition, we recommend routine cleaning to keep your Blueair unit looking good and working well.

- Vacuum the air intake grille from the inside when you remove the filters to replace them.
- Vacuum the small inlets with a soft brush attachment.
- Wipe the exterior of the unit with a soft, clean, damp cloth.
- Never clean with gasoline, chemical solvents or corrosive material also as these agents may damage the surface.
- Do not allow foreign objects to enter the ventilation or exhaust openings. This may cause electric shock or damage the unit.
- Do not try to repair or adjust any of the electrical or mechanical functions on your Blueair unit yourself. Contact your local dealer or Blueair for warranty information.

# Getting the most from your Blueair system

The Blueair system is easy to use. Start by choosing the right size unit for your room, and change the filters according to recommended filter replacement schedule. Remember that, just as air conditioners and heaters have limits to the volume of air they can cool or heat, every air purification system has limits to the volume of air it can clean. Follow these common-sense guidelines.

## Close your windows

You wouldn't throw open your windows on a hot summer day and expect your air conditioner to work efficiently, because you can feel the hot air coming in and the cool air going out. Even though you can't see the contaminated air coming in and the clean air going out, the same logic applies to your air purifier.

## Close your doors, too

Just as you might seal off part of your house on a cold winter night to keep your heater working more efficiently, seal off the room in which your system is working for best results. This is especially important for people using a Blueair system to ease nighttime asthma or allergy attacks.

## Run your system 24 hours per day

Blueair systems are designed for phenomenally low power usage, so you can run the system 24/7 without raising your electricity bill. In fact, it costs about the same to power a Blueair air purifier as it does to power a single light bulb - between 5 and 120 watts, depending on the unit and the operating speed.

# How it works

Simply plug the Blueair ECO10 in and turn it on. Depending on your needs, choose between the high or low setting. The pre-filters effectively capture larger airborne particles as the EC fan motor draws air into the unit. Air passes through an ion chamber where airborne particles are electrically charged with negative ions. Charged particles are drawn to the HEPASilent™ filter surface. Purified air, which is virtually contaminant-free is re-circulated into the room.

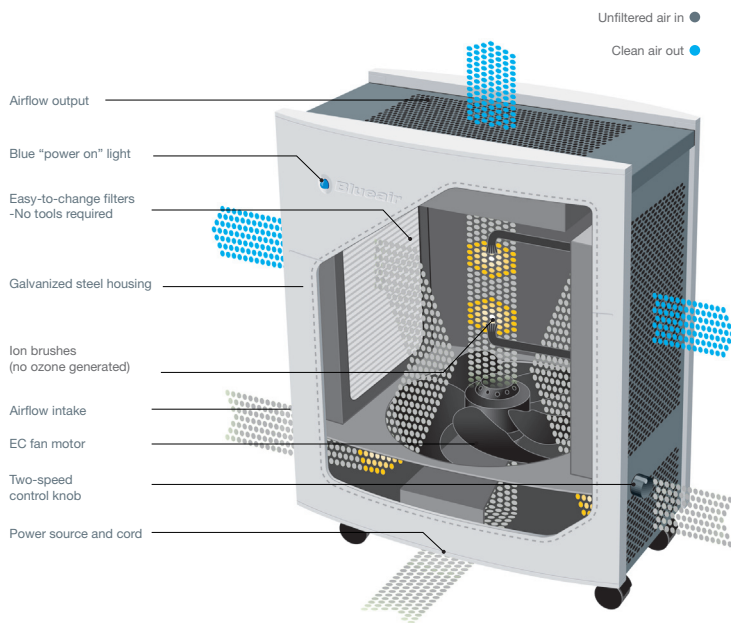

# Changing the filters

## Step 1

Unplug the unit and lift the lid from the top of the unit.

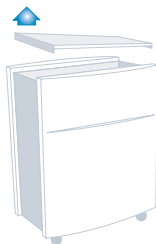

## Step 2

Remove the filter on top.

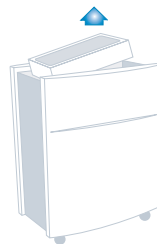

## Step 3

Remove the filters on each side. Vacuum the grille from the inside.

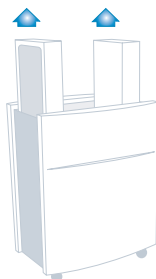

## Step 4

Guide the first and second replacement filters into the side slots. Ensure that the side with the words "facing out" is turned toward the outer wall of the unit.

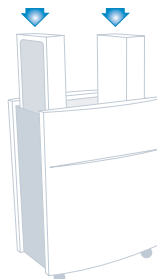

## Step 5

Place the third filter on top of the unit and ensure that the side with the words "facing out" is facing upwards.

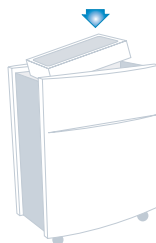

## Step 6

Snap the lid back into place.

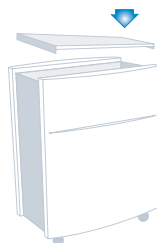



# Filters

Patented HEPASilent™ technology makes the Blueair ECO10 incredibly quiet. The unit comes with a complete set of three HEPASilent™ particle filters already installed.

Particle Filter Kit. Includes three particle filters that remove dust, pollen, bacteria, pet dander, mold spores and other airborne particles. The particle filter is made of polypropylene, which help mechanically filter out airborne particles. To maximize filter effectiveness, particles are negatively charged by the Blueair unit before reaching the filters.

Smokestop™ Filter Kit. Includes three filters with enhanced active carbon to remove gaseous pollutants such as cigarette and cigar smoke or other VOCs (volatile organic compounds, including household paints and other chemicals). You may notice a slight odor from the enhanced active carbon when the filter is first used; this will quickly dissipate.

**For optimal performance, Blueair recommends that you replace filters every 12 months.**

We offer a convenient Filter Subscription Program in some countries. Contact your local dealer or Blueair to find out whether the program is available to you.

**IMPORTANT!** Use only genuine Blueair filters to ensure proper function of your unit and to qualify for full warranty coverage.

# Specifications

Dimensions	26 x 20 x 13 inches (660 x 500 x 340 mm)
Weight	35 pounds (15.5 kilograms)
Room size	298 square feet (28 square meters)
CADR*	Smoke: 190 Dust: 195 Pollen: 200
Airflow rate	250 cubic feet per minute (425 cubic meters per hour)*
Power usage	Minimum: 5 watts Maximum: 10 watts
Noise level	49 dB(A) maximum speed
Filter service life	12 months
Warranty	Lifetime

\*Clean Air Delivery Rate, see [www.cadr.org](http://www.cadr.org)

Blueair reserves the right to change or modify any specifications without notice.

# Limited Warranty

Blueair warrants that your Blueair Air Purifier will be free from defects in material or workmanship for the lifetime of the product from the date of purchase provided that you have completed and returned your warranty registration to Blueair, and that the filters are replaced with original Blueair replacement filters at least once every twelve (12) months (the "Limited Warranty"). Within the first 30 days of purchase Blueair will replace a defective unit at no charge to you and reimburse any shipping charges. After 30 days, Blueair's obligation and liability under this Limited Warranty is limited to repairing or replacing (at its sole discretion) a defective unit and paying the freight cost of returning the unit to you. The Limited Warranty does not cover replacement filters.

## OBTAINING WARRANTY SERVICE

In the event of a malfunction or failure of your Blueair Air Purifier, please contact your local dealer or Blueair directly to obtain a return authorization number. The return authorization number must be clearly written on the outside of the shipping box or the shipment may be refused.

Your Limited Warranty remains in effect only if your Blueair air purifier:

1. Is operated in accordance with the instructions provided.
2. Has had its filter changed with original Blueair replacement filters at least once every twelve (12) months.
3. Is connected to a proper power supply (see voltage label on machine).
4. There is no evidence of tampering, mishandling, neglect, accidental damage, modification, and/or repair done to the Blueair Air Purifier by anyone other than authorized Blueair service personnel.
5. Your warranty registration has been completed and returned to Blueair.

This Limited Warranty is provided by Blueair Inc. in North America and by Blueair AB outside of North America.

BLUEAIR DISCLAIMS ANY EXPRESS WARRANTY NOT PROVIDED HEREIN AND ANY IMPLIED WARRANTY, GUARANTEE OR REPRESENTATIONS AS TO THE SUITABILITY FOR ANY PARTICULAR PURPOSE, PERFORMANCE, QUALITY AND ABSENCE OF HIDDEN DEFECTS, AND ANY REMEDY FOR BREACH OF CONTRACT, WHICH BUT FOR THIS PROVISION, MIGHT ARISE BY IMPLICATION, OPERATION OF LAW, CUSTOM OF TRADE OR COURSE OF DEALING, INCLUDING IMPLIED WARRANTIES OF MERCHANTABILITY AND FITNESS FOR A PARTICULAR PURPOSE. EXCEPT AS PROVIDED IN THIS AGREEMENT, BLUEAIR FURTHER DISCLAIMS ANY RESPONSIBILITY FOR LOSSES, EXPENSES, INCONVENIENCES, SPECIAL, INDIRECT, SECONDARY OR CONSEQUENTIAL DAMAGES ARISING FROM OWNERSHIP OR USE OF THE PRODUCTS.

This Limited Warranty gives you specific legal rights and you may also have other rights, which may vary upon legal jurisdiction.

## IMPORTANT

The Blueair unit must have a return authorization number or item will be refused. Items must be returned within 30 days after the return authorization number is issued.

Dealers will receive a credit to their account, unless told otherwise.



## Our philosophy

Blueair believes in cleaner indoor air for everyone. Removing air impurities down to the tiniest particle requires a deep commitment to continuous innovation and a greener global environment. Our fresh air solutions are not only inventive, but extremely effective, energy efficient and ecofriendly. At Blueair we believe that clean air is a human right.

[www.blueair.com](http://www.blueair.com)

### Blueair Inc.

17 N. State, Suite 1830, Chicago, IL 60602

Phone: (888) blueair (1-888-258-3247), Fax: (312) 727-1153

[info@blueair.com](mailto:info@blueair.com)

### Blueair AB

Danderydsgatan 11, SE-114 26 Stockholm, Sweden

Tel: +46-8-679 45 00, Fax: +46-8-679 45 45

[info@blueair.se](mailto:info@blueair.se)

Blueair **ECO10**



## Free Manuals Download Website

<http://myh66.com>

<http://usermanuals.us>

<http://www.somanuals.com>

<http://www.4manuals.cc>

<http://www.manual-lib.com>

<http://www.404manual.com>

<http://www.luxmanual.com>

<http://aubethermostatmanual.com>

Golf course search by state

<http://golfingnear.com>

Email search by domain

<http://emailbydomain.com>

Auto manuals search

<http://auto.somanuals.com>

TV manuals search

<http://tv.somanuals.com>