

BELKIN®

TuneBase™ FM

Mount, power, and listen to your iPod mini as you drive

 for iPod® mini



User Manual

F8V7097



Introduction

Congratulations and thank you for purchasing the innovative TuneBase FM Mobile Power Cord (the TuneBase FM) from Belkin. This product is designed to mount, stabilize, charge, power, and play your iPod mini as you drive. Please review this User Manual carefully so that you can be sure you'll get the most from your iPod mini, virtually anywhere you go.

Setup instructions

1. Turn your car stereo volume down.
2. Connect the Belkin TuneBase FM to your cigarette lighter adapter in your car. The LED on the TuneBase FM indicates proper connection.

Warning: Avoid excessive force when rotating the connector in the cigarette lighter adapter. When you face resistance, unplug the connector from the outlet and reinsert it in the desired position. Failure to do so may result in damage to the car's cigarette lighter adapter or power outlet.

NOTE: The exact dimensions of power outlets vary by make and model of the car. In some cases, the fit might be improved by pressing the collar (included with the product) into the power outlet before inserting the connector in order to ensure a tight fit. However, the collar will not be necessary in most cars (and will not fit in the power outlet).

3. Bend and position the flexible-steel neck to a desired position for your iPod mini.
4. Carefully slide your iPod mini into the form-fitted cradle at the top of the TuneBase FM. The iPod mini will power on if the car battery is on. The iPod mini will go into sleep mode if power is removed from the cigarette lighter or the car is turned off.

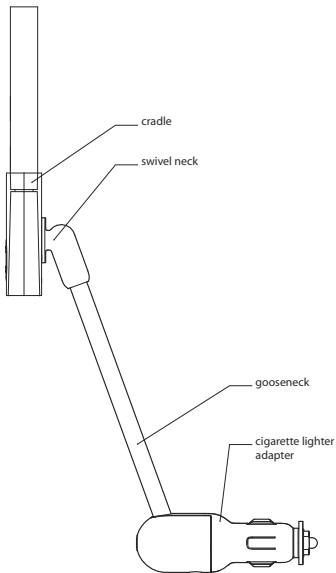

5. As an optional user method, connect your cassette adapter or audio cables to the 3.5mm audio-out jack and listen to your iPod mini through your car stereo or portable stereo device.

Power outlet or
cigarette lighter adapter

Fit ring

Connector

Make sure the ring is
positioned properly around
the metal contact to ensure
proper electrical connection
with the power outlet.

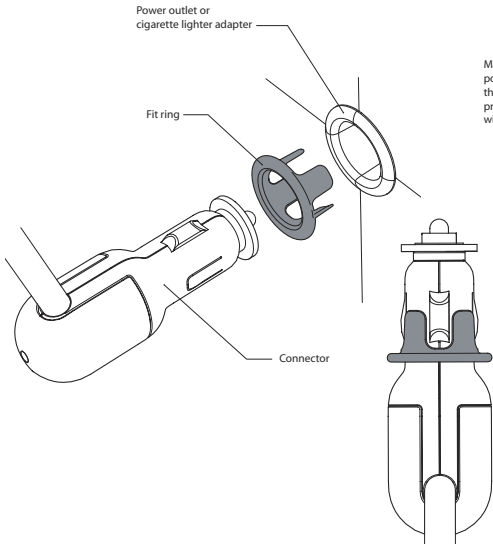

Using the TuneBase FM Transmitter

The TuneBase FM transmitter function automatically turns on when the iPod mini is connected and car power is available. It automatically turns off when the iPod mini is removed or car power becomes unavailable.

1. Tune your car stereo frequency to a channel with a weak broadcast signal. The ideal channel is one that is not broadcasting a radio program, or is doing so weakly.
2. Press the ▲ or ▼ button on the TuneBase to select the transmission frequency chosen in step 1, in your car, for broadcast. Press and hold either button for fast-forward or backward tuning.
3. To memorize a specific frequency (four stations maximum) for easy selection:
 - (a) **select desired frequency using up and down arrows;**
 - (b) **press and hold the desired preset button for 2 seconds; the first digit of the display will indicate the chosen memory spot; and**
 - (c) **press 1 of the 4 memory buttons briefly to toggle among the 4 memory slots and retrieve the memorized frequency.**
4. Adjust the volume of your FM radio to the desired listening level.

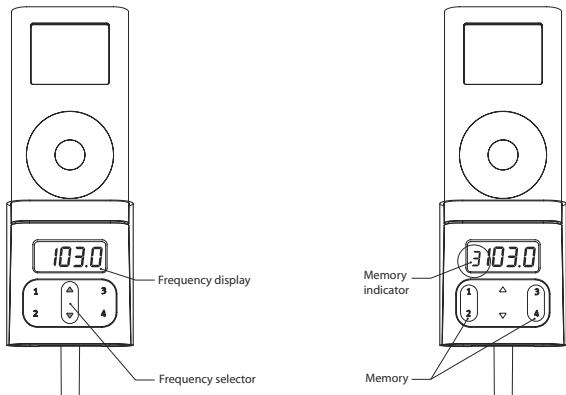

NOTE: In some instances, when open frequencies are hard to find, lowering the car antenna (available in some cars) will improve the clarity of the TuneBase FM's signal.

NOTE: To avoid damage to the iPod mini, please make sure to disconnect the iPod mini from the TuneBase FM's cradle before disconnecting the TuneBase FM from the power outlet of the car.

Troubleshooting

My iPod does not seem to be charging.

Solution 1

Please make sure that the TuneBase is connected to the power outlet of the car correctly. The green indicator light on the cigarette lighter adapter portion of the product should be lit up at all times.

Solution 2

Please make sure that the iPod is pushed all the way into the cradle.

Solution 3

Please make sure that the power outlet of your car is provided with power. Some cars do not provide power to the power outlet unless the car is in ignition mode or the engine is started. In case all previous solutions did not solve the problem the fuse of the TuneBase might be burned. In order to exchange the fuse, please follow these steps carefully:

DO NOT ATTEMPT TO DO THIS IN THE CAR. Please use a clean table for disassembly so that components do not get lost. The contact piece at the front end of the cigarette lighter adapter is spring loaded. Carefully remove the nut at the front end with pliers. Remove it slowly so that the spring inside the cigarette lighter adapter does not get lost. The fuse will be easily accessible now. Please exchange for a new one available at any car supply store. Please refer to Fig. B for correct order of assembly. Make sure to tighten the nut firmly with pliers.

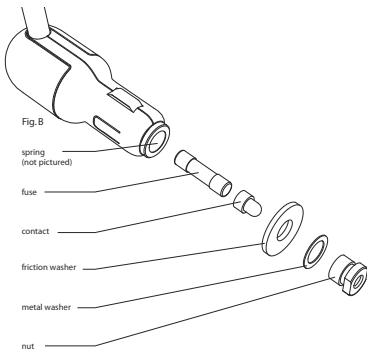

The TuneBase and iPod are in the way of my car's controls.

Solution 1

The TuneBase has been designed to be easily positioned in a wide variety of orientations in the car. Please use the gooseneck and the articulation behind the docking cradle to position it away from any controls of the car. Please make sure to position the gooseneck in as close to an upright position from the CLA as possible (Fig. A).

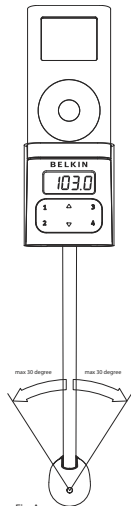

Troubleshooting

The Tunebase rotates out of position around the center of the power outlet.

Solution 1

Please make sure to solidly attach the cigarette lighter adapter portion of the product in the power outlet. Test the stability by pushing the product sideways before driving.

Solution 2

In some cars, the power outlet is bigger in diameter than the cigarette lighter adapter. You will notice a wiggle in the TuneBase when pushing it. In that case, please use the collar provided to decrease any play. Fit the collar around the cigarette lighter adapter of the TuneBase first and then attach the cigarette lighter adapter in the power outlet. Slide the collar into the power outlet making sure that all four protrusions fit into the power outlet.

Solution 3

Some power outlets will not fit all four protrusions of the collar. In order to improve the fit of the cigarette lighter adapter in the power outlet of the car the collar can be cut to size. In order to do so please cut as many protrusions as necessary with scissors. Cut one by one always trying the fit again in the power outlet after each cut. Cut the protrusions from one side to the other, not the opposites (Fig. C).

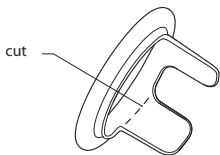
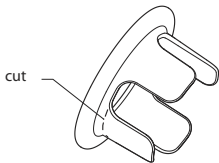

Test fit in power outlet after each cut!

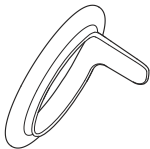
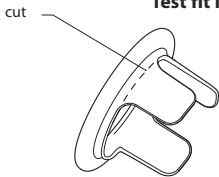

Fig.C

The TuneBase connects firmly to the power outlet of my car but the TuneBase still rotates.

Solution

Please see if the power outlet of your car rotates in its socket. If so, please consult your car manufacturer.

Troubleshooting

The rubber friction washer is out of position and I cannot insert the cigarette lighter adapter into the car's power outlet.

Solution

Please use a clean and empty table for disassembly. **DO NOT ATTEMPT TO DO THIS IN THE CAR.** Please use pliers to loosen the nut at the end of the cigarette lighter adapter slightly. It is not necessary to unscrew the entire nut. Move the friction washer back into centered position. Use pliers to tighten the nut firmly.

I pulled the TuneBase out of the power outlet of my car but the rubber washer slipped off and remained in the power outlet.

Solution

In some rare cases the specific make up of the power outlet may cause the friction washer to get stuck in the power outlet and potentially slip off the cigarette lighter adapter.

DISCONNECT THE BATTERY OF YOUR CAR BEFORE ATTEMPTING TO REMOVE THE WASHER! ANY ATTEMPT TO REMOVE THE WASHER WITHOUT DISCONNECTING THE BATTERY MAY RESULT IN PHYSICAL HARM OR DAMAGE TO THE CAR.

Use pliers to carefully remove the friction washer from the power outlet.

Warning:

The TuneBase/ TuneBase FM requires full concentration and both hands to install. *DO NOT ATTEMPT TO INSTALL THE PRODUCT WHILE DRIVING.* Please make sure the product securely and firmly fits into the power outlet of the car before driving. After installation, ensure that the TuneBase does not freely rotate in the power outlet of the car by following the instructions in the user manual. *DO NOT ATTEMPT TO ADJUST OR RETRIEVE AN UNSECURED TUNEBASE OR IPOD WHILE DRIVING.* Adjust the TuneBase so that both the TuneBase and the iPod do not interfere with any of the operating controls of the car.

DO NOT INSERT ANY OBJECTS OTHER THAN THE CIGARETTE LIGHTER ADAPTER INTO THE POWER OUTLET OF THE CAR WITHOUT DISCONNECTING THE BATTERY OF THE CAR FIRST. FAILURE TO OBSERVE THIS SAFETY WARNING CAN RESULT IN POSSIBLE INJURY OR PROPERTY DAMAGE.

Belkin does not assume any responsibility for personal injury or property damage incurred due to hazardous driving as a result of interaction with the TuneBase, the iPod or the power outlet of the car.

FCC Statement

DECLARATION OF CONFORMITY WITH FCC RULES FOR ELECTROMAGNETIC COMPATIBILITY

We, Belkin Corporation, of 501 West Walnut Street, Compton, CA 90220, declare under our sole responsibility that the product:

F8V7097

to which this declaration relates:

Complies with Part 15 of the FCC Rules. Operation is subject to the following two conditions: (1) this device may not cause harmful interference, and (2) this device must accept any interference received, including interference that may cause undesired operation.

CE Declaration of Conformity

We, Belkin Corporation, declare under our sole responsibility that the product F8V7097, to which this declaration relates, is in conformity with Emissions Standard EN55022 and with Immunity Standard EN55024, LVP EN61000-3-2, and EN61000-3-3.

ICES

This Class B digital apparatus complies with Canadian ICES-003. Cet appareil numérique de la classe B est conforme à la norme NMB-003 du Canada.



Belkin Corporation Limited 3-Year Product Warranty

Belkin Corporation warrants this product against defects in materials and workmanship for three years. If a defect is discovered, Belkin will, at its option, repair or replace the product at no charge provided it is returned during the warranty period, with transportation charges prepaid, to the authorized Belkin dealer from whom you purchased the product. Proof of purchase may be required. This warranty does not apply if the product has been damaged by accident, abuse, misuse, or misapplication; if the product has been modified without the written permission of Belkin; or if any Belkin serial number has been removed or defaced.

THE WARRANTY AND REMEDIES SET FORTH ABOVE ARE EXCLUSIVE IN LIEU OF ALL OTHERS, WHETHER ORAL OR WRITTEN, EXPRESSED OR IMPLIED. BELKIN SPECIFICALLY DISCLAIMS ANY AND ALL IMPLIED WARRANTIES, INCLUDING, WITHOUT LIMITATION, WARRANTIES OF MERCHANTABILITY AND FITNESS FOR A PARTICULAR PURPOSE.

No Belkin dealer, agent, or employee is authorized to make any modification, extension, or addition to this warranty.

BELKIN IS NOT RESPONSIBLE FOR SPECIAL, INCIDENTAL, OR CONSEQUENTIAL DAMAGES RESULTING FROM ANY BREACH OF WARRANTY, OR ANY OTHER LEGAL THEORY, INCLUDING BUT NOT LIMITED TO, LOST PROFITS, DOWNTIME, GOODWILL, DAMAGE TO OR REPROGRAMMING OR REPRODUCING, ANY PROGRAM OR DATA STORED IN OR USED WITH BELKIN PRODUCTS.

Some states do not allow the exclusion or limitation of incidental or consequential damages or exclusion of implied warranties, so the above limitations or exclusions may not apply to you. This warranty gives you specific legal rights, and you may also have other rights that vary from state to state.

BELKIN®

www.belkin.com

Belkin Corporation
501 West Walnut Street
Compton, CA, 90220, USA
310-898-1100
310-898-1111 fax

Belkin Ltd.
Express Business Park, Shipton Way
Rushden, NN10 6GL, United Kingdom
+44 (0) 1933 35 2000
+44 (0) 1933 31 2000 fax

Belkin B.V.
Boeing Avenue 333
1119 PH Schiphol-Rijk, The Netherlands
+31 (0) 20 654 7300
+31 (0) 20 654 7349 fax

Belkin Ltd.
7 Bowen Crescent, West Gosford
NSW 2250, Australia
+61 (0) 2 4372 8600
+61 (0) 2 4372 8603 fax

Tech Support
US: 310-898-1100 ext. 2263
800-223-5546 ext. 2263
Europe: 00 800 223 55 460
Australia: 1800 235 546
New Zealand: 0800 235 546

© 2004 Belkin Corporation. All rights reserved.

All trade names are registered trademarks of respective manufacturers listed.
iPod is a trademark of Apple Computer, Inc., registered in the U.S. and other countries.

P74667-A

Free Manuals Download Website

<http://myh66.com>

<http://usermanuals.us>

<http://www.somanuals.com>

<http://www.4manuals.cc>

<http://www.manual-lib.com>

<http://www.404manual.com>

<http://www.luxmanual.com>

<http://aubethermostatmanual.com>

Golf course search by state

<http://golfingnear.com>

Email search by domain

<http://emailbydomain.com>

Auto manuals search

<http://auto.somanuals.com>

TV manuals search

<http://tv.somanuals.com>