

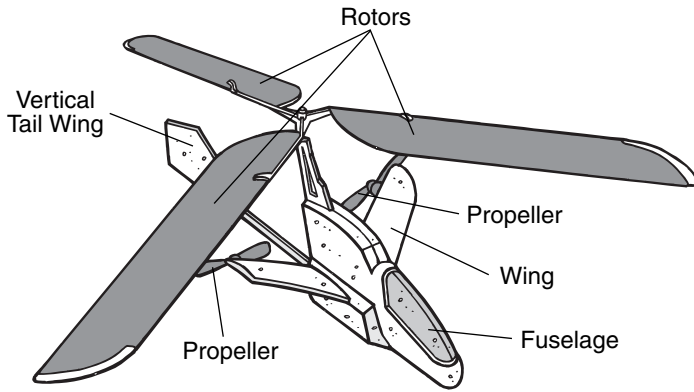

INSTRUCTIONS

Check to make sure contents are complete:
 • 1 Air Hogs® Gyro Havoc™ • 1 Wind Ribbon
 • 1 Charger/Controller • 1 Instruction Sheet



Gyro Havoc™

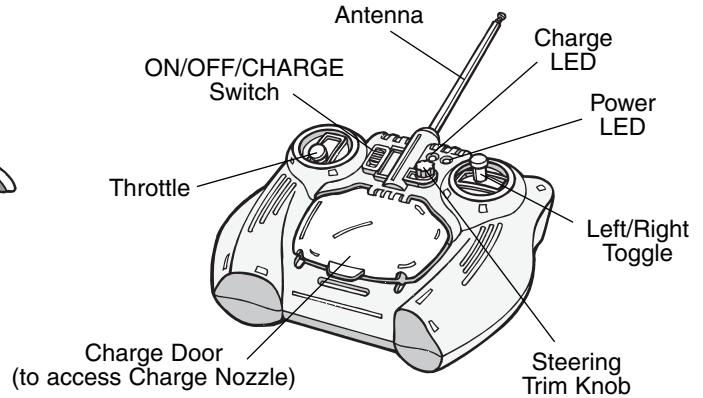

Charger/Controller

Experience radio-controlled flight with the Air Hogs® RC Gyro Havoc™! The Gyro Havoc™ is half airplane and half helicopter making flying fun & easy! Just choose the direction you want to fly and press the controller toggle. The ultra-light Gyro Havoc™ is powered by a lithium battery for long flights, features precision speed control and damage-resistant foam. The Gyro Havoc™ also includes an integrated Charger/Controller unit for convenient portability and easy handling on the field.

CHARGER/CONTROLLER BATTERY INSTALLATION

1. Use a Phillips screwdriver to loosen the battery door.
2. Remove the battery door.
3. Install **6 AA 1.5-V alkaline batteries** (not included). Be careful to align the positive (+) and negative (-) polarities with the corresponding markings inside the battery compartment.
4. Reinstall the battery door and tighten the screw.

IMPORTANT TIP: TURN YOUR CHARGER/CONTROLLER ON TO ENSURE THAT THE BATTERIES ARE INSTALLED PROPERLY. THE RED LIGHT ON THE FRONT OF THE CHARGER/CONTROLLER SHOULD TURN RED.

After use, store the Gyro Havoc™ in its package to prevent damage.

Your Gyro Havoc™ has a preinstalled rechargeable battery in the aircraft's fuselage.

Because the Controller's AA batteries are used for 2 functions – charging and controlling, they will need to be replaced after every 20 – 25 flights.

WARNING:
THIS PRODUCT IS A GYROCOPTER!

A gyrocopter is different from an airplane or conventional helicopter. Read these instructions to ensure successful flights.

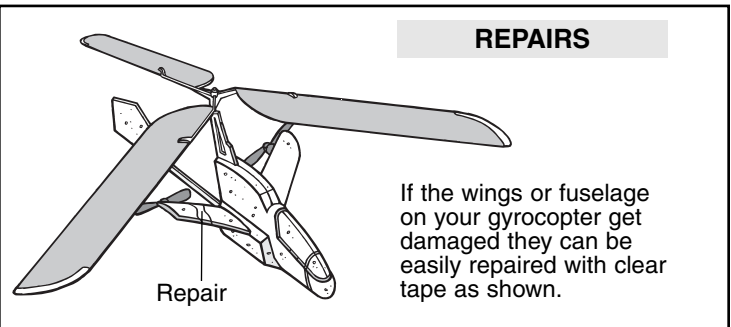
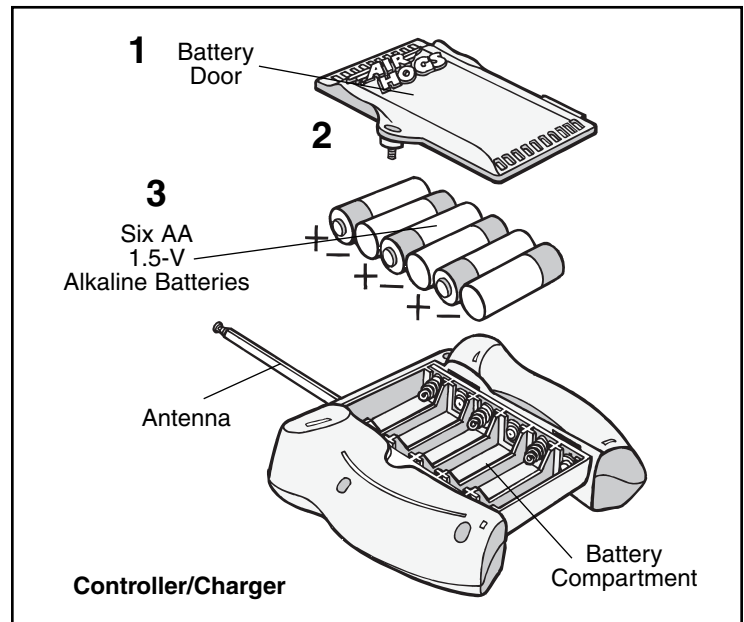

REPAIRS

If the wings or fuselage on your gyrocopter get damaged they can be easily repaired with clear tape as shown.

CHARGING YOUR GYROCOPTER

Important Charging Information:

- Before taking your initial flight, charge the Gyro Havoc™ for a complete charge cycle on your charger.
 - Depending upon the length of future play, you will not need to complete a full charge before each flight.
- NOTE:** A shortened charge results in a shorter play time (may take up to 1/2 hour to fully charge).

1. Push the aircraft's ON/OFF switch to the left to set the aircraft to **OFF**.

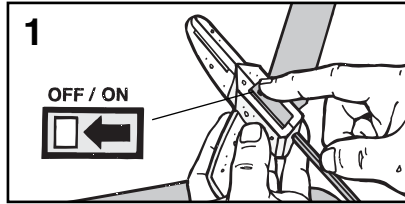

2. Set the charger/controller switch to **OFF**.

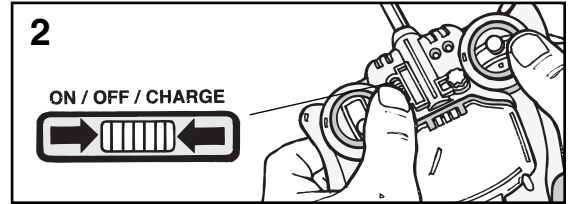

3. Flip the charge door open to reveal the charge nozzle.

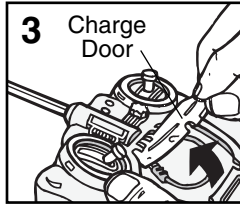

4. Push the charge nozzle all the way into the aircraft's charge port located at the bottom of the aircraft.

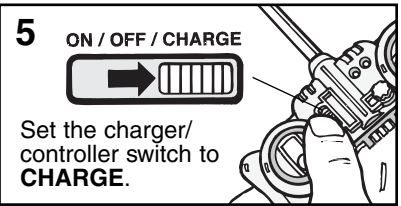
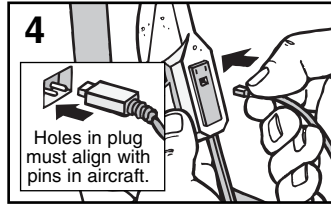

5. During the charging process, the green charge light will turn **ON**. When the Gyro Havoc™ is completely charged, the green charging light will turn **OFF**.

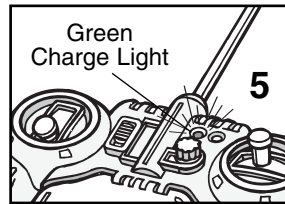

6. Remove charge nozzle gently from the aircraft's charge port. Store charge nozzle and close the charge door.

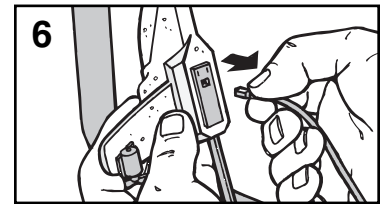

PRE-FLIGHT ENVIRONMENT CHECK

- 1. Location** – Fly in a large wide open, grassy location that is free of buildings, trees, overhead wires, and other obstructions. Do not fly near people or animals.
- 2. Weather** – Fly on mild, sunny days. Do not fly in electrical storms, rain, sleet, snow or other adverse weather conditions. Do not fly if the temperature is below 45°F. In very cold temperatures, the aircraft will become fragile and the engine performance will decrease.
- 3. Wind Conditions** – Do not fly in wind. Winds may overpower the aircraft and make it difficult to control. Use the wind ribbon included to measure the wind, do not fly if the ribbon is 45° or more (see No. 6).

FLYING INSTRUCTIONS

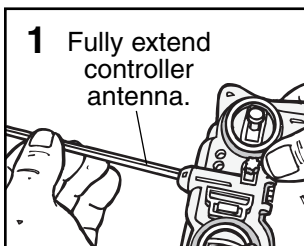

- 1 Fully extend controller antenna.

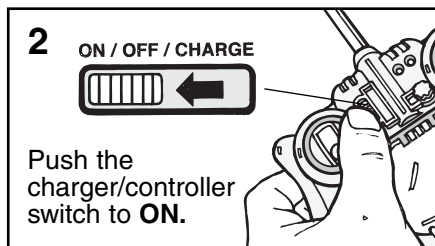

- 2 ON / OFF / CHARGE
Push the charger/controller switch to **ON**.

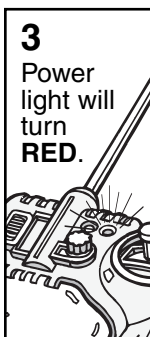

- 3 Power light will turn **RED**.

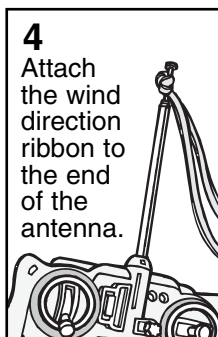

- 4 Attach the wind direction ribbon to the end of the antenna.

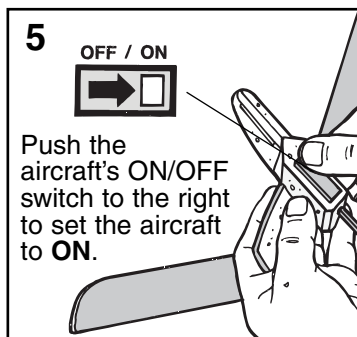

- 5 OFF / ON
Push the aircraft's ON/OFF switch to the right to set the aircraft to **ON**.

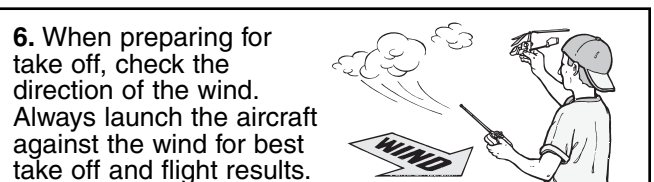

6. When preparing for take off, check the direction of the wind. Always launch the aircraft against the wind for best take off and flight results.

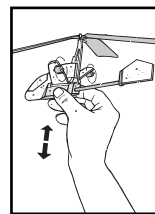

7. Hold the Gyro Havoc™ from underneath. Wave aircraft **UP** and **DOWN** using the downward stroke to start rotation of the rotors. The rotors should reach top speed after 5-10 strokes.

8. With the rotors still spinning, gently toss the aircraft forward into the wind and parallel to the ground. Immediately ease up the throttle on the controller until the aircraft begins to rise. Refrain from using the directional until the aircraft is flying forward in a stable manner.

CONTROLLING AIRCRAFT FLIGHT

Charger/Controller
Throttle

NOTE: The Gyrocopter's rotors are not powered (Helicopters have powered rotors) – the rotors spin due to interaction with the air as the Gyrocopter moves.

To increase the height or gain altitude, increase throttle (left stick).

LEFT TURN
Tap or pulse the steering stick (right stick) to the left, this will result in a gentle turn, for a steep turn, hold the stick to the left.

RIGHT TURN
Tap or pulse the steering stick (right stick) to the right, this will result in a gentle turn, for a steep turn, hold the stick to the right.

Charger/Controller
Throttle

TO LAND
Select a soft grassy area and ease the throttle down.

NOTE:
In a tight or steep turn, the Gyrocopter will lose altitude and will be slow to recover level flight – ensure you have the altitude and skill before attempting a steep turn.

ONCE THE AIRCRAFT HAS LANDED

1 ON / OFF / CHARGE

Turn the charger/controller **OFF** by pulling the switch down.

2 OFF / ON

Turn plane **OFF** by pushing switch to the left.

FLIGHT ADJUSTMENTS

Steering Trim Knob

If your aircraft is continuously turning to the left or the right, you can straighten out the flight path by turning the steering trim knob slightly to the left or the right during flight.

TROUBLESHOOTING GUIDE

PROBLEM	CAUSE	SOLUTION
Aircraft will not start or has low power.	<ol style="list-style-type: none"> 1. Aircraft not charged. 2. Battery power is drained. 3. Aircraft was not set to OFF during charging. 4. Charger/controller was not set to "Charger OFF". 	<ol style="list-style-type: none"> 1. Charge aircraft for a complete charge cycle. 2. Replace the charger/controller batteries after 20 flights. 3. The aircraft won't accept a charge in the ON position. Always set to "OFF" before charging. 4. The charger/controller will NOT charge in the "Control ON" position. Always set the charger/controller to "Charger OFF" before attempting to charge.
Aircraft will not turn.	<ol style="list-style-type: none"> 1. Charger/controller is not ON. 2. Charger/controller antenna is not fully extended. 3. It's a windy day or you're flying by a vent/fan. 	<ol style="list-style-type: none"> 1. Set charger/controller to "Controller ON" 2. Fully extend charger/controller antenna before flying. 3. Do not fly in winds. Windy conditions will limit and prevent your ability to control the plane. If flying indoors, do not fly near a vent/fan.
Aircraft is flying too low.	<ol style="list-style-type: none"> 1. Needs more power. 2. The six AA batteries in the charger/controller are drained. 	<ol style="list-style-type: none"> 1. Press the Throttle UP. 2. Install new batteries.
Aircraft is flying too high.	<ol style="list-style-type: none"> 1. Need to decrease power. 	<ol style="list-style-type: none"> 1. Press the Toggle DOWN.
Motors don't stop when charger/controller is turned OFF.	<ol style="list-style-type: none"> 1. Set to full throttle. 	<ol style="list-style-type: none"> 1. Turn charger/controller ON, reduce throttle to 0 and turn charger/controller OFF.

IMPORTANT BATTERY INFORMATION

REQUIRED BATTERIES: Charger/Controller takes 6 AA Alkaline Batteries (not included).

Battery installation should be performed by an adult. Use only batteries recommended in the instruction sheet. Be careful to install the batteries with the correct polarity, as indicated.

- Do not mix old and new batteries.
- Do not mix alkaline, standard or rechargeable batteries.
- Battery installation should be done by an adult.
- Non-rechargeable batteries are not to be recharged.
- Rechargeable batteries are to be removed from the toy before being charged (if removable).
- Rechargeable batteries are only to be charged under adult supervision

- (if removable).
- Only batteries of the same or equivalent type as recommended are to be used.
- Batteries are to be inserted with the correct polarity.
- Exhausted batteries are to be removed from the toy.
- The supply terminals are not to be short-circuited.
- Different types of batteries, or new and used batteries are not to be mixed.
- Exhausted batteries are to be removed, as they will adversely affect the performance.

CAUTION:

PLEASE READ BEFORE CHARGING OR USING BATTERY.

Your aircraft is equipped with a Lithium Polymer battery; please also pay attention to the following cautions for safe use:

- Do not dispose the battery in fire or heat.
- Do not use or leave the battery near a heat source such as fire or heater.
- Do not strike or throw the battery against hard surfaces.
- Do not immerse the battery in water. Keep the battery in a cool dry environment.

- When charging, only use the battery charger specifically for that purpose.
- Do not over-charge the battery.
- Do not connect the battery to an electrical outlet.
- Do not directly solder the battery or pierce the battery with a nail or other sharp objects.
- Do not transport or store the battery together with metal objects such as necklaces, hairpins, etc.
- Do not disassemble or alter the battery.
- Charge the battery every 6 months.
- Turn off your equipment power switch after use.
- As for a used battery, please recycle the battery by covering the terminals with insulation tape or inserting into an individual polybag.

FCC STATEMENTS:

This device complies with part 15 of the FCC rules. Operation is subject to the following two conditions:

1. This device may not cause harmful interference, and
2. This device must accept any interference received, including interference that may cause undesired operation.

NOTE: This equipment has been tested and found to comply with the limits for a Class B digital device, pursuant to Part 15 of the FCC Rules. These limits are designed to provide reasonable protection against harmful interference in a residential installation. This may cause harmful interference to radio communications.

However, there is no guarantee that interference will not occur in a particular installation. If this equipment does cause harmful interference to radio or television reception, which can be determined by turning the equipment off and on, the user is encouraged to try to correct the interference by one of more of the following measures:

- Reorient or relocate the receiving antenna.
- Increase the separation between the equipment and the receiver.
- Connect the equipment into an outlet on a circuit different from that to which the receiver is needed.
- Consult the dealer or an experienced radio/TV technician for help.

CAUTION: Changes or modifications not expressly approved by the party responsible for compliance could void the user's authority to operate the equipment.

Spin Master Ltd., 450 Front Street West, Toronto, ON M5V 1B6 Canada
Spin Master, Inc., PMB #10053, 300 International Drive, Suite 100,
Williamsville, NY 14221, USA
Spin Master Toys Far East Limited, Rm #1113, 11/F,
Chinachem Golden Plaza, 77 Mody Rd., Tsimshatsui E., Kowloon, HK

Air Hogs ® is a registered trademark and Gyro Havoc TM is a trademark of Spin Master Ltd. © 2007 Spin Master Ltd. All rights reserved. Manufactured for and distributed by Spin Master Ltd. Conforms to safety standards ASTM F963, EN71 Regulatory Requirements. Products and colors may vary. Please retain this information for future reference. MADE IN CHINA.

Contains Lithium Polymer battery. Battery must be recycled or disposed of properly.



North American Consumer Information
Phone: 1-800-622-8339
www.spinmaster.com

#20004667 NEN REV 0



Free Manuals Download Website

<http://myh66.com>

<http://usermanuals.us>

<http://www.somanuals.com>

<http://www.4manuals.cc>

<http://www.manual-lib.com>

<http://www.404manual.com>

<http://www.luxmanual.com>

<http://aubethermostatmanual.com>

Golf course search by state

<http://golfingnear.com>

Email search by domain

<http://emailbydomain.com>

Auto manuals search

<http://auto.somanuals.com>

TV manuals search

<http://tv.somanuals.com>