

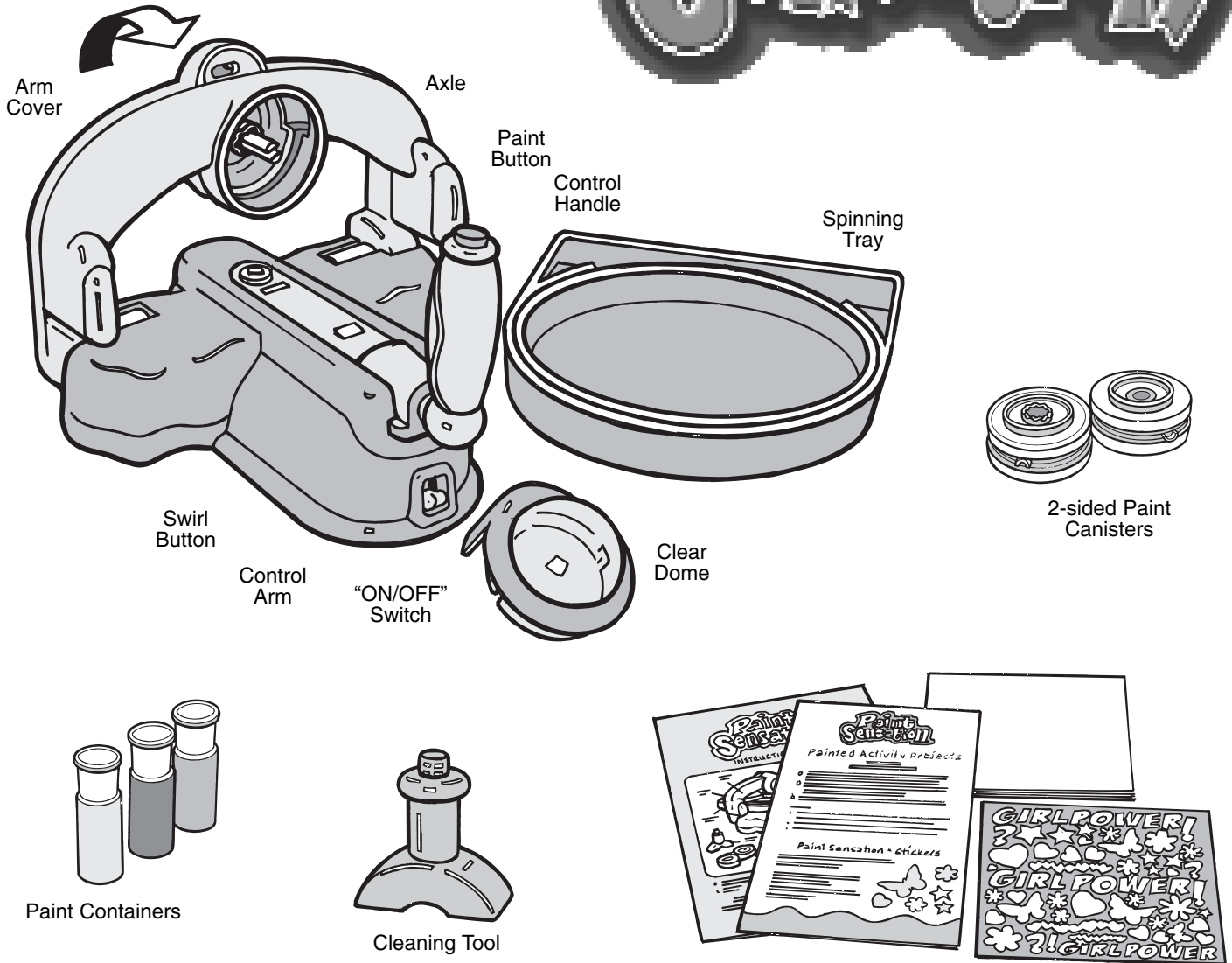

Paint Sensation



- Design COOL ART and CRAFTS with Paint Sensation™!
- Paint on whatever you can fit into the Spinning Tray!

Please remove everything from the packaging and compare to the contents shown on this page.

If any items are missing, please call Spin Master's customer care hotline: 1-800-622-8339.

Product and colours may vary.

Keep these instructions for future reference as they contain important information.

ASSEMBLY

1

A. Raise the Paint arm to an upright position.

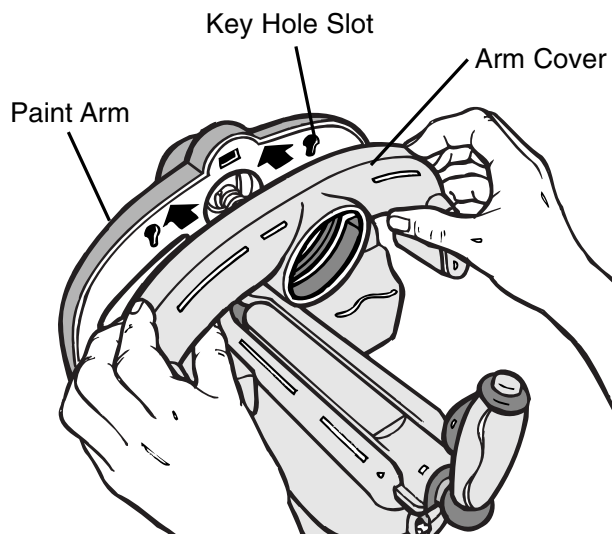

B. Push down until the Arm Cover clicks into position.

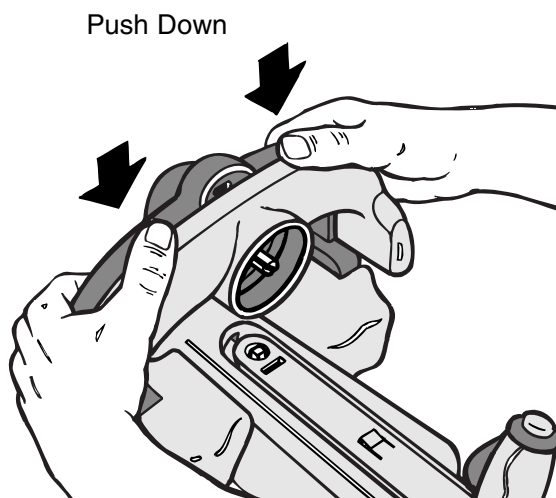

2

A. Remove lid. Fill Paint Canister 3/4 full.

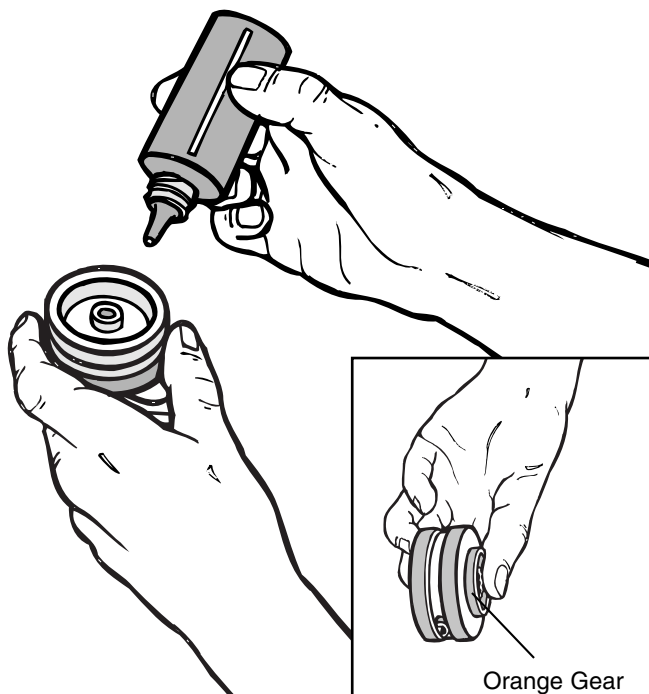

Note: The orange gear in the centre of the canister must face the axle. Push until you hear a click.

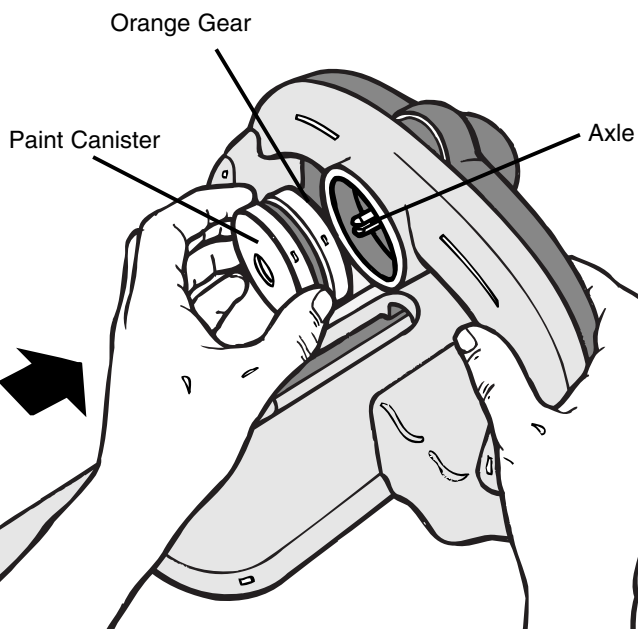

ASSEMBLY (CONTINUED)

3

Cover the Paint Canister with the Clear Dome, turning it clockwise, until it locks into place.

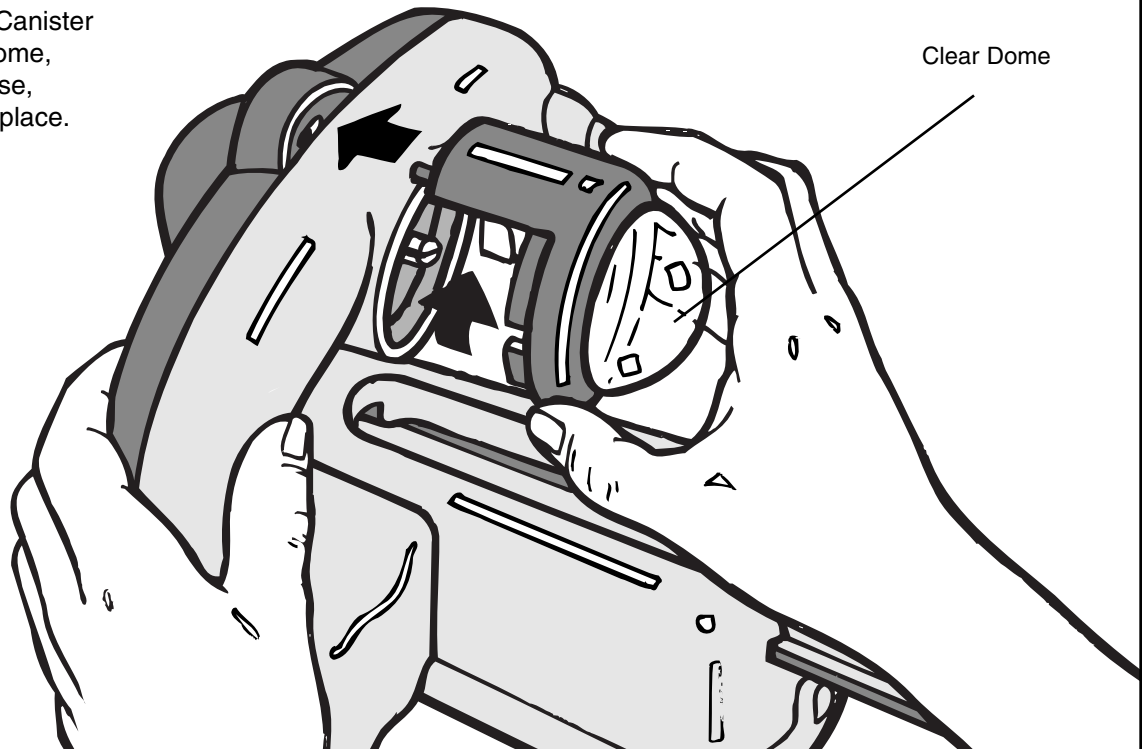

4

Pull the Control Arm out and position the Bottom Paint Tray into the slot in the centre of the control arm, as shown.

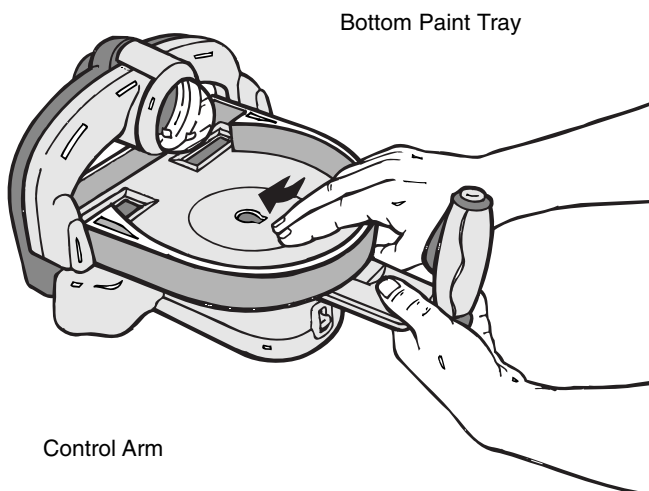

Place Spinning Tray into the Bottom Paint Tray and rotate it until it slides down and into place.

You are ready to Create Your Own Paint Sensations™!

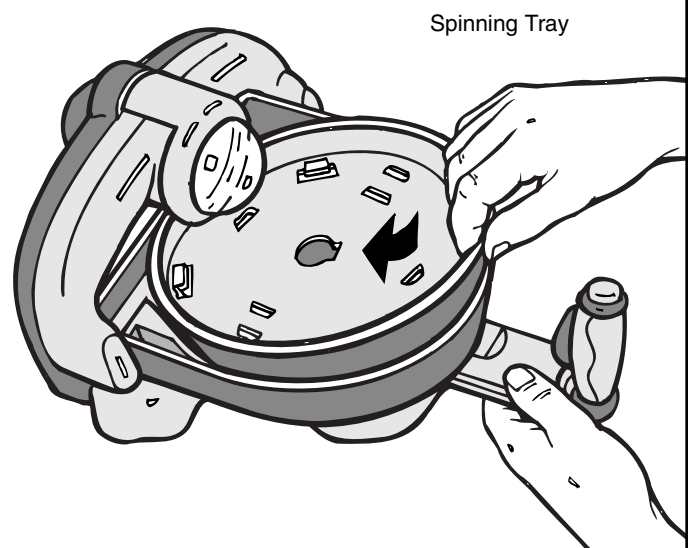

CREATING

Try experimenting with each of the 3 controls. Experimenting will lead you to discover how to make endless designs with Paint Sensation™! Paint Sensation™ has 3 control locations:

1

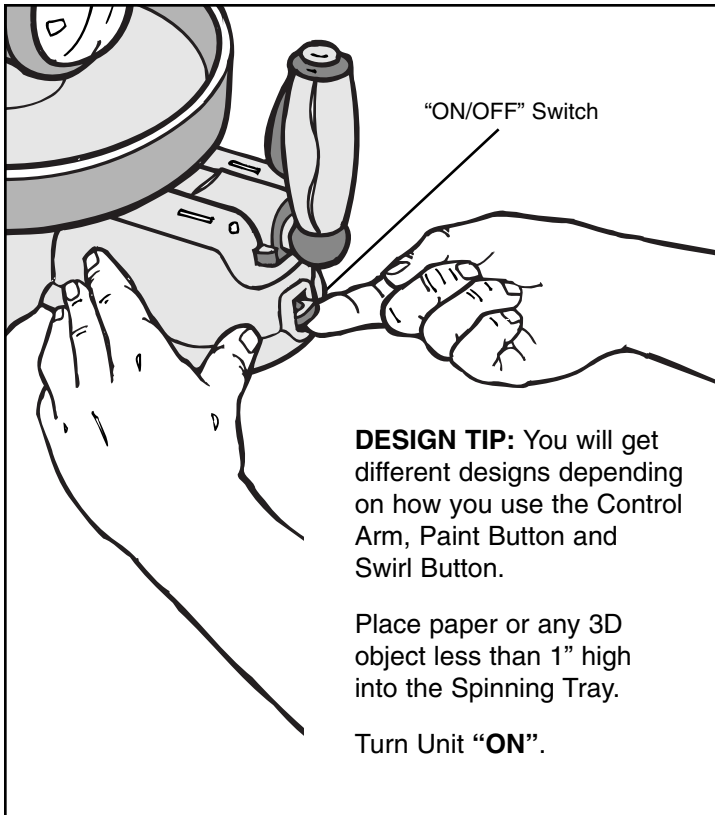

Pressing or Pulsing the Paint Button controls how fast paint comes out of the Paint Canister.

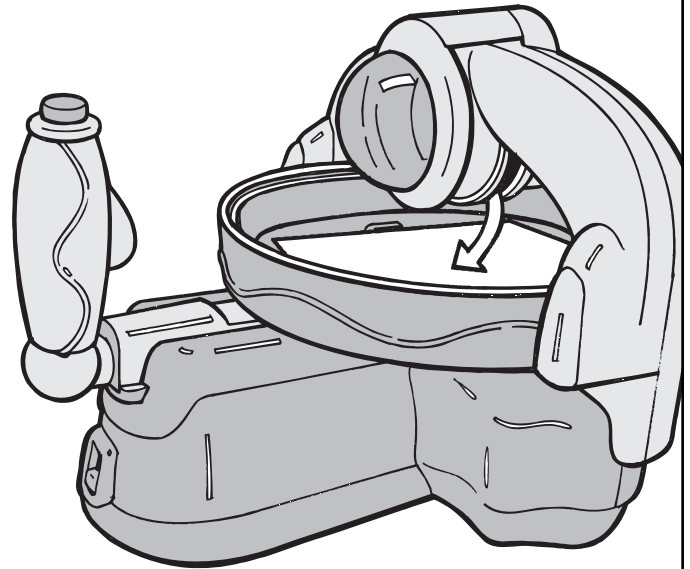

2

Pressing the Swirl Button controls the Spinning Tray. Slowly pulse the Swirl Button. This will move the tray a little at a time and will give you straight paint lines. Or hold the swirl button down for longer bigger swirls.

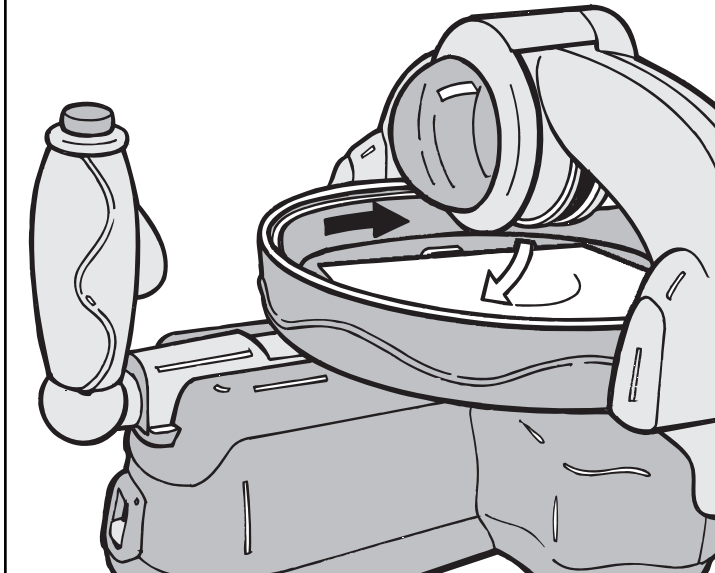

3

Moving the Control Arm in or out lets you control where the paint goes onto your art.

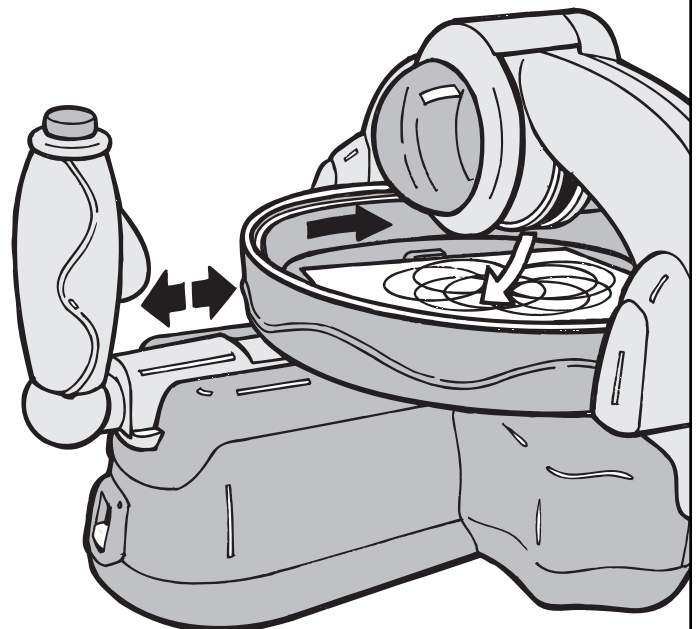

CLEANING

- Remove the Arm Cover, Trays, Clear Dome and Paint Canisters from Paint Sensation™.
- Rinse or soak each one with warm water and soap.
- Hold the Arm Cover upside down under warm running water.
- Rinse until all parts are clean.
- Allow to dry.

1

Each Paint Canister has tiny holes that the paint comes out of. If these holes get blocked you can't paint. The Cleaning Tool unblocks the Paint Holes. To use the Cleaning Tool, insert as shown. Align half-moon curve on the Paint Canister with the docking curve in the Cleaning Tool.

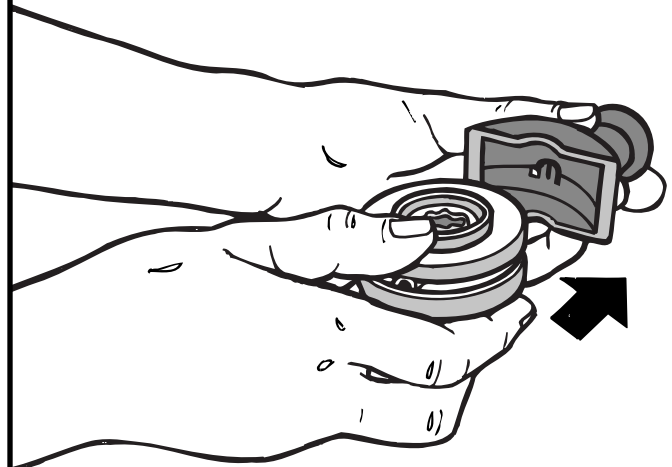
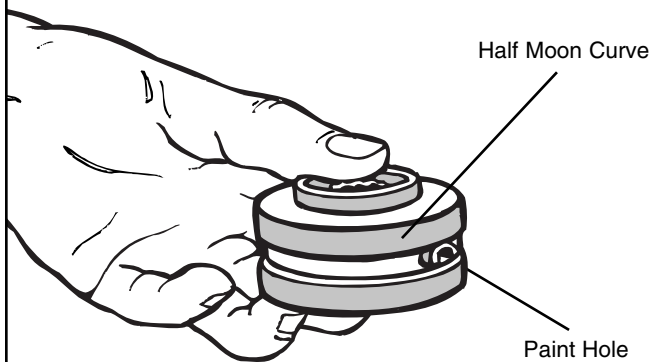

2

Wiggle the Paint Canister until the raised Center Circle on the Paint Canister lid fits snugly into the half circle in the Cleaning Tool base.

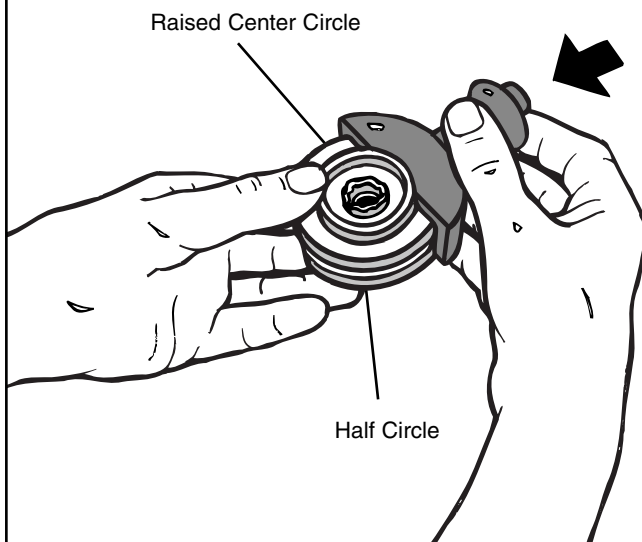

3

Press the button on the Cleaning Tool to clean the hole.

Always release button on the Cleaning Tool before removing Paint Canister from the Cleaning Tool. Repeat to clean the second hole in the Paint Canister.

WARNING: Cleaning Tool contains a functional sharp point.

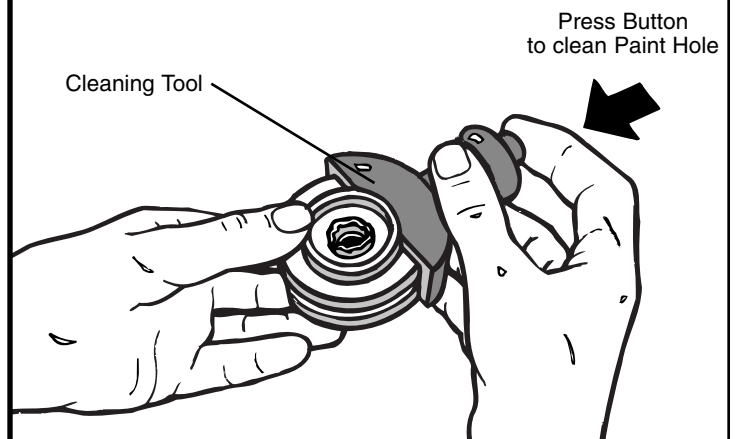

TROUBLESHOOTING

Paint is not coming out when I press the Paint Button.	<ul style="list-style-type: none"> • The Paint Canister does not have enough paint in it. Refill with fresh paint. • The Paint Canister holes are blocked. Read the section on Cleaning Tool under Cleaning Paint Canisters in these instructions.
Paint is dripping onto my creations.	<ul style="list-style-type: none"> • Paint can build up in the Arm Cover after frequent use. Remove the Arm Cover and rinse with warm soapy water. Reattach to the Paint Arm.
The paint comes out too fast.	<ul style="list-style-type: none"> • Try pulsing the Paint Button
I can't make my designs look like swirls.	<ul style="list-style-type: none"> • Slow down how fast you are moving the Control Arm back and forth.
Paint Sensation™ has no power.	<ul style="list-style-type: none"> • Make sure the ON/OFF button is in the ON position. • Batteries may need replacing. Ask a parent to replace the batteries.
I can't get water out from inside the Arm Cover after it has been washed.	<ul style="list-style-type: none"> • Shake out as much water as possible after cleaning. Residual water will evaporate and will not affect the toy's performance.
Cleaning Tool button will not depress.	<ul style="list-style-type: none"> • The Half Moon Tool Guide has not connected with the Tool Guide inside the Cleaning Tool. Reposition and reinsert until the Cleaning Tool Button depresses.

BATTERY INSTALLATION

1. Use a phillips screwdriver (not provided) to loosen the battery compartment door hold down screws. Remove the battery compartment door.
2. Install four 1.5-Volt "C" alkaline batteries (not included). Be careful to align the positive (+) and (-) polarities with the corresponding markings inside the battery compartment.
3. Replace the battery compartment door and refasten the screws.
4. Batteries are not included.

IMPORTANT BATTERY INFORMATION

- Battery installation and change of battery should always be performed by an adult.
- Be careful to install the batteries with the correct polarity as indicated.
- Do not mix alkaline, standard (carbon zinc), rechargeable (nickel cadmium or nickel-metal hydrate) batteries.
- Different types of batteries or new and used batteries are not to be mixed.
- Use Alkaline batteries for better performance.
- Non-rechargeable batteries are not to be recharged.
- Rechargeable batteries are to be removed from the toy before being charged (if removable).
- Exhausted batteries are to be removed from the toy.
- Only batteries of the same or equivalent type as, recommended are to be used.
- The supply terminals are not to be short circuited.
- Do not mix old and new batteries.
- Products with non-replaceable batteries are not to be disposed of in a fire as the batteries inside may explode and leak.
- Dispose of batteries safely.
- Do not use rechargeable batteries.

Paint-Sensation™ turned over to access the Battery Compartment

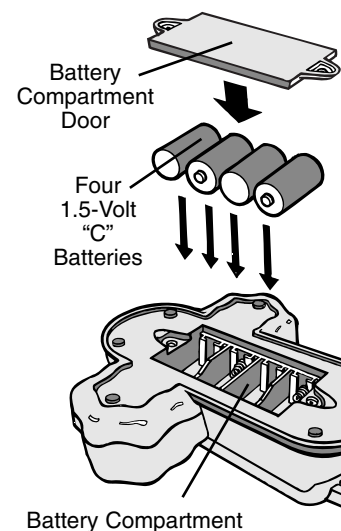

CAUTION: Changes or modifications to this product not expressly approved by party responsible for compliance may void the user's authority to operate the equipment. This product may stain or stick to some surfaces. Protect play area before use. Use damp cloth with warm water and soap to remove stains from clothing, carpeting and other surfaces that the item is likely to come in contact with. SAFETY TESTED. Remove all packaging material before giving the toy to your child. Please retain this information for future reference.

Free Manuals Download Website

<http://myh66.com>

<http://usermanuals.us>

<http://www.somanuals.com>

<http://www.4manuals.cc>

<http://www.manual-lib.com>

<http://www.404manual.com>

<http://www.luxmanual.com>

<http://aubethermostatmanual.com>

Golf course search by state

<http://golfingnear.com>

Email search by domain

<http://emailbydomain.com>

Auto manuals search

<http://auto.somanuals.com>

TV manuals search

<http://tv.somanuals.com>