

PX 200-II

Ideal for the urban commute - the closed, on-ear PX 200-II mini headphones provide excellent isolation to let you enjoy your music without being disturbed or disturbing others. These headphones come with a steel-reinforced headband for long lasting strength and durability. The integrated volume control on the cable is perfect for quick adjustments.



Features

- Closed design – blocks ambient noise
- Advanced Duofol™ transducer system pumps out rich, lifelike audio
- Single-sided cable eliminates tangles handling
- Integrated volume control
- Steel-reinforced headband enhances durability
- Fold and flip design collapses for compact travel
- Convenient carrying pouch included
- Optimized for portable audio – including MP3 players, iPod, iPhone, netbooks and other electronics with a headphone plug

Technical Data

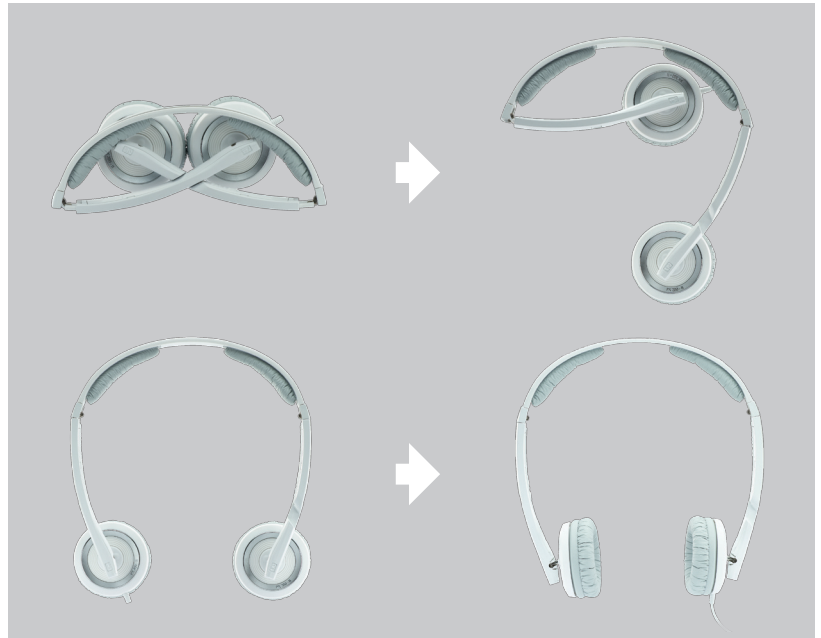

Model	PX 200-II	
Color	Black	White
Article Number	502817	502864
EAN No.	4044155044430	4044155045338
UPC No.	615104169234	615104170414
Transducer principle	Sealed (closed)	
Wearing style	On-the-ear	
Frequency response	10 - 21,000 Hz	
Impedance	32 Ω	
THD	<0.1% (1 kHz, 100 dB SPL)	
Sound pressure level (1 kHz / 1 V_{rms})	115 dB	
Weight	3.1 oz.	
Cable length	3.9 ft., single-sided	
Connector	1/8 in. (3.5 mm) stereo jack plug	
Content of Delivery	PX 200-II headphones with leatherette ear pads, storage pouch	
Packaging		
Packaging dimensions (W x H x D)	3.9 x 1.9 x 7.9 in.	
Weight (single)	0.4 lbs	
Master carton dimensions (W x H x D)	9 x 7 x 9.3 in.	
Weight (master carton)	3.5 lbs	
Units per master carton	6 units	

iPhone and iPod are trademarks of Apple Inc., registered in the U.S. and other countries.

Free Manuals Download Website

<http://myh66.com>

<http://usermanuals.us>

<http://www.somanuals.com>

<http://www.4manuals.cc>

<http://www.manual-lib.com>

<http://www.404manual.com>

<http://www.luxmanual.com>

<http://aubethermostatmanual.com>

Golf course search by state

<http://golfingnear.com>

Email search by domain

<http://emailbydomain.com>

Auto manuals search

<http://auto.somanuals.com>

TV manuals search

<http://tv.somanuals.com>