

Technical Bulletin

MAYTAG®

Type Policy Letter
√ Service Information

Attention Service Managers
√ Service and Parts Managers

Date: September 2005

No: TDL-0050B-B
ITDL-0020A-B
Page 1 of 4
Supersedes TDL-0050A-B
ITDL-0020-B

Models AAV1200AGW, AAV1200AJW, AAV1200AKW, AAV1200ARW, AAV1200AWW, AAV2200AGW, AAV2200AJW, AAV4200AGW, ALW221RJW, CAV1000AWW, CAV2000AGW, CAV2000AJW, CAV2000AKW, CAV2000AWQ, CAV2000AWW, CAV4000AWW, CW5000W, CW6000Q, CW6000W, CW7500Q, CW7500W, DLW231RAW, HAV1200ARW, HAV1200AWQ, HAV1200AWW, HAV2360AWW, HAV2460AWW, HAV2557AWW, HAV2558AWW, HAV3460AWW, HAV4200AKW, HAV4200ATW, HAV4200AWW, HAV4657AWW, JAV4200AWQ, LNC6760B71, LNC6762B01, LNC6762B71, LNC6764A71, LNC6766B71, MAV2200AJW, NAV3200AWW, NAV4200AGW, NAV4200AKW, PAV1200AWW, PAV2200AAW, PAV2200AGW, PAV2300AGW, PAV2300AWW, PAV2360AWW, PAV3200AAW, PAV3200AGW, PAV3240AWW, PAV3300AGW, PAV3300AKW, PAV3300AWW, PAV3360AWW, PAV4960AWW, PAV5000AWQ, PAV5000AWW, PAV5057AWW, PAV5058AWW, PAV5157AWW, PAV5158AWW, PAVT234AWW, PAVT244AWW, PAVT344AWW, PAVT444AWW

Brand
Admiral
Amana
Crosley
Jenn-Air
Magic Chef
Maytag
Maytag Performa

Product
Laundry

Issue Wash basket leans to one side, generally to the right as you face the washer during spin cycle.

Warranty Standard product manufacturing warranty applies.

Action Replace original base with Kit 12002701. The replacement of the base, new snubber, and six springs (included in the Kit) will reduce tub lean to an acceptable level.

NOTE: Some tub lean is normal.

1. Disconnect power supply to unit.
2. Tilt washer and remove belt from underside of base.
3. Remove back cover to access and remove drain hose clamps.

NOTE: There will be water remaining in the hose from the last cycle.



4. Remove three screws attaching drain pump to base.



5. Lift top cover by inserting a plastic putty knife between top cover and front panel. Press the locking clip to release the top cover. Repeat for both sides. Remove front panel by removing screws, one on each side of the top edge of front panel.



6. Remove motor ground wire, motor shield, and motor wire harness connector.

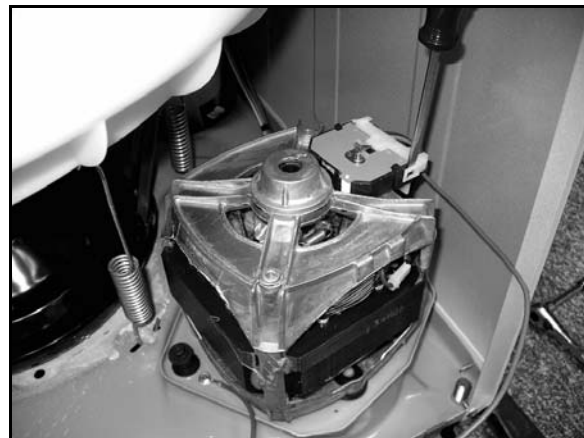

- Remove pressure switch hose from outer tub. Remove screws from sides and rear of unit around bottom, connecting cabinet to base. Remove cabinet from base and set aside. Be sure to lay down a protective pad before removing tub and transmission assembly from base. Remove tub springs using the spring removal tool; be careful not to let tub and transmission assembly tip over.



- Be sure to lay down a protective pad before removing tub and transmission assembly from base. Remove tub and transmission assembly, turn over and lay on protective pad.
- Remove dust cap, retaining ring, washer, cam, and pulley from bottom of transmission.

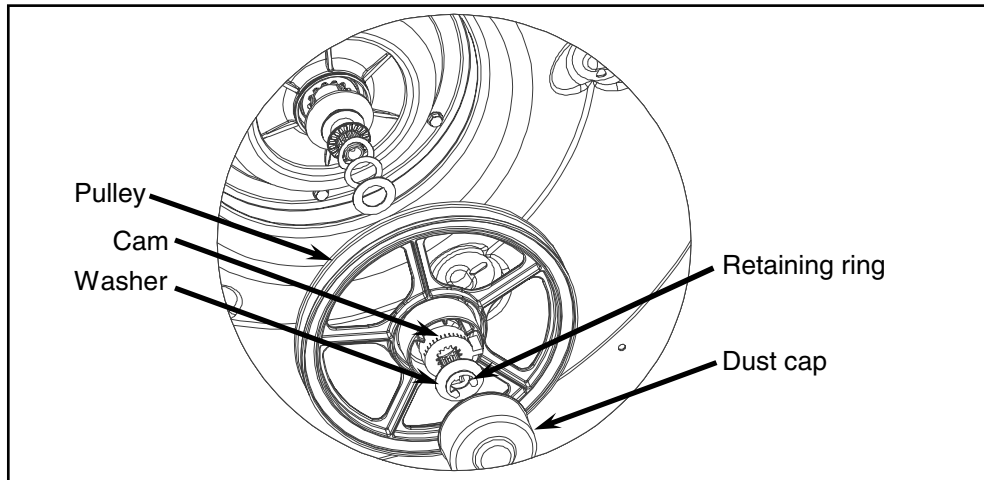

- Remove stator from transmission using Brake Removal Tool 12002012, refer to Service Manual for disassembly procedures. Remove old snubber from transmission.
- Be sure to wash hands to remove any dirt or grease before handling new snubber. Clean new snubber with alcohol before installing. Install new snubber. Insure snubber is centered.



12. Reinstall stator by locating the dimple on the stator, and tightening the screw next to the dimple first. Next tighten the screw 180 degrees across from the dimple. Install and tighten remaining screws. Reinstall pulley, cam, washer, retaining ring, and dust cap.

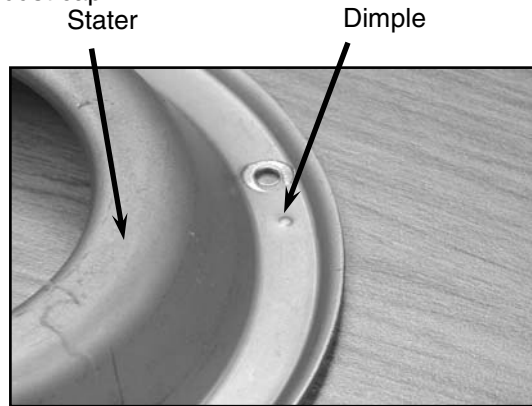

13. Turn new base upside down and apply grease at bottom of the spring hole pockets to eliminate noise between spring and base interaction.

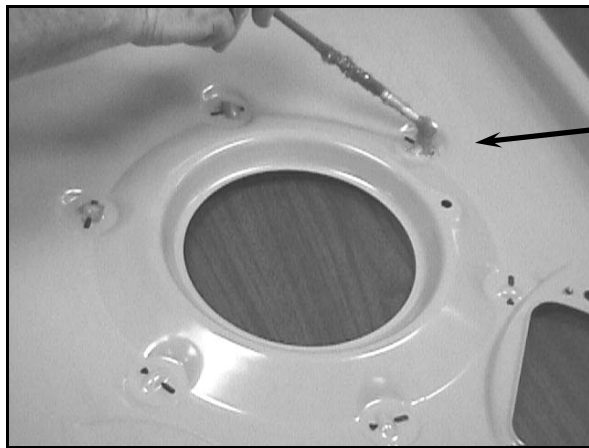

Apply grease at bottom of spring hole pockets.

14. Clean the dome area of new base with alcohol then apply corn starch.

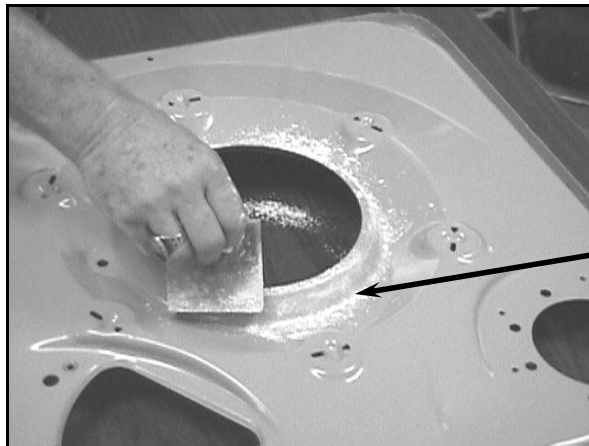

Apply corn starch to new base on dome area after cleaning with alcohol.

15. Reinstall motor and pump to new base.
16. Transfer transmission and outer tub onto new base. Use spring tool 22002922 to avoid over stretching the springs.
17. Transfer cabinet shell onto new base and reassemble washer. Be sure to reattach pressure switch hose to back of tub, drain pump hoses with clamps to drain pump, and wire harness to motor. Check all hoses and wires to make sure they are secure.
18. Test washer.

Free Manuals Download Website

<http://myh66.com>

<http://usermanuals.us>

<http://www.somanuals.com>

<http://www.4manuals.cc>

<http://www.manual-lib.com>

<http://www.404manual.com>

<http://www.luxmanual.com>

<http://aubethermostatmanual.com>

Golf course search by state

<http://golfingnear.com>

Email search by domain

<http://emailbydomain.com>

Auto manuals search

<http://auto.somanuals.com>

TV manuals search

<http://tv.somanuals.com>