



BOSCH



Washing machine

WAXH2M71NL

[NL] User manual and
installation instructions

Refer to the Digital User's Guide for more information.



Table of contents

1 Safety.....	4	6 Before using for the first time	21
1.1 General instructions	4	6.1 Starting a wash cycle without laundry.....	21
1.2 Destination of the device rate	4	7 Display	22
1.3 Restriction of users	4	8 Buttons	24
1.4 Safe installation.....	5	9 Programs	26
1.5 Safer use	7	10 Accessories.....	30
1.6 Safe cleaning and maintenance hold	9	11 Laundry.....	30
2 Avoiding material damage	11	11.1 Preparing the laundry.....	30
3 Environmental protection and saving ring.....	12	12 Detergent and fabric care ginger.....	31
3.1 Disposing of the packaging	12	13 The Ministry at its core.....	31
3.2 Saving on energy and resources	12	13.1 Switching on the appliance	31
3.3 Energy Saving Mode	13	13.2 Set program	31
4 Set-up and connection	13	13.3 Adjust program settings	31
4.1 Unpacking the device	13	13.4 Filling the drum with detergent good	31
4.2 Package contents.....	13	13.5 Inserting the dosing aid for liquid detergent	32
4.3 Installation site requirements	13	13.6 Using the dosing aid for liquid detergent	32
4.4 Removing transport locks	14	13.7 Dosing detergent and care agent	32
4.5 Removing transport reinforcements	15	13.8 Starting the program ...	33
4.6 Connecting the device	16	13.9 Soaking the laundry	33
4.7 Adjusting the device	17	13.10 Adding laundry	33
4.8 Connecting the appliance electrically.....	17	13.11 Program cancel.....	33
5 Getting to know your device.....	19	13.12 Resume program at rinse hold.....	33
5.1 Device	19	13.13 Taking out the laundry	33
5.2 Detergent drawer.....	20	13.14 Switching off the appliance	33
5.3 Control panel.....	20		

14 Child Lock	34	20 Customer Service.....	53
14.1 Activating child lock	34	20.1 Product number (E no.) and production number (FD)	54
14.2 Deactivating the child lock.....	34	20.2 AQUA-STOP guarantee	54
15 Home Connect	34	21 Consumption values	55
15.1 Device with WLAN home network (WiFi) with WPS connect function.....	35	22 Technical data.....	55
15.2 Connecting a device to a WLAN home network (WiFi) without WPS function.....	35	23 Declaration of Conformity.....	56
15.3 Device with the Ho- connect me Connect app ...	36		
15.4 Activating WiFi on the device.....	36		
15.5 Deactivating WiFi on the device	36		
15.6 Resetting the device's network settings	37		
15.7 Remote start.....	37		
15.8 Remote Diagnosis.....	37		
15.9 Protection of personal data	37		
16 Basic settings	38		
17 Cleaning and maintenance	38		
17.1 Cleaning the drum	38		
17.2 Cleaning the detergent drawer	38		
17.3 Cleaning the drain pump.....	39		
17.4 Cleaning the inlet opening in the rubber sleeve.....	42		
18 Troubleshooting	43		
18.1 Emergency release.....	52		
19 Transporting, Storing and drain.....	52		
19.1 Disassembling the device	52		
19.2 Transport locks place	52		
19.3 Restart device use	52		
19.4 Disposal of your old appliance	53		



1 Safety

Observe the following safety instructions.

1.1 General instructions



Read this manual carefully. Keep the operating instructions and product information for future reference.

for use or for subsequent owners.

Do not connect the device in case of transport damage.

1.2 Destination of the device

Only use the device to wash machine-safe textiles and wool by hand

wash care label.

with tap water and commercially available washing machine detergents and maintenance products.

for domestic use and in enclosed spaces within the living environment.

to an altitude of 4000 m above sea level.

1.3 Restriction of users

This appliance can be used by children aged from 8 years and above and persons with reduced physical, sensory or mental capabilities or lack of experience and/or knowledge if they have been given supervision or instruction concerning use of the appliance in a safe way and understand the resulting hazards. Children must not play with the appliance.

Cleaning and user maintenance shall not be made by children unless they are supervised.

Make sure that children up to 3 years old and pets cannot reach the device.

1.4 Secure installation

Observe the safety regulations when installing the device.

WARNING – Risk of electric shock!

Improper installations are dangerous.

- ▶ Only connect and use the device in accordance with the information on the type plate.
- ▶ Only connect the device to a mains supply with alternating current via a properly installed earthing socket.

- ▶ The protective earth system of the electrical house installation must be installed in accordance with the electrical engineering regulations. The installation must have a sufficiently large conductor diameter.

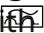
- ▶ When using an earth leakage circuit breaker, only use a type marked with .
- ▶ Never power the device via an external switching device, e.g. a time switch or remote control.
- ▶ When the device is installed, the mains plug of the mains connection cable must be freely accessible or, if free access is not possible, an all-pole disconnecting device must be installed in the permanently installed electrical system in accordance with the installation instructions.
- ▶ When setting up the device, make sure that the power cord is not pinched or damaged.
Damaged power cord insulation is dangerous.
- ▶ Never bring the connecting cable into contact with hot appliance parts or heat sources.
- ▶ Never bring the power cable into contact with sharp points or edges.
- ▶ Never kink, pinch or alter the power cord.

WARNING – Risk of fire!

Using an extended power cord and unauthorized adapters is dangerous.

- ▶ Do not use extension cords or multiple sockets.

- ▶ If the power cord is too short, contact customer service.
- ▶ Only use adapters approved by the manufacturer.

⚠ WARNING – Risk of injury!

The heavy weight of the device can cause injuries when lifted.

- ▶ Do not lift the device alone.

If this appliance is installed incorrectly in a washer-dryer column, the installed appliance may fall.

- ▶ Stack the dryer on top of a washing machine only with the dryer manufacturer's connection kit. No other method of installation is allowed.
- ▶ Do not install the appliance in a washer-dryer column if the dryer manufacturer does not offer a suitable connection set.
- ▶ Do not install appliances from different manufacturers and with different depths and widths in a washer-dryer column.
- ▶ Do not set up a washer-dryer column on a platform, the devices can tilt.

⚠ WARNING – Risk of suffocation!

Children can pull packing material over their head and become entangled and suffocate.

- ▶ Keep packaging material away from children.
- ▶ Do not let children play with packaging material.

⚠ CAUTION – Risk of injury!

The device may vibrate or move during operation.

- ▶ Set up the device on a clean, flat and solid surface.
- ▶ Level the appliance using the appliance feet and a spirit level.

There is a tripping hazard with incorrectly laid hoses and mains connection cables.

- ▶ Lay the hoses and connection cables in such a way that they cannot be tripped over.

If the appliance is moved by protruding parts, such as the loading door, the parts can break off.

- ▶ Do not move the appliance by protruding parts.

⚠ CAUTION – Risk of cutting!

Sharp edges on the device can lead to cuts if touched.

- ▶ Do not touch the device on sharp edges.
- ▶ Use protective gloves when installing and transporting the device.

1.5 Safer use

⚠ WARNING – Risk of electric shock!

A damaged appliance or power cord is dangerous.

- ▶ Never use a damaged device.
 - ▶ Never pull on the power cord to disconnect the device from the power supply. Always pull the plug on the power cord.
 - ▶ If the appliance or the mains cable is damaged, immediately unplug the mains cable from the socket or switch off the fuse in the fuse box and close the tap.
 - ▶ Contact customer service. → *Page 53*
- Penetrating moisture can cause an electric shock.
- ▶ Only use the device in closed rooms.
 - ▶ Never expose the device to excessive heat and humidity.
 - ▶ Do not use a steam cleaner, pressure washer, hoses or nozzles to clean the appliance.

⚠ WARNING – Risk of health hazard!

Children can lock themselves in the appliance and endanger their lives.

- ▶ Do not install the appliance behind a door that blocks or prevents the opening of the appliance door.

- ▶ In the case of discarded appliances, remove the plug of the mains cable from the socket, then cut the mains cable and damage the lock of the appliance door so that the appliance door no longer closes.

⚠ WARNING – Risk of suffocation!

Children can inhale or swallow small parts and choke.

- ▶ Keep small parts away from children.
- ▶ Do not allow children to play with small parts.

⚠ WARNING – Risk of poisoning!

Detergents and care products can lead to poisoning if ingested.

- ▶ In case of accidental ingestion, seek medical advice.
- ▶ Keep detergents and care products out of the reach of children.

⚠ WARNING – Risk of explosion!

If laundry has been pretreated with cleaning agents containing solvents, this can lead to an explosion in the appliance.

- ▶ Rinse pre-treated laundry thoroughly with water before washing.

⚠ CAUTION – Risk of injury!

The cover plate may break when climbing or clambering on the device.

- ▶ Do not climb or scramble on the device.
The appliance may tip over when sitting or leaning on the open door.
- ▶ Do not sit or lean on the appliance door.
- ▶ Do not place any objects on the appliance door.
Reaching into the rotating drum can cause injury to hands.

- ▶ Wait for the drum to come to a complete stop before reaching inside the drum with your hand.

⚠ CAUTION – Risk of burns!

The soap gets hot when washing at high temperatures.

- ▶ Do not touch the hot soapy water.

⚠ CAUTION – Risk of chemical burns!

When opening the detergent drawer, detergent and care products may splash out of the appliance. Contact with eyes or skin may cause irritation.

- ▶ In case of contact with detergents or care products, rinse eyes or skin thoroughly with clean water.
- ▶ In case of accidental ingestion, seek medical advice.
- ▶ Keep detergents and care products out of the reach of children.

1.6 Safe cleaning and maintenance

Observe the safety instructions when cleaning and maintaining the device.

⚠ WARNING – Risk of electric shock!

Improper repairs are dangerous.

- ▶ Only trained specialist personnel may carry out repairs on the device.
- ▶ Only original spare parts may be used for repair of the device.
- ▶ If the power cord of this appliance is damaged, it must be replaced by the manufacturer, its service agent or a similarly qualified person in order to avoid a hazard. Penetrating moisture can cause a shock.
- ▶ Do not use a steam cleaner, pressure washer, hoses or nozzles to clean the appliance.

⚠ WARNING – Risk of injury!

The use of non-original spare parts and non-original accessories is dangerous.

- ▶ Only use original spare parts and original accessories from the manufacturer.

 **WARNING** – Risk of poisoning!

Toxic fumes can be generated when using solvent-based cleaning agents.

▶ Do not use solvent-based cleaning agents.

2 Material damage avoid

Read this instruction to avoid damage and damage to the device.

PAY ATTENTION!

Incorrect dosage of fabric softeners, detergents, care products and cleaning agents can affect the functioning of the appliance.

- ▶ Follow the manufacturer's dosing recommendations.

Exceeding the maximum load quantity affects the operation of the appliance.

- ▶ Observe and do not exceed the maximum load for each programme.

→ "Programs", Page 26

The device is secured for transport with transport locks. Transport locks that have not been removed can lead to material damage and damage to the device.

- ▶ Before commissioning, remove and store all transport locks completely.

- ▶ Before each transport, install all transport locks completely to avoid transport damage.

Improper connection of the water inlet hose can lead to material damage.

- ▶ Tighten the screw connections on the water supply hand-tight.
- ▶ It is best to connect the water inlet hose directly to the water tap without additional connecting elements such as adapter, extension, valve or the like.
- ▶ Make sure that the valve housing of the water inlet hose is installed without contact with the environment and that it is not exposed to external forces.

- ▶ Make sure that the internal diameter of the water tap is at least 17 mm.
- ▶ Make sure that the thread length on the connection to the water tap is at least 10 mm.

Water pressure that is too low or too high can interfere with the appliance function.

- ▶ Make sure that the water pressure on the water supply system is at least 100 kPa (1 bar) and at most 1000 kPa (10 bar).
- ▶ If the water pressure exceeds the specified maximum value, a pressure reducing valve must be installed between the drinking water connection and the hose set of the device.
- ▶ Do not connect the appliance to the mixer tap of a pressureless water heater or boiler.

Modified or damaged water hoses can lead to material damage and damage to the device.

- ▶ Never kink, pinch, modify or cut water hoses.
- ▶ Only use supplied water hoses or original spare hoses.

- ▶ Reuse never used water hoses.

Use with contaminated or too hot water can cause material damage and damage to the device.

- ▶ Operate the device only with cold tap water.

Unsuitable cleaning agents can damage the surfaces of the device.

- ▶ Do not use sharp or abrasive cleaning agents.
- ▶ Do not use strong alcohol-based cleaning agents.
- ▶ Do not use hard scouring or dishwashing sponges.

- ▶ Clean the device only with water and a soft, damp cloth.
- ▶ Remove all detergent residues, spray mist residues or residues immediately upon contact with the appliance.

3 Environmental protection and savings

3.1 Disposing of the packaging

The packaging materials are environmentally friendly and can be reused.

- ▶ Dispose of the individual components separately according to type.

3.2 Energy- and resource-efficient

If you follow these directions, your device will use less power and water.

Use programs with low temperatures and longer washing times and use the maximum load capacity.

- a The energy consumption and water consumption are the most efficient.

Use economical program setting.

- a When you set the program
For a programme, the display shows the expected consumption.

Dose detergent according to the degree of soiling of the laundry.

- a For a light to normal degree of contamination, a small amount of detergent is sufficient. Follow the detergent manufacturer's dosing recommendations.

Reduce washing temperature for lightly and normally soiled laundry.

- a At low temperatures, it consumes device less energy. For light to normal soiling, lower temperatures than those stated on the care label are also sufficient.

Set the maximum speed if the laundry is subsequently to be dried in the tumble dryer.

- a Dryer laundry shortens the programme time during drying and reduces energy consumption. With a higher spin speed, the residual moisture in the laundry decreases and the spinning sound volume increases.

Wash laundry without prewash.

- a Washing with prewash extends program duration and increases energy and water consumption.

The device has automatic load matching.

- a The automatic load matching optimally adapts the water consumption and the program duration to the type of textile and the load capacity.

3.3 Energy Saving Mode

If you do not operate the device for a long time, it automatically switches to energy-saving mode.

The energy saving mode is exited when you operate the device again.

If you do not operate the device further, it will switch off.

Remark: The device does not turn off automatically when WiFi is activated.

4 Set up and connect

4.1 Unpacking the device

PAY ATTENTION!

Objects that remain in the drum and that are not intended for use with the device can lead to material and device damage.

- ▶ Before use, remove all these items and the supplied accessories from the drum.
 1. Completely remove packaging material and protection from the device.
→ *"Disposal of the packaging", Page 12.*
 2. Check the device for visible damage.
 3. Open the appliance door.
→ *"The Ministry in essence", Page 31*
 4. Remove the accessories from the drum.
 5. Close the appliance door.

4.2 Package contents

After unpacking, check all parts for transport damage and the completeness of the delivery.

PAY ATTENTION!

Use with incomplete or defective accessories may impair the operation of the device or cause material damage and damage to the device.

- ▶ Do not use the device with incomplete or defective accessories.
- ▶ Replace the accessories before using the device.
→ *"Accessories", Page 30*

Remark: The device has been checked at the factory for correct operation. Water stains may remain in the device. The stains disappear after the first wash.

The delivery consists of:

- Washing machine
- s Accompanying documents
- Transport protections
→ *"Remove transport locks run", Page 14*
- s cover caps
- s Elbow for attaching the water drain hose

4.3 Installation site requirements



WARNING

Risk of electric shock!
The device contains live parts.
Touching live parts is dangerous.

- ▶ Do not use the appliance without a cover.

NL Set up and connect

⚠ WARNING

Risk of injury!



When used on a plinth, the device can tip over.

- ▶ The device feet for commissioning on a plinth must be absolutely with the fixings
→ *Page 30* from the manufacturer settle.

PAY ATTENTION!

The appliance may contain residual water. If you tilt the appliance more than 40°, residual water may leak out.

- ▶ Carefully tilt the device.

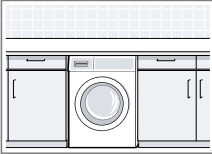
installation site	To demand
<p>Plinth</p> 	<p>The device with locking lips → <i>Page 30</i> confirm.</p>
<p>Floor with wooden beams</p> 	<p>Place the device on a wa-resistant wooden plate (thick-too minimal 30mm) which screwed to the floor.</p>
<p>kitchen</p> 	<p>The device al-borrow under a continuous work place sheet, that fixed with the adjacent cabinet is connected Pine tree. Required niche width: 60 cm.</p>

installation site

To demand

on a wall

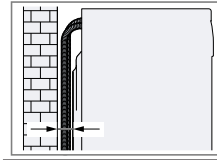

no snakes between wall and device clamping man.

PAY ATTENTION!

Residual water can freeze. Freezing residual water can damage the appliance and frozen hoses can burst.

- ▶ Do not place the device in areas prone to frost or outdoors.

4.4 Removing transport locks

The device is secured for transport with transport locks at the rear of the device.

Remark: Keep the screws of the transport locks and the sleeves for later transport
→ *Page 52*.

1. Pull the hoses out of the holders.

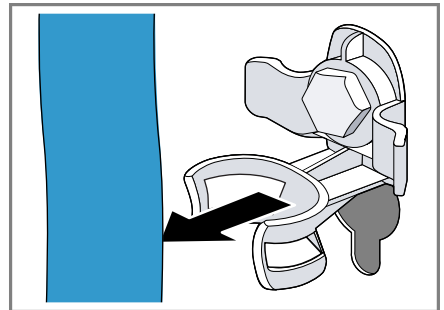

2. Loosen and remove all bolts of the 4 transport locks with a SW13 open-end wrench^①
②.



3. Pull the mains connection cable out of the holder.

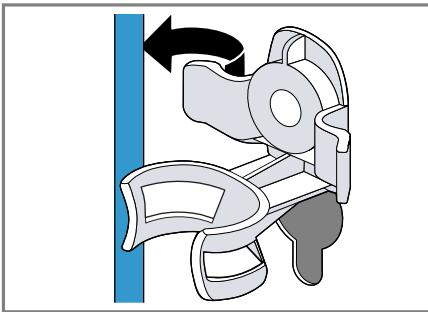

4. Remove the 4 sleeves.

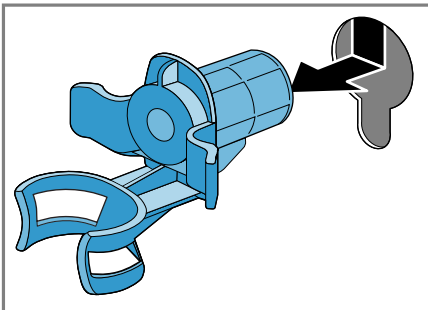

5. Install the 4 cover caps.

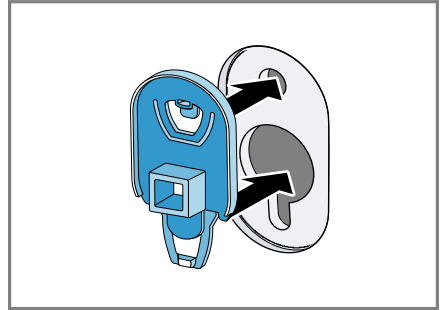

6. Push the 4 cover caps down.

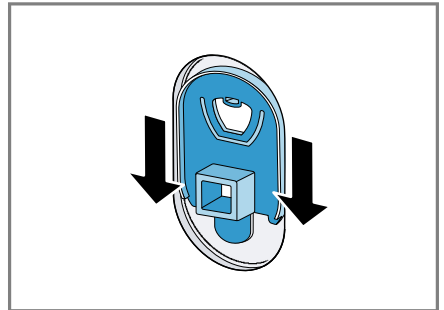

4.5 Removing transport reinforcements

1. Loosen and remove the screws of the vertical transport reinforcements with a T20 screwdriver.

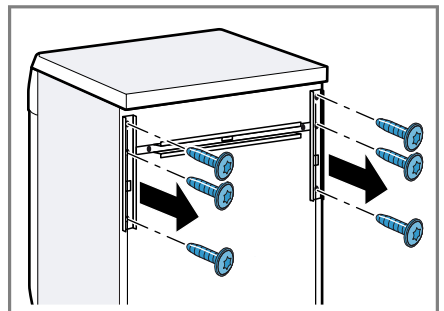

NL Set up and connect

2. Remove the transport reinforcements.

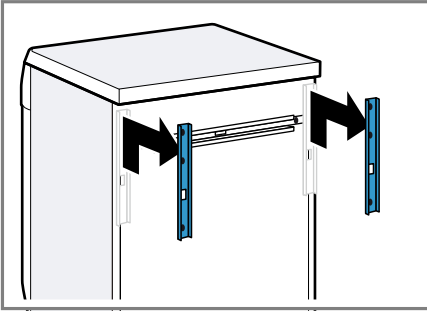

3. Loosen and remove the screws of the horizontal transport reinforcement with a T20 screwdriver.

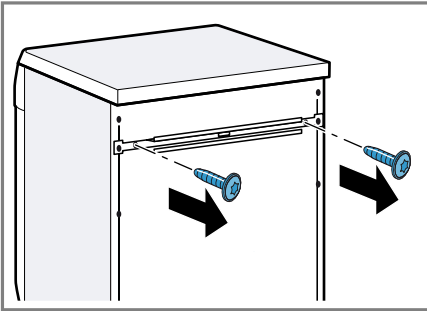

4. Remove the transport reinforcement.

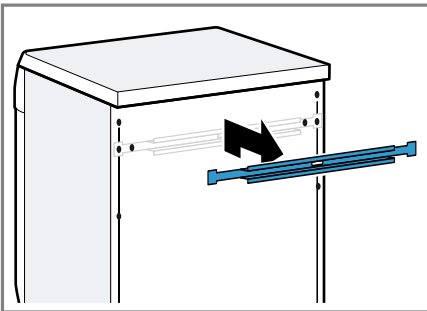

4.6 Connecting device

Connect water supply hose

⚠ WARNING
Risk of electric shock!
The device contains live parts.
Touching live parts is dangerous.

► Do not immerse the electric Aquastop valve in water.

1. Connect the water inlet hose to the tap (26.4 mm = 3/4").

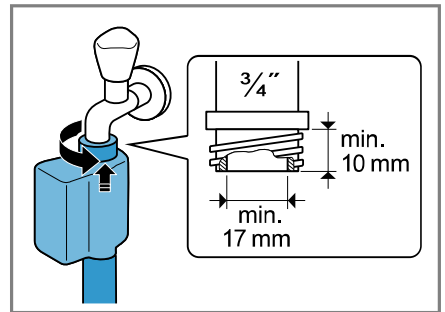

2. Open the tap carefully and check that the connections are tight.

Water drainage connection types

The information will help you connect this appliance to the water outlet.

PAY ATTENTION!

When draining, the water drain hose is under pressure and can come loose from the installed connection position.

► Secure the water drain hose against unintentional disconnection.

Remark: Observe the pumping heights.
The maximum pumping height is 100 cm.

Set up and connect NL

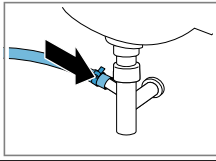

The connection position
tie with a hose clamp
(24-40 mm) bore
gene.

washbasin

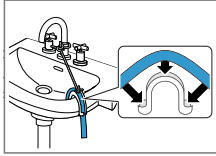

the water drainage
feeding hose with a bend
fixate and
gene.

plastic stand
pipe with rubber
run muff or a
floor drain

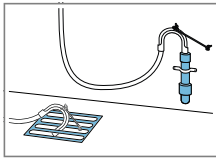

the water drainage
feeding hose with a bend
fixate and
gene.

4.7 Adjusting the device

To reduce noises and vibrations and to prevent the device from walking, place the device horizontally.

1. Loosen the lock nuts with a SW17 open-end wrench.

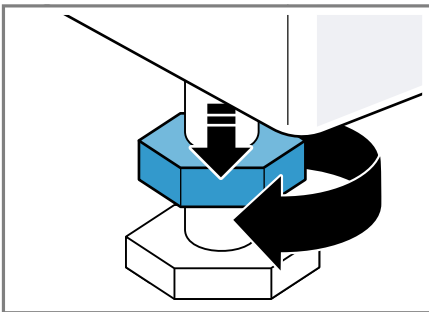

2. To adjust the appliance, turn the appliance feet. Check the horizontal adjustment of the appliance with a spirit level.

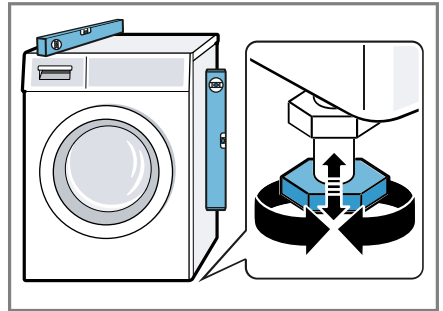

All appliance feet must be firmly planted on the floor.

3. Tighten the lock nuts against the housing with an open-end wrench SW17 hand-tight.

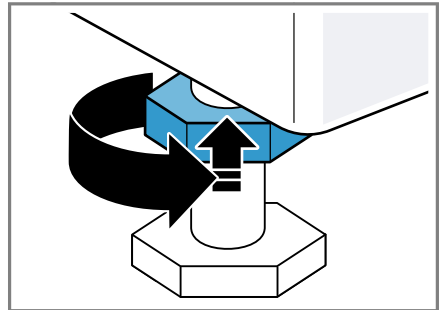

Hold the appliance foot while doing so and do not adjust the height.

4.8 Connecting the appliance electrically

1. Insert the mains plug of the mains cable of the device into a socket in the vicinity of the device.

The connection data of the device can be found in the technical data
→ Page 55.

NL Set up and connect

2. Check the mains plug for tightness.

5 Getting to know your device

5.1 Device

Here you will find an overview of the components of your device.

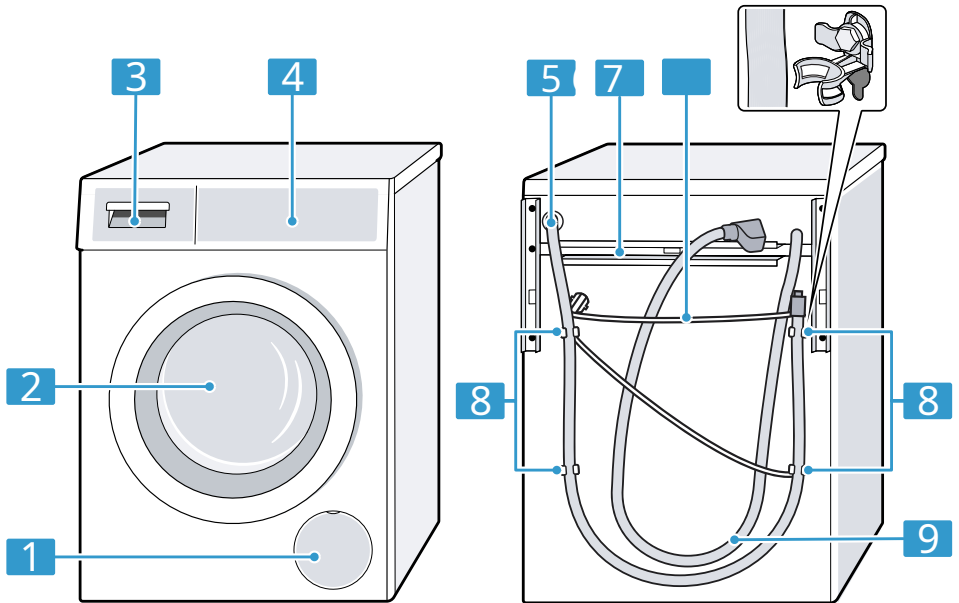

Depending on the device type, details in the image may differ, e.g. color and shape.

1	Service valve and pump → <i>Page 39</i>	7	Mains connection cable → <i>Page 17</i>
2	Door	8	Transport protections → <i>Page 14</i>
3	Detergent drawer → <i>Page 20</i>	9	Water supply hose → <i>Page 16</i>
4	Control panel → <i>Page 20</i>		
5	Water drain hose → <i>Page 16</i>		
6	Transport reinforcements → <i>Page 15</i>		

5.2 Detergent drawer

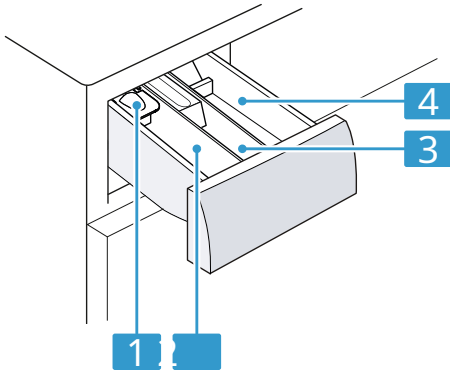

-
- 1** Dosing aid for liquid detergent
→ "Dosing aid for liquid place detergent",
Page 32

 - 2** Detergent dispenser II:
s Detergent for the main
used to be,
s softener
s Bleach
s Stain salt

 - 3** Compartment :⊗
s fabric softener
s Liquid starch
s Impregnating agent

 - 4** Detergent dispenser I:
s Detergent for the pre-
used to be
s Hygiene detergent
-

5.3 Control panel

You can set all functions of your device and obtain information about the operating status via the control panel.

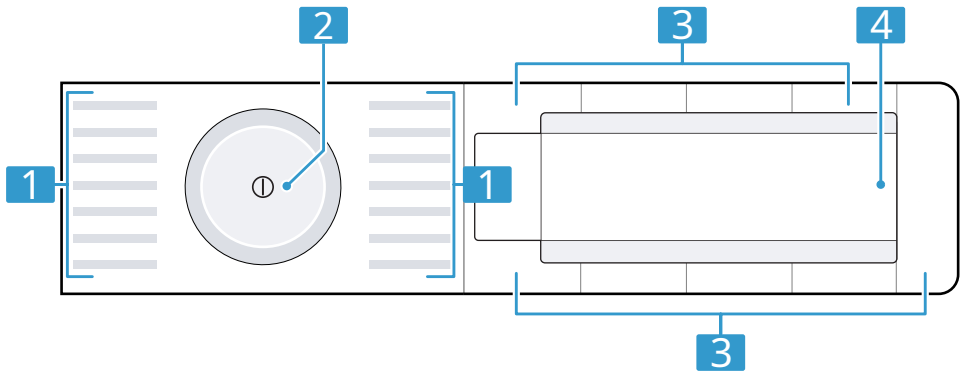

-
- 1** Programs

 - 2** Program selector
→ Page 31

 - 3** Buttons → Page 24

 - 4** Display → Page 22
-

6 Before first use

Prepare the device for use.

6.1 Start the wash cycle without laundry

Your device has been thoroughly checked before leaving the factory. To remove any residual water, wash without any laundry the first time.

1. Press . ①

The power-on process takes a few seconds.

2. The program Cleaning the drumSet up.
3. Close the door.
4. Pull out the detergent drawer.
5. Fill powder detergent into compartment II.

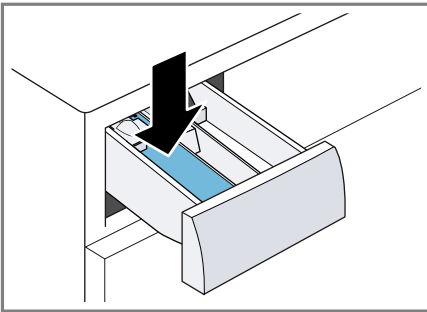

To avoid foaming, use only half the amount recommended by the detergent manufacturer for light soiling. Do not use wool or delicate detergent.

6. Slide the detergent drawer into the appliance.
 7. Press Start/Refill to start  to the program.
- a The display shows the remaining program duration.

- a After the program end, it shows display: -0-.
8. Start the first wash cycle or press to ① switch off the appliance.

→ "The Ministry in essence",
Page 31





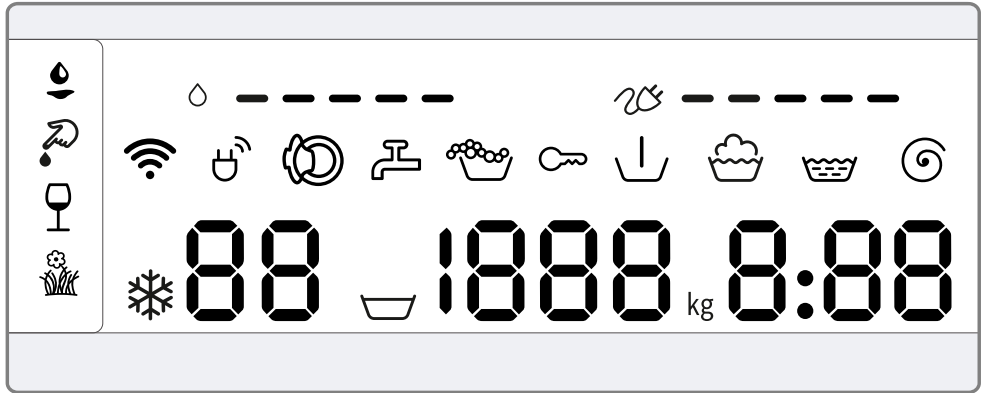







7 Display

Op the display shows the current setting values, options or instructions. song lyrics.









Indication	name	More information
0:40 ¹	Program duration / remaining time of the program	Approximate expected program duration or time remaining in the program.
10h ¹	Ready in time	→ "Buttons", Page 24
▽ - 1600	Spin speed tal	Set spin speed in rpm. → "Buttons", Page 24 0: without final spin, only drain
		▽: Rinse hold, without drain
* - 90	Temperature	Set temperature in °C. → "Buttons", Page 24 * (cold)
↓	prewash	Program status
🧺	Wash	Program status
🧺	To rinse	Program status
🌀	Centrifuge	Program status
-P-	Pause	Program status
- 0-	Program end	Program status

¹ Example

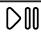
Indication	name	More information
	Child lock	s lights up: the child lock is activated. s flashes: the child lock is activated and the device was operated. → <i>"Deactivate child lock", page 34</i>
	Blood	The stain type is activated. The
	Grass	stain type is activated. The stain
	Red wine	type is activated. The stain type
	Butter/salad oil	is activated.
	Energy consumption	Energy consumption for the set programme. S — : lower energy consumption S ————— : higher energy consumption
	water consumption	Water consumption for the set program. S — : lower water consumption S ————— : higher water consumption
	WiFi	s lights up: the appliance is connected to the home network work connected. s flashes: the device is trying to connect thing to do with the home network. → <i>"Home Connect", page 34</i>
	Energy manager	The device is connected to the Smart Energy System (energy manager). Connect the device to the energy manager
	Foam detection	The appliance has detected too much foam.
	Door	The door is locked and can be opened.
	Crane	s No water pressure. s The water pressure is too low.
E:35 / -10 ¹	Wrong	Error code, error indication, signal.
¹ Example		

8 Tests

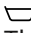

The selection of the program settings depends on the set program. You can see the selection options for each program in the overview for .

Knob	Choise	More information
Start/Refill 	s start s Cancel s pause	Start, cancel or pause program.
SpeedPerfect	s activate s deactivate	Activate or deactivate reduced program duration. Remark: The energy consumption is higher. This does not affect the washing result.
Intensive Plus 	s activate s deactivate	Activate or deactivate washing with extended time. The program duration is extended up to 30 minutes. Suitable for heavily soiled laundry.
Anti Stains	Multiple se- reading	Choose the stain type. The temperature, the drum movement and the soaking time are adapted to the type of stain.
- Ready in +	up to 24 hours	Capture the program end. The program duration is already included in the set number of hours. After the program has started, the program duration is displayed.
temp. °C	 - 90 °C	Adjust the temperature in °C.
Spin speed	 - 1600	Adjust the spin speed or  (rinse hold). The selection turns the water not drained at the end of the wash cycle and the spin deactivated. The laundry remains in the rinse water.
 (mains switch)	s Switch s Switch off	Turn the device on or off.
Control via App 	s activate s deactivate s Home Connect Open menu	→ "Remote start", Page 37

Knob	Choose	More information
childproof lock 3 sec.	s activate s deactivate	→ <i>"Child Lock", Page 34</i>
Centrifugal heid	Multiple se- reading	Basic settings
prewash	s activate s deactivate	Activate or deactivate prewash, e.g. for washing heavily soiled laundry.
Intensive rinse	s Activate s Deactivate	Activate or deactivate an extra rinse cycle. Recommended for particularly sensitive skin or in areas with very soft water.

9 Programs

Remark: The care labels on the laundry give you additional information on program selection. Care instructions on care labels

Program	Description	Max. belathing (kg)
Cotton	Wash hard-wearing fabrics made of cotton, linen and blended fabrics. Also suitable as a shortened program for normally soiled laundry if you activate SpeedPerfect. Program setting: s max. 90 °C s max. 1600 rpm	10.0 5.0 ¹
Eco 40-60	Wash cotton, linen and blended fabrics. Remark: Textiles that can be washed at 40 °C to 60 °C according to the  symbol,  can be washed together. The wash result corresponds to the best possible wash result class and complies with legal regulations. The wash result corresponds to the best possible wash result class and complies with legal regulations. For this programme, the washing temperature is automatically adjusted depending on the load capacity in order to achieve optimum energy efficiency with the best possible washing result. The washing temperature cannot be changed. Program setting: Remark: The temperature is not adjustable in this program and is set automatically. s max. - °C s max. 1600 rpm	10.0
wrinkle recovery loin	Wash textiles made of synthetic and blended fabrics. Program setting: s max. 60 °C s max. 1200 rpm	4.0
Fast mix	Wash textiles made of cotton, linen, synthetic materials and blended fabrics. Suitable for lightly soiled laundry.	4.0

¹ SpeedPerfect activated

Program	Description	Max. belathing (kg)
	<p>Program setting: s max. 60 °C s max. 1600 rpm</p>	
Delicate silk	<p>Wash delicate, washable textiles made of silk, viscose and synthetics. Use a detergent for delicates or silk. Remark: Wash particularly sensitive textiles or textiles with hooks, eyes or brackets in a laundry net. Program setting: s max. 40 °C s max. 800 rpm</p>	2.0
 Wool	<p>Wash by hand or machine washable textiles made of wool or with a high wool content. To avoid shrinkage of the laundry, the drum with textiles moves especially gently with long pauses. Use a wool detergent. Program setting: s max. 40 °C s max. 800 rpm</p>	2.0
To rinse	<p>Rinse with subsequent centrifugation and drain the water. Program setting: max. 1600 rpm</p>	-
Centrifuge/ Drain	<p>Centrifuge and drain water. If you only want to drain the water, activate 0. The laundry is not spun. Program setting: max. 1600 rpm</p>	-
Hygiene Plus	<p>Wash hard-wearing fabrics made of cotton, linen and blended fabrics. Suitable for allergy sufferers and with high hygiene requirements. Remark: When the set temperature is reached, it remains constant throughout the washing process. Program setting: s max. 60 °C s max. 1600 rpm</p>	6,5

¹ SpeedPerfect activated

Program	Description	Max. belating (kg)
shirts	<p>Wash non-iron shirts and blouses made of cotton, linen, synthetic and blended fabrics.</p> <p>Remark: Wash shirts and blouses made of silk or delicate materials with the Delicates/Silk programme.</p> <p>Program setting: s max. 60 °C s max. 800 rpm</p>	2.0
Sport	<p>Wash sports and leisure textiles made of synthetic, microfibre and fleece.</p> <p>Use a detergent for sports textiles. Do not use fabric softener.</p> <p>Tip: Wash heavily soiled laundry with the Easy-Care programme.</p> <p>Program setting: s max. 40 °C s max. 800 rpm</p>	2.0
Jeans/Dark <small>used to be</small>	<p>Wash dark and colour-intensive cotton textiles and easy-care textiles, e.g. jeans. Wash the laundry inside out.</p> <p>Use a liquid detergent. Program setting: s max. 40 °C s max. 1200 rpm</p>	4.0
drum cleaning gene	<p>Cleaning and maintenance of the drum. Use the program in the following cases: s before first uses with frequent washing with a washing temperature of 40°C and below s after a long absence</p> <p>Use a powder detergent or a detergent containing bleach. Halve the amount of detergent to avoid foaming.</p> <p>Do not use fabric softener. Do not use wool, delicates or liquid detergents. Remark: If you have not used a program with a temperature of 60 °C or higher for a long time, the drum cleaning indicator flashes as a reminder.</p>	-

¹ SpeedPerfect activated

Program	Description	Max. belathing (kg)
Super Short 15/30 min.	<p>Wash cotton, synthetic and blended fabrics.</p> <p>Short program for lightly soiled small items of laundry.</p> <p>The program duration is approx. 30 minutes. If you want to shorten the program duration to 15 minutes, activate SpeedPerfect. The maximum load capacity is reduced to 2.0 kg.</p> <p>Program setting: s max. 40 °C s max. 1200 rpm</p>	4.0
¹ SpeedPerfect activated		

10 Accessories

Gonly use original accessories. These are adapted to the device.

	Usage	Order number
Extension water supply feeding hose	Cold water or Aquastop water supply hose lengthen (2.50 m).	WMZ2381
Mounting brackets	Improve the firmness of the device.	WMZ2200
Liquid Detergent Inserts	Dispense liquid detergent.	00605740
Elevation	The device higher places so that it is easily filled and can be emptied.	WMZPW20W

1 Laundry

Remark: You can find more information in the digital operating instructions by scanning the QR code in the table of contents or on www.bosch-home.com.

11.1 Preparing the laundry

PAY ATTENTION!

Objects left in the laundry can damage the laundry and the drum.

- ▶ Before use, remove all objects from the pockets of the laundry.
- ▶ To protect your appliance and the laundry, prepare the laundry.
 - Empty pockets
 - Brush sand out of all covers and pockets
 - Close duvet covers and pillowcases
 - Close zippers, Velcro fasteners, hooks and eyes

- Tie fabric belts, apron straps, etc. together, or use a laundry bag
- Tie together long drawstrings and cords with fixed ends in hoods or trousers
- Remove curtain rollers and lead laces or use a laundry net
- use a laundry net for small items of laundry, e.g. children's socks
- some stubborn, dried-on stains can be removed by washing several times
- wash large and small items of laundry together
- do not rub in fresh stains, but dab off with soapy water
- Unfold and loosen the laundry or observe the program descriptions

12 Detergent and detergent care product

Remarks

- s Comprehensive directions for the Use can be found at www.bosch-home.com or by scanning the QR code on the title page of these instructions for use.
- s Take the information regarding Safety → *Page 4* and Avoid material damage → *Page 11* heed.

Information from the manufacturer about use and dosage can be found on the packaging.

Remarks

- s with liquid detergents only tend to use self-flowing liquid detergents
- s various liquid detergents don't mix
- s detergent and fabric softener not to blend
- s Not stored for too long and strongly in- using thickened products.
- s no solvent-based, corrosive using the disinfectants, e.g. bleach
- s Use dyes in moderation
 - salt can affect stainless steel
- s no decolorizing agent in the appliance ready to use

3 The Operation in es- sentie

Remark: You can find more information in the digital operating instructions by scanning the QR code in the table of contents or on www.bosch-home.com.

13.1 Switch on device

Required: The device is correctly set up and connected.

→ *"Set up and connect"*

Page 13

- ▶ Press . ①

The power-on process takes a few seconds.

Remark: The drum lighting switches off automatically.

13.2 Set program

1. Turn the program selector and set it to the desired programme.
→ *"Programs", Page 26*
2. If necessary, adjust the program settings → *Page 31*.

13.3 Adjust program settings

Required: A program is set.

→ *"Set program", page 31*

- ▶ Adjust the program settings.

→ *"Buttons", Page 24*

Remark: The program settings are not saved permanently for the program.

13.4 Filling the drum with laundry

Remark: To avoid creasing, keep the maximum load of the

→ *"Programs", Page 26* heed.

Required: The laundry is prepared.

→ *"Laundry", Page 30*

1. Open the door.

Make sure the drum is empty.

2. Place the laundry in the drum.
3. Close the door.
Make sure that no small items of laundry are caught in the door.

13.5 Inserting the liquid detergent dosing aid

When you order the dosing aid as an accessory, you must fit the dosing aid.

1. Pull out the detergent drawer.
2. Press the insert down and take out the detergent drawer.

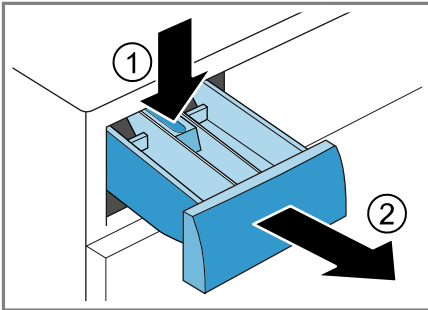

3. Place the dosing aid.

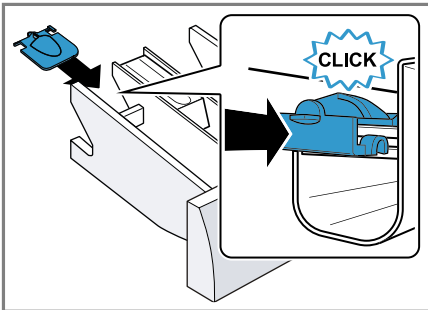

4. Insert the detergent drawer.

13.6 Using the dosing aid for liquid detergent know

You can use a dosing aid in the detergent drawer to dose liquid detergent.

1. Pull out the detergent drawer.
2. Push the dosing aid forward.

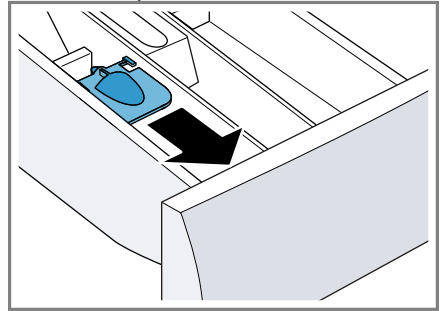

3. Fold the dosing aid downwards and click into place.

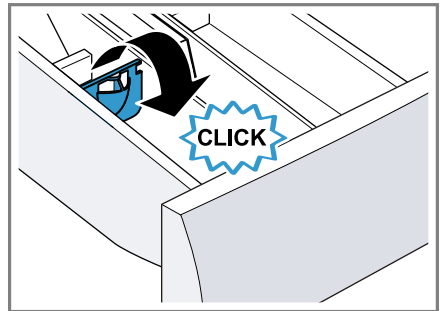

4. Slide in the detergent drawer.

13.7 Dosing detergent and care agent

Remarks

- s Use the dosing aid for liquid
Do not use gel-like detergents, washing powder, switched on prewash or ready-in time.

s Keep the directions for washing agent and laundry care agent
→ *Page 31 at.*

1. Pull out the detergent drawer.
2. Fill with detergent.
→ *"Detergent drawer", Page 20*
3. If desired, fill with a care product.
4. Slide the detergent drawer into the appliance.

13.8 Starting the program

Remark: If you want to change the time until the program end, first set the ready in time.

▶ on Start/Refill  to press.

- a The drum rotates and a load recognition takes place, which can take up to 2 minutes, after which the water flows into the device.
- a The display shows whether the program maduur or the ready in time displayed.
- a After the program end, it shows display: -0-.

13.9 Soaking laundry

Remark: No additional detergent is needed. The soapy water is then used for washing.

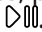
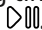
1. Start the program.
2. To pause the program, after about 10 minutes, press Start/ Refill .
3. To resume the program after the desired soaking time, press Start/ Refill .

13.10 Loading laundry

1. Press Start/Refill .
The device pauses.

Remark: When  appears it is not possible to add laundry.

When  goes out, then the refill washing of laundry possible.

2. Open the appliance door.
3. Reload or remove the laundry.
4. Close the appliance door.
5. Press Start/Refill .

13.11 Program Cancel

1. on Start/Refill  to press.
2. Open the appliance door.

At high temperature and high water level, the appliance door remains locked for safety reasons.

- Start the program at a high temperature To rinse.
- Start the program at a high water level Centrifuge or select a suitable program for draining.

→ *"Programs", Page 26*

3. Remove the laundry
→ *Page 33.*

13.12 Resume program at rinse hold

1. The program Centrifuge or select a suitable program for draining.

→ *"Programs", Page 26*

2. Press Start/Refill .

13.13 Take out the laundry

1. Open the appliance door.
2. Remove the laundry.

13.14 Switching off the device

1. Press . 

NL Child lock

2. Wipe the rubber sleeve dry and remove any foreign objects.

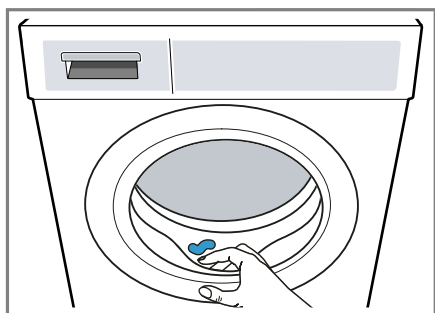

3. Leave the appliance door and detergent drawer open to allow the residual water to dry out.

14 Child lock

BSecure your device against unwanted operation via the controls.

14.1 Activating child lock

- ▶ Both keys Child lock 3 sec. press for approx. 3 seconds.
- a The display shows  to give.
- a The controls are blocked.
- a The childproof lock remains in effect even after the switching of the device is activated.

14.2 Deactivate child lock

Required: To deactivate the child lock, the appliance must be switched on.

- ▶ Press both buttons for about 3 seconds Child lock 3 sec..

In order not to cancel the current program, the program selector must be set to the initial program.

a goes out in the display .

5 Home Connect

This device is network capable. Connect your appliance to a mobile terminal device to be able to operate functions via the Home Connect app, adjust basic settings or monitor the current operating status.

Remark: You can find more information in the digital operating instructions by scanning the QR code in the table of contents or on www.bosch-home.com.

The Home Connect services are not available in every country. The availability of the Home Connect function depends on the availability of the Home Connect services in your country. Information on this can be found at: www.home-connect.com. s → "Device with WLAN home network work (WiFi) with WPS function", Page 35

s → "Device with WLAN home network work (WiFi) without WPS function", page 35

The Home Connect app guides you through the entire registration process. Follow the instructions in the Home Connect app to make the settings.

Tips

- s Take the supplied document of Home Connect.
- s Also take the directions the Home Connect app.



Remarks

- s Follow the safety instructions ties in this manual and make sure that they are also observed when you operate the appliance via the Home Connect app.
→ "Safety", Page 4
- s Operating the device always takes precedence. During this time, operation via the Home Connect app is not possible.

15.1 Connecting device to WLAN home network (WiFi) with WPS function

Requirements

- s Your router has a WPS function.
- s Wi-Fi on the router is activated. s The basic WiFi setting on the device rate is activated.
→ "activate WiFi on the device", Page 36
- s The appliance has cation reception from the home network (Wi-Fi).
- s The Home Connect app is on the mobile terminal installed.

1. On for at least 3 seconds Control via App  to press.
- a The display shows auto reflected to give.
2. Press Start/Refill .
3. Press the WPS button on the router within 2 minutes.
Follow the information in your router's documentation.
- a  flashes in the display.
- a The device is connecting with the home Wi-Fi network.
- a When on the display con is becoming displayed and permanent lights up, the device is connected to the home WiFi network.



4. If the display err shows, the device is not connected to the home Wi-Fi network.
 - s Check if the device is within range of the Wi-Fi network.
 - s Reconnect the device to the Wi-Fi network with WPS function.
5. Connect the appliance to the Home Connect app. → Page 36

15.2 Connecting device to WLAN home network (WiFi) without WPS function

If your router does not have WPS function, you can manually connect the device to your home network (Wi-Fi).

Requirements

- s Wi-Fi on the router is activated. s The basic WiFi setting on the device rate is activated.
→ "activate WiFi on the device", Page 36
- s The appliance has cation reception from the home network (Wi-Fi).
- s The Home Connect app is on the mobile terminal installed.

1. On for at least 3 seconds Control via App  to press.
- a The display shows auto reflected to give.
2. Set the program to position 2.
- a The display shows JUICE reflected to give.
3. Press Start/Refill .
- a  flashes in the display. The device creates its own WiFi home network with the network name (SSID) HomeConnect on.

4. Call up the WiFi settings on the mobile end device.

Connect the mobile end device to the HomeConnect WiFi network and enter the HomeConnect WiFi password (key).

- a Your mobile end device makes connection to the device. The connection procedure can take up to 60 seconds.
5. Open the Home Connect app on the mobile end device and follow the steps in the app.
 6. Enter the network name (SSID) and password (key) of your home network in the Home Connect app.

7. Follow the steps in the Home Connect app to connect the appliance.

- a When on the display con is becoming displayed and permanent lights up, the device is connected to the home WiFi network.
8. If the display err shows, the device is not connected to the home Wi-Fi network.
 - s Check if the device is within range of the Wi-Fi network.
 - s Reconnect the device to the Wi-Fi network with WPS function.

9. Connecting the appliance to the Home Connect app → *Page 36*.

15.3 Connecting the appliance to the Home Connect app

Requirements

- s The device is connected to the WiFi home network.
- s The Home Connect app is open and you have signed up.

1. Set the program to level 3.

- a The display shows APP reflected to give.

2. Press Start/Refill .

- a The device is connecting with the Home Connect app.

3. As soon as the appliance is in the Home Connect app is displayed, follow the last steps in the Home Connect app.

- a When the display con again- the appliance is connected to the Home Connect app.

15.4 Activate WiFi on the device

Remark: The energy consumption increases compared to the values indicated in the consumption value tables when Wi-Fi is activated.

1. Approx. 3s onControl via App  Busy-know.

2. Set program to position 4.

- a The display shows Con reflected to give.

3. Press Start/Refill  until the display on displays.

- a WiFi is activated.

Remark: The device does not turn off automatically when WiFi is activated.

15.5 Deactivate WiFi on the device

1. On for at least 3 seconds Control via App  to press.



2. Set program to position 4.

- a The display shows Con reflected to give.

3. Press Start/Refill the display until OFF displays.
- a WiFi is deactivated.

Remark: The connection is automatically re-established when WiFi is re-enabled.

15.6 Resetting the device's network settings



1. On for at least 3 seconds Control via App  to press.
2. Set program to position 5.
- a The display shows rES reflected to give.
3. on Start/Refill  to press.
- a The display shows YES reflected to give.
4. on Start/Refill  to press.
- a The network settings are set back.
- a If the display end shows, are the network settings reset.

15.7 Remote start

Release the appliance for remote start via the Home Connect app.

Activate remote start

Remarks

- s The remote start is due to deactivated for security reasons under the following conditions:
 - Open the appliance door.
 - Press Start/Refill .
 - Press Control via App .
 - Turn off the device.
 - After a power outage.
- s The remote start is possible due to for safety reasons are not activated when the appliance door is open.

Requirements

- s The device is connected to your home WiFi network connected.
- s The appliance is connected to the Home Connect app connected.
- s A program has been selected.

- ▶ Press Control via App. 
 - Pressing the button for at least 3 seconds opens the Home Connect menu.
 - When you press the button, the appliance is enabled for remote start via the Home Connect app.

When you open the appliance door, the function is automatically deactivated.

- a Control via App  burns.

Remark: To deactivate the function on Control via App  to press.

15.8 Remote diagnosis

Customer service can access your appliance via remote diagnosis if you contact customer service with the appropriate request, if your appliance is connected to the Home Connect server and if the remote diagnosis is available in the country in which you use the appliance .

Tip: More information as well as directions on the availability of remote diagnostics in your country can be found in the service/support section of the local website: www.home-connect.com

15.9 Protection of personal data

Please observe the information regarding the protection of personal data.

When your device connects to a home network that is on the Internet for the first time

connected, it transmits the following categories of data to the Home Connect server (initial registration):

- s Unambiguous identification of the device ready (consisting of device keys and the MAC address of the built-in Wi-Fi communication module).
- s Wi-Fi . Security Certificate communication module (for information security of the connection).
- s The current software and hardware version of your home appliance.
- s Status of any previous reset to factory settings.

During the first registration, the use of the Home Connect functionalities is prepared. This registration should only be carried out when you want to use the Home Connect functionalities for the first time.

Remark: Please note that the Home Connect functionalities can only be used in combination with the Home Connect app. Information on data protection can be called up in the Home Connect app.

16 Basic settings

You can set your device according to your needs.

Remark: You can find more information in the digital operating instructions by scanning the QR code in the table of contents or on www.bosch-home.com.

17 Cleaning and maintenance loves

clean and maintain your device carefully to make sure it works well for a long time.

Remark: You can find more information in the digital operating instructions by scanning the QR code in the table of contents or on www.bosch-home.com.

17.1 Cleaning the drum

CAREFULLY

Risk of injury!
Permanent washing at low temperatures and lack of ventilation of the appliance can damage the drum and cause injuries.

- ▶ Run a drum cleaning program regularly or wash at a temperature of at least 60°C.
- ▶ Leave the appliance to dry with the door and detergent drawer open after each use.
- ▶ The program Cleaning the drum without laundry with powder detergent.

17.2 Cleaning the detergent drawer

1. Pull out the detergent drawer.

2. Press the insert down and remove the detergent drawer.

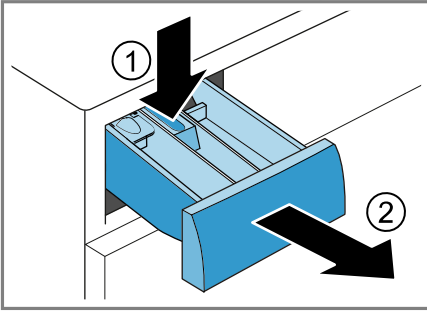

3. Pull out the insert from bottom to top.

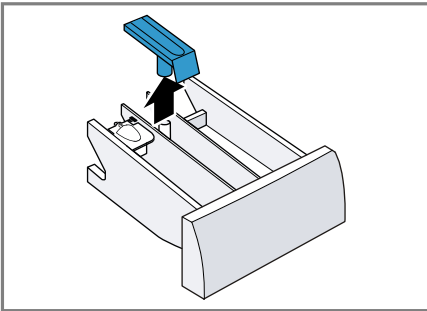

4. Clean and dry the detergent drawer and insert with water and a brush.

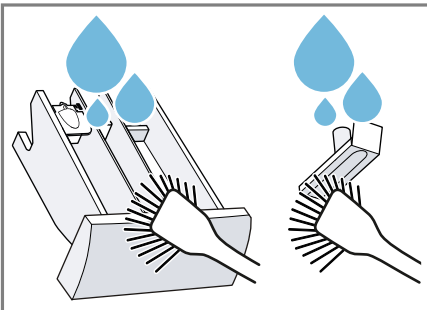

5. Place the insert and click into place.

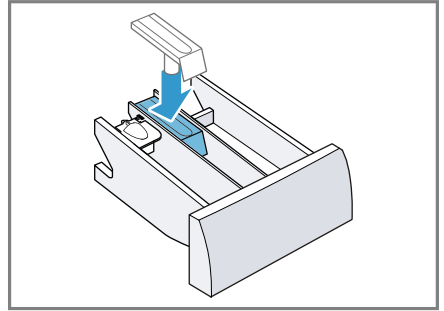

6. Clean the opening for the detergent drawer.

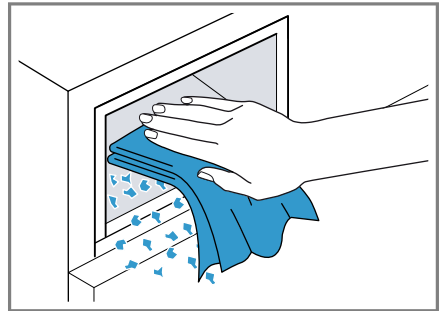

7. Slide the detergent drawer into the appliance.

17.3 Cleaning the drain pump

Clean the drain pump in the event of malfunctions, e.g. blockages or chatter.

Emptying the drain pump

1. Close the tap.
2. Turn off the device.
3. Disconnect the plug of the device from the mains.

4. Open and remove the service door.

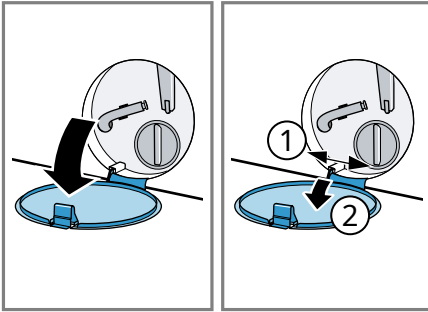

5. Place a sufficiently large container under the opening.

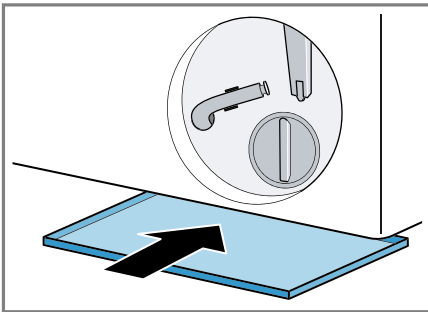

6. Remove the drain hose from the holder.

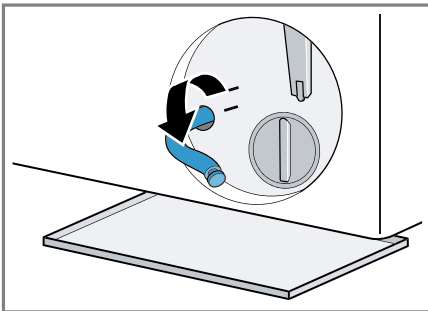

7.  CAUTION - Risk of burns! The soap gets hot when washing at high temperatures.

► Do not touch the hot soapy water.

Pull off the sealing cap to allow the wash water to flow into the collection container.

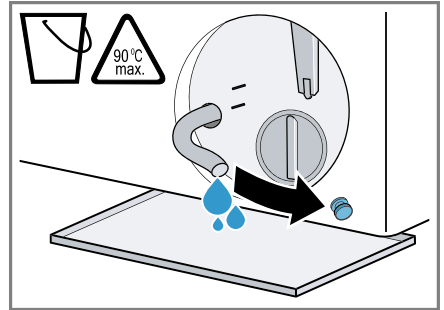

8. Press the stopper back on.

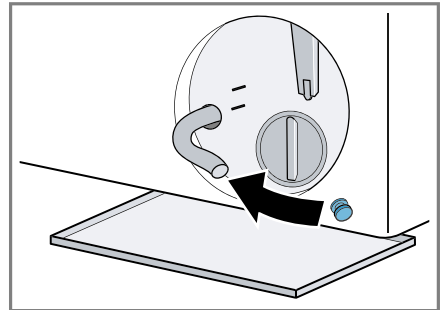

9. Clamp the drain hose in the holder.

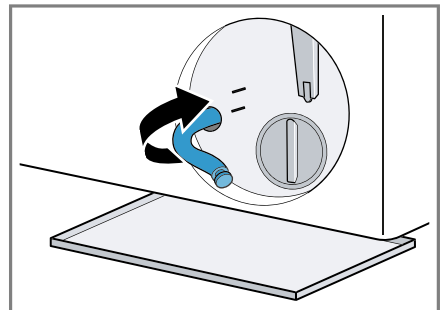

Cleaning the drain pump

Required: The drain pump is empty.
→ Page 39

1. As there may still be residual water in the pump, carefully unscrew the lid.
 - s Large impurities can cause the filter element to get stuck in the pump housing. Loosen impurities and remove filter element.

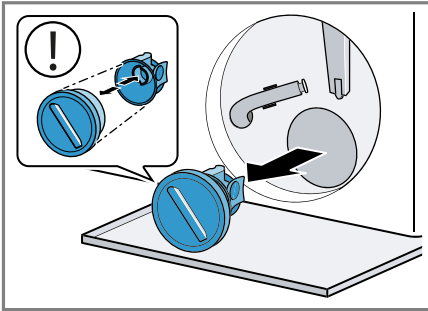

2. Clean the interior, screw thread of the pump cover and pump housing.

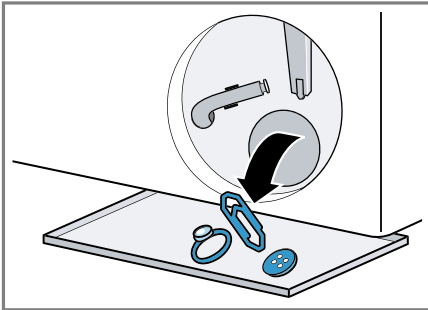

The pump cover consists of two components that can be disassembled for cleaning.

3. Make sure that both wing wheels can be turned.

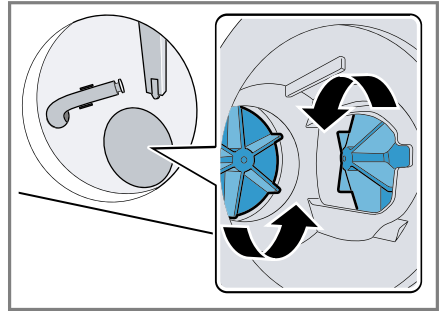

4. Install the pump cover.
 - s Check that the pump cover components are correctly assembled.

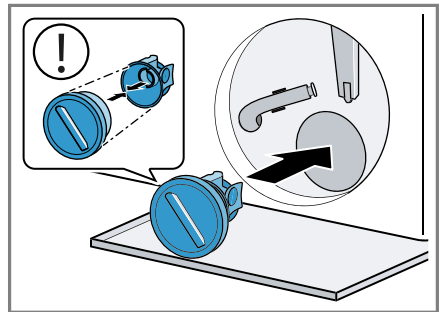

5. Tighten the pump cover as far as it will go.

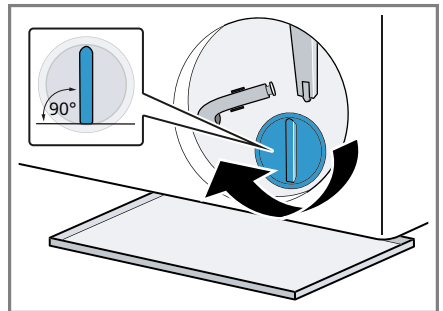

The pump cover handle must be vertical.

6. Install and close the service door.

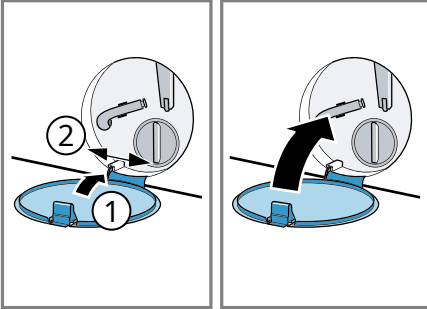

17.4 Cleaning the inlet opening in the rubber sleeve

Regularly check the inlet opening in the rubber sleeve for blockages and clean the inlet opening.

1. Open the appliance door.
2. Clear the blockages from the inlet opening.

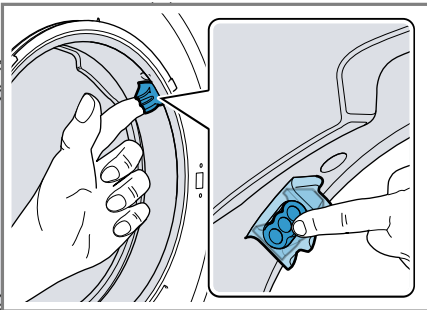

Remark: Do not use pointed or sharp objects.

18 Troubleshooting

You can remedy minor faults on the device yourself. Before using contact customer service for information on troubleshooting. This way you avoid unnecessary costs.





WARNING





Risk of electric shock! Improper repairs are dangerous.

- ▶ Only trained specialist personnel may carry out repairs on the device.
- ▶ Only original spare parts may be used for repair of the device.
- ▶ If the power cord of this appliance is damaged, it must be replaced by the manufacturer, its service agent or a similarly qualified person in order to avoid a hazard.

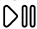

Malfunction	Cause and Troubleshooting
The display is off and Start/Refill flashes. 	The energy saving mode is active. ▶ Press any button. a The display lights up again.
"E:30 / -80"	Drain pipe or water drain hose is clogged. ▶ Clean the drain pipe and the water drain hose.
	Drain pipe or water drain hose is kinked or pinched. ▶ Make sure that the drain pipe and the water drain hose are not kinked or pinched.
	Drain pump is clogged. ▶ → "Cleaning the drain pump", page 39
	Water drain hose is connected too high. ▶ Install the water drain hose at a maximum height of 1 meter.
	Pump cover not assembled correctly. ▶ Assemble the pump cover correctly.
	Detergent dosage is too high. ▶ Immediate measure: mix a tablespoon of fabric softener with 0.5 l of water and pour this mixture into the left compartment (not for outdoor, sportswear and down textiles). ▶ Reduce the amount of detergent for the next wash with an equal load.
	Unauthorized extension mounted on the water drain hose.

Malfunction	Cause and Troubleshooting
"E:30 / -80"	<ul style="list-style-type: none"> ▶ Remove any unauthorized extensions from the water drain hose. Connect device <hr/> <p>Pump cover is not fully screwed in.</p> <ul style="list-style-type: none"> ▶ Make sure that the pump cover is screwed into the device as far as it will go. The pump cover handle must be vertical.
"E:36 / -25 / -26"	<p>Drain pump is clogged.</p> <ul style="list-style-type: none"> ▶ → <i>"Cleaning the drain pump", page 39</i>
"E:38 / -25 / -26"	<p>Drain pump is clogged.</p> <ul style="list-style-type: none"> ▶ → <i>"Cleaning the drum", page 38</i> if the error is displayed again, ▶ → <i>"Cleaning the drain pump", page 39</i> <hr/> <p>Inlet opening of the rubber sleeve is clogged.</p> <ul style="list-style-type: none"> ▶ → <i>"Clean the inlet opening in the rubber sleeve", Page 42</i>
	<p>Water pressure is low. No solution possible.</p> <hr/> <p>Strainer in the water supply is clogged.</p> <ul style="list-style-type: none"> ▶ Clean the strainer in the water supply. <hr/> <p>Water tap is closed.</p> <ul style="list-style-type: none"> ▶ Open the water tap. <hr/> <p>Water supply hose is kinked or pinched.</p> <ul style="list-style-type: none"> ▶ Make sure that the water supply hose is not kinked or pinched.
"E:35 / -10"	<p>Water in the bottom tray.</p> <ul style="list-style-type: none"> ▶ Close the tap. ▶ Please contact customer service. → <i>"Customer Service", page 53</i> <hr/> <p>Device is leaking.</p> <ul style="list-style-type: none"> ▶ Close the tap. ▶ Please contact customer service. → <i>"Customer Service", page 53</i>
	<p>Detergent dosage is too high.</p> <ul style="list-style-type: none"> ▶ Immediate measure: mix a tablespoon of fabric softener with 0.5 l of water and pour this mixture into the left compartment (not for outdoor, sportswear and down textiles). ▶ Reduce the amount of detergent for the next wash with an equal load.

Malfunction	Cause and Troubleshooting
🕒 burns.	<p>Temperature is too high.</p> <ul style="list-style-type: none"> ▶ Wait for the temperature to drop. ▶ → <i>"program cancel", Page 33</i>
	<p>Water level is too high.</p> <ul style="list-style-type: none"> ▶ Select a suitable program for draining. → <i>"Programs", Page 26</i>
	<p>Laundry is wedged in the door.</p> <ol style="list-style-type: none"> 1. Open the door again. 2. Remove trapped laundry. 3. Close the door. 4. To start the program, press Start/Refill ▷🌀.
🌀 flashes.	<p>Door is not closed.</p> <ol style="list-style-type: none"> 1. Close the door. 2. To start the program, press Start/Refill ▷🌀.
All other error codes.	<p><small>Malfunction</small></p> <ul style="list-style-type: none"> ▶ Please contact customer service. → <i>"Customer Service", page 53</i>
"E:30/-20"	<p>Solenoid valve defective.</p> <ul style="list-style-type: none"> ▶ Please contact customer service. → <i>"Customer Service", page 53</i>
	<p>Detergent dosage is too high.</p> <ul style="list-style-type: none"> ▶ Reduce the amount of detergent for the next wash with an equal load.
	<p>Additional water filled.</p> <ul style="list-style-type: none"> ▶ Do not fill the device with additional water during operation.
Device not working.	<p>Mains plug of the power cable is not plugged in.</p> <ul style="list-style-type: none"> ▶ Connect the appliance to the mains.
	<p>The fuse in the fuse box has tripped.</p> <ul style="list-style-type: none"> ▶ Check the fuse in the meter box.
	<p>Power supply has failed.</p> <ul style="list-style-type: none"> ▶ Check whether the interior lighting or other appliances are working.
Program does not start.	<p>Start/Refill ▷🌀 was not pressed.</p> <ul style="list-style-type: none"> ▶ Press Start/Refill ▷🌀.
	<p>Door is not closed.</p>

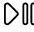
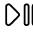
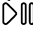
Malfunction	Cause and Troubleshooting
Program does not start.	<ol style="list-style-type: none"> 1. Close the door. 2. To start the program, press Start/Refill .
	<p>Child lock is activated.</p> <p>▶ → <i>"Deactivate child lock", page 34</i></p>
	<p>- Ready in + is activated.</p> <p>▶ Check if - Ready in + is activated. → <i>"Buttons", Page 24</i></p>
	<p>Laundry is wedged in the door.</p> <ol style="list-style-type: none"> 1. Open the door again. 2. Remove trapped laundry. 3. Close the door. 4. To start the program, press Start/Refill .
Door cannot be opened.	<p> is activated.</p> <p>▶ Resume the program by Centrifuge or Drain to choose and press Start/Refill  too busy-know. → <i>"Resume program at rinse hold", page 33</i></p>
	<p>Temperature is too high.</p> <p>▶ Wait for the temperature to drop.</p> <p>▶ → <i>"program cancel", Page 33</i></p>
	<p>Water level is too high.</p> <p>▶ Select a suitable program for draining. → <i>"Programs", Page 26</i></p>
	<p>Power cut.</p> <p>▶ Open the door with the emergency release. → <i>"Emergency release", page 52</i></p>
Washing water is not pumped out.	<p>Drain pipe or water drain hose is clogged.</p> <p>▶ Clean the drain pipe and the water drain hose.</p>
	<p>Drain pipe or water drain hose is kinked or pinched.</p> <p>▶ Make sure that the drain pipe and the water drain hose are not kinked or pinched.</p>
	<p>Drain pump is clogged.</p> <p>▶ → <i>"Cleaning the drain pump", page 39</i></p>
	<p> is activated.</p>

Malfunction	Cause and Troubleshooting
Washing water is not pumped out.	<p>▶ Resume the program by Centrifuge or Drain to choose and press Start/Refill  too busy-know. → <i>"Resume program at rinse hold", page 33</i></p>
	<p>Water drain hose is connected too high. ▶ Install the water drain hose at a maximum height of 1 meter.</p>
	<p>Pump cover not assembled correctly. ▶ Assemble the pump cover correctly.</p>
	<p>Detergent dosage is too high. ▶ Immediate measure: mix a tablespoon of fabric softener with 0.5 l of water and pour this mixture into the left compartment (not for outdoor, sportswear and down textiles). ▶ Reduce the amount of detergent for the next wash with an equal load.</p>
	<p>Unauthorized extension mounted on the water drain hose. ▶ Remove any unauthorized extensions from the water drain hose. Connect device</p>
No water flows into the device. The detergent was not washed in.	<p>Start/Refill  was not pressed. ▶ Press Start/Refill .</p> <p>Strainer in the water supply is clogged. ▶ Clean the strainer in the water supply.</p> <p>Water tap is closed. ▶ Open the water tap.</p> <p>Water supply hose is kinked or pinched. ▶ Make sure that the water supply hose is not kinked or pinched.</p>
Start several times with centrifugation.	<p>The imbalance control system eliminates the imbalance by distributing the laundry several times. ▶ No error - no action required.</p> <p>Remark: When loading, place large and small items of laundry together in the drum. Different sized laundry is more evenly distributed during the spin cycle.</p>
The program duration changes during the wash cycle.	<p>The program sequence is electronically optimized. This may lead to changes in the program duration. ▶ No error - no action required.</p>

Malfunction	Cause and Troubleshooting
The program duration changes during the wash cycle.	<p>The imbalance control system eliminates the imbalance by distributing the laundry several times.</p> <ul style="list-style-type: none"> ▶ No error - no action required. <p>Remark: When loading, place large and small items of laundry together in the drum. Different sized laundry is more evenly distributed during the spin cycle.</p>
	<p>The foam control system provides an extra rinse if the foam is too high.</p> <ul style="list-style-type: none"> ▶ No error - no action required.
The water is not visible in the drum bar.	<p>The water is below visible range.</p> <ul style="list-style-type: none"> ▶ No error - no action required. ▶ Do not fill the device with additional water during operation.
Drum jerks after program start.	<p>The cause is an internal motor test.</p> <ul style="list-style-type: none"> ▶ No error - no action required.
In the compartment there is residual water. 	<p>Insert in compartment hidden. </p> <ul style="list-style-type: none"> ▶ → "<i>Cleaning the detergent drawer</i>", Page 38
Vibration and movement of the appliance during the spin run.	<p>The appliance is not leveled properly.</p> <ul style="list-style-type: none"> ▶ Adjusting the device <p>Device feet are not fixed.</p> <ul style="list-style-type: none"> ▶ Secure the device feet. Adjusting the device
	<p>Transport protections have not been removed.</p> <ul style="list-style-type: none"> ▶ Remove transport locks
Drum is spinning, er no water flows into the appliance.	<p>Load recognition is active.</p> <ul style="list-style-type: none"> ▶ No error, no action necessary. <p>Remark: The load detection can take up to 2 minutes.</p>
strong foam ming.	<p>Detergent dosage is too high.</p> <ul style="list-style-type: none"> ▶ Immediate measure: mix a tablespoon of fabric softener with 0.5 l of water and pour this mixture into the left compartment (not for outdoor, sportswear and down textiles). ▶ Reduce the amount of detergent for the next wash with an equal load.
High spin speed rental is not reached.	<p>Low spin speed is set.</p> <ul style="list-style-type: none"> ▶ Set a higher spin speed for the next wash.

Malfunction	Cause and Troubleshooting
High spin speed rental is not reached.	<p>Unbalance control system compensates for imbalance through reduced spin speed.</p> <ul style="list-style-type: none"> ▶ Redistribute the laundry in the drum. <p>Remark: If possible, place large and small items of laundry together in the drum. Different sized laundry is more evenly distributed during the spin cycle.</p> <ul style="list-style-type: none"> ▶ Start the program Centrifuge.
Program centrifugal run does not start.	<p>Drain pipe or water drain hose is clogged.</p> <ul style="list-style-type: none"> ▶ Clean the drain pipe and the water drain hose. <hr/> <p>Drain pipe or water drain hose is kinked or pinched.</p> <ul style="list-style-type: none"> ▶ Make sure that the drain pipe and the water drain hose are not kinked or pinched. <hr/> <p>The unbalance detection system has interrupted the spin cycle due to uneven distribution of the laundry.</p> <ul style="list-style-type: none"> ▶ Redistribute the laundry in the drum. <p>Remark: If possible, place large and small items of laundry together in the drum. Different sized laundry is more evenly distributed during the spin cycle.</p> <ul style="list-style-type: none"> ▶ Start the program Centrifuge.
fizzing, hissing loud.	<p>Water is flushed into the detergent drawer under pressure.</p> <ul style="list-style-type: none"> ▶ No error - normal operating noise.
Loud noise during spinning.	<p>The appliance is not leveled properly.</p> <ul style="list-style-type: none"> ▶ Adjusting the device <hr/> <p>Device feet are not fixed.</p> <ul style="list-style-type: none"> ▶ Secure the device feet. Adjusting the device <hr/> <p>Transport protections have not been removed.</p> <ul style="list-style-type: none"> ▶ Remove transport locks
Clapping, clattering in the pump.	<p>A foreign object has entered the pump.</p> <ul style="list-style-type: none"> ▶ → "<i>Cleaning the drain pump</i>", page 39
Slurping, rhythmic suction sound.	<p>Pump is active, the solution is being pumped out.</p> <ul style="list-style-type: none"> ▶ No error - normal operating noise.

Malfunction	Cause and Troubleshooting
wrinkling.	<p>Spin speed is too high.</p> <ul style="list-style-type: none"> ▶ Set a lower spin speed for the next wash. <hr/> <p>The load quantity is too high.</p> <ul style="list-style-type: none"> ▶ Reduce the load during the next wash. <hr/> <p>Inappropriate program set for the type of fabric.</p> <ul style="list-style-type: none"> ▶ Select a suitable program for the type of fabric.
Detergent or laundry detergent softer drips from the cuff and collects on the door or in the cuff fold.	<p>Too much detergent/fabric softener in the detergent drawer.</p> <ul style="list-style-type: none"> ▶ When dosing the liquid detergent and fabric softener, pay attention to the marking in the detergent drawer and do not dose above that.
Spin result is not to satisfaction-ness. The laundry is too wet / too damp.	<p>Low spin speed is set.</p> <ul style="list-style-type: none"> ▶ Set a higher spin speed for the next wash. <hr/> <p>▶ Start the program Centrifuge.</p> <hr/> <p>Drain pipe or water drain hose is clogged.</p> <ul style="list-style-type: none"> ▶ Clean the drain pipe and the water drain hose. <hr/> <p>Drain pipe or water drain hose is kinked or pinched.</p> <ul style="list-style-type: none"> ▶ Make sure that the drain pipe and the water drain hose are not kinked or pinched. <hr/> <p>The unbalance detection system has interrupted the spin cycle due to uneven distribution of the laundry.</p> <ul style="list-style-type: none"> ▶ Redistribute the laundry in the drum. <p>Remark: If possible, place large and small items of laundry together in the drum. Different sized laundry is more evenly distributed during the spin cycle.</p>
	<hr/> <p>Unbalance control system compensates for imbalance through reduced spin speed.</p> <ul style="list-style-type: none"> ▶ Redistribute the laundry in the drum. <p>Remark: If possible, place large and small items of laundry together in the drum. Different sized laundry is more evenly distributed during the spin cycle.</p> <ul style="list-style-type: none"> ▶ Start the program Centrifuge.

Malfunction	Cause and Troubleshooting
Detergent residue on the damp laundry.	Detergents may contain water-insoluble substances, which deposit on the laundry. ▶ Start the program To rinse.
Detergent residue on the dry laundry.	Detergents may contain water-insoluble substances, which deposit on the laundry. ▶ Brush the laundry after washing and drying.
Home Connect func-dishonor not correctly.	Various causes are possible. ▶ Go to www.home-connect.com .
No connection to the home network.	<p>Wi-Fi is turned off. ▶ → <i>"Activate WiFi on the device", page 36</i></p> <hr/> <p>Wi-Fi is activated, but the connection to the home network cannot be established.</p> <ol style="list-style-type: none"> 1. Verify that the home network is available. 2. Reconnect the device to the home network. <p>→ <i>"Device with WLAN home network (WiFi) with Connect WPS function", page 35</i> → <i>"Device with WLAN home network (WiFi) without Connect WPS function", page 35</i></p>
At the water supply feed hose is leaking water.	<p>The water inlet hose is not correctly / firmly connected.</p> <ol style="list-style-type: none"> 1. Connect the water supply hose correctly. Connect water supply hose 2. Tighten the coupling properly.
Water is leaking from the water drain hose.	<p>Water drain hose is damaged. ▶ Replace the damaged water drain hose.</p> <hr/> <p>Water drain hose is not connected correctly. ▶ Connect the water drain hose correctly. Water drainage connection types</p>
Odor has formed in the appliance <small>Pine tree.</small>	<p>Humidity and detergent residue can encourage bacterial growth. ▶ → <i>"Cleaning the drum", page 38</i> ▶ When you are not using the appliance, leave the door and detergent drawer open to allow the residual water to dry out.</p>

18.1 Emergency release

unlock door

Required: The drain pump is empty.
→ *Page 39*

1. ATTENTION! Running water can lead to material damage.

- ▶ Do not open the door if water can be seen behind the glass.

Pull down and release the emergency release with the aid of a tool.

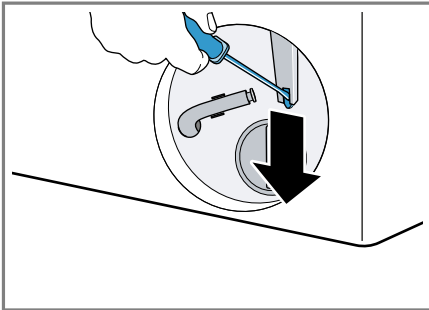

- a The door lock is unlocked.
2. Place the service door and click it into place.
3. Close the service door.

9 Transport, on-hit and drain

Here you will learn how to prepare the device for transport and storage. We also explain how to dispose of old appliances.

19.1 Dismantling the device

Remark: Detailed instructions for use can be found at www.bosch-home.com or by scanning the QR code on the title page of these operating instructions.

1. Close the tap.
2. Empty the water inlet hose.
3. Turn off the device.
4. Unplug the appliance from the mains.
5. Let the suds drain.
→ *"clean drain pump", Page 39*
6. Disassemble the hoses.

19.2 Installing transport locks

Secure the device before transport with the transport locks to avoid damage.

1. Remove the 4 cover caps using a screwdriver.

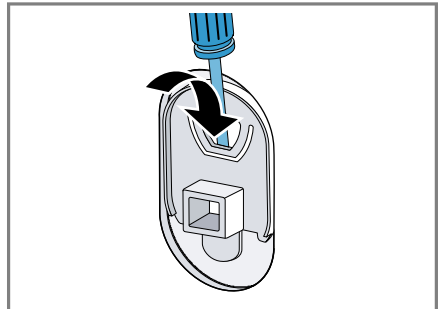

- Keep the cover caps.
2. Install the 4 transport locks. When doing so, observe the description Removing transport locks and proceed in reverse order.

19.3 Restarting the device

- ▶ For more information, see
→ *"Set up and connect" Page 13* and
→ *"For the first use", Page 21*.

19.4 Disposal of your old device

Environmentally friendly disposal allows valuable raw materials to be reused.

 **WARNING**
Risk of health hazard!

Children can lock themselves in the appliance and endanger their lives.

- ▶ Do not install the appliance behind a door that blocks or prevents the opening of the appliance door.
- ▶ In the case of discarded appliances, remove the plug of the mains cable from the socket, then cut the mains cable and damage the lock of the appliance door so that the appliance door no longer closes.

1. Unplug the power cord from the outlet.
2. Cut the power cord.

3. Dispose of the device in an environmentally friendly way.

You can obtain information about the current disposal methods from your dealer and your municipal or district council office.



This appliance is marked in accordance with the European Directive 2012/19/EU on waste electrical and electronic

chemical equipment (waste electrical and electronic equipment - WEEE). The directive sets the framework for the take-back valid in the EU and disposal of old appliances.

20 Customer Service

if you have any questions about the use, If you cannot remedy a malfunction of the device yourself or if the device needs to be repaired, please contact our service department. Original replacement parts that are relevant for the function in accordance with the respective Ecodesign Regulation can be obtained from our service department for a period of at least 10 years from the time of placing the device on the market within the European Economic Area.

Remark: Engaging the service within the framework of the manufacturer's warranty conditions is free of charge.

Detailed information about the warranty period and warranty conditions in your country can be obtained from our after-sales service, your dealer or on our website.

When contacting customer service, you will need the product number (E-Nr.) and the production number (FD) of the device.

The contact details of the after-sales service can be found in the supplied service list or on our website.

20.1 Product number (E no.) and production number (FD)

The product number (E-Nr.) and the production number (FD) can be found on the type plate of the device.

The type plate is located depending on the model:
s on the inside of the door.
s on the inside of the bottom

holding valve.
s on the back of the device

honeycomb.

In order to quickly find your device data and the customer service telephone numbers, you can make a note of the data.

20.2 AQUA-STOP guarantee

In addition to the warranty claims against the seller based on the purchase agreement and our manufacturer's warranty, you will be compensated if the following conditions are met.

s If due to an error in the AquaStop
If water damage is caused to the system, we will reimburse the damage suffered by private users. To guarantee the water security system, the appliance must be connected to the mains.

s The liability guarantee applies to the life of the device.

s Condition for entitlement to there is a guarantee that the device with AquaStop has been set up and connected professionally and in accordance with our installation instructions; this also includes the professionally installed extension of the AquaStop (original accessory). Our warranty does not cover

Check for defective supply lines or fittings up to the AquaStop connection on the tap.
s While using an appliance
In principle, with AquaStop you do not have to keep up with it or. turn off the tap after use for safety reasons. The tap should only be turned off when you are away for a longer period of time, for example if you are going on holiday for a few weeks.

21 Consumption values

The following information is provided in accordance with the EU Ecodesign Regulation. The specified values for other programs as Eco 40-60 are only guide values and have been determined in accordance with the applicable standard EN60456.

Program	belathing (kg)	Program-maduur (h:min) ¹	energy-gibberish use (kWh/cycle) ¹	Water-far-usage (l/cycle) ¹	maxi-male tempeh rature (°C) 5 min ¹	centri-fugue revving number (r/min) ¹	Rest-moisture-half-at (%) ¹
Eco 40-60 ²	10.0	3:59	1,145	68.0	45	1600	44.00
Eco 40-60 ²	5.0	3:00	0.490	47.0	30	1600	44.00
Eco 40-60 ²	2.5	3:00	0.279	32.0	25	1600	44.00
Cotton 20 °C	10.0	3:23	0.530	94.0	24	1600	43.00
Cotton 40 °C	10.0	3:19	1.420	97.0	45	1600	43.00
Cotton 60 °C	10.0	3:18	2.060	92.0	61	1600	45.00
Cotton 40 °C + Prewash	10.0	3:59	1,450	102.0	43	1600	43.00
wrinkle recovery bottom 40 °C	4.0	2:30	0.760	56.0	49	1200	30.00
Fast/Mix 40 °C	4.0	1:05	0.640	42.0	44	1400	50.00
Wool 30 °C	2.0	0:37	0.171	41.0	23	800	23.00

¹ Actual values may vary due to the influence of water pressure, hardness and inlet temperature, ambient temperature, type, amount and soiling of the laundry, detergent used, fluctuations in the power supply and selected additional functions deviate from the stated values.

² Test program in accordance with the EU Ecodesign Regulation and the EU energy call regulation with cold water (15°C).

2 Technical data

Device height	84.8cm
Device width	59.8cm
Device depth	63.2 cm

¹ Depending on the device output ring

Weight	72.3kg ¹
Maximum load thing	10.0 kg
mains voltage	220-240V, 50-60 Hz

¹ Depending on the device output ring

⇐ Minimum input installation fuse	10 A
Rated power gene	2300W
Recorded Ver-be allowed to	<ul style="list-style-type: none"> s Off state: 0.10W s non-disabled caved in position: 0.50 W s Time to the net work-related standby becomes set (Wi-Fi Fi): 5 min s network unions standing by (WiFi): 1.20W
water pressure	<ul style="list-style-type: none"> s At least: 100 kPa (1 bar) s Maximum: 1000 kPa (10 bar)
Length of the water supply feeding hose	150 cm
Length of the water drain hose	150 cm
Length of the mains connection cable	160 cm
¹ Depending on the device output ring	

This product contains light sources of energy class F. The light sources are available as spare parts and may only be replaced by a trained technician.

You can find more information about your model on the Internet at <https://eprel.ec.europa.eu/1>. This web address refers to the official EU product

database EPREL. Then follow the instructions when searching for the model. The model identification consists of the slash character of the E number (E-No.) on the type plate. Alternatively, you can also find the model identifier in the first line of the EU energy label.

23 Declaration of Conformity ring

In addition, Robert Bosch Hausgeräte GmbH, that the appliance with Home Connect functionality complies with the basic requirements and other applicable provisions of Directive 2014/53/EU.

A detailed RED Declaration of Conformity can be found on the Internet at www.bosch-home.com on the product page of your appliance in the additional documents.



2.4 GHz band (2400–2483.5 MHz):
max. 100 mW
5 GHz band (5150–5350 MHz +
5470–5725 MHz): max. 100 mW

¹ Only applies to countries in the European Economic Area



BE	BG	CZ	DK	THE	EE	IE	el	ES
FR	HR	IT	CY	LI	LV	LT	LU	HU
MT	NL	AT	PL	PT	RO	SI	SK	FI
SE	NO	CH	TR	IS	UK (NI)			

5 GHz WLAN (WiFi): for indoor use only.

ALREADY

GA	MD	ME	MK	RS	UK	UAA
----	----	----	----	----	----	-----

5 GHz WLAN (WiFi): for indoor use only.



BOSCH
HOME APPLIANCES
SERVICE

www.bosch-home.com/service

Contact data of all countries are listed in the attached service directory.

Robert Bosch Hausgeräte GmbH

Carl-Wery-Straße 34

81739 Munich

GERMANY

www.bosch-home.com

* 9001650795*

9001650795 (010830)

NL

Free Manuals Download Website

<http://myh66.com>

<http://usermanuals.us>

<http://www.somanuals.com>

<http://www.4manuals.cc>

<http://www.manual-lib.com>

<http://www.404manual.com>

<http://www.luxmanual.com>

<http://aubethermostatmanual.com>

Golf course search by state

<http://golfingnear.com>

Email search by domain

<http://emailbydomain.com>

Auto manuals search

<http://auto.somanuals.com>

TV manuals search

<http://tv.somanuals.com>